

PIPER PA-25 PAWNEE

Manuals



PA-25 Series Parts Manual 25PM
 PA Series Svc. Bulletin & LetterPBLPA

PC 149

Control Surfaces

PA-25 Pawnee Control Surfaces (All surfaces are uncovered)

Aileron, Left HandU42585-000
 Aileron, Right HandU42585-001
 Elevator, 150 hp. only, LH or RH...U12649-000
 Stabilizer, 150 hp. only, LH or RH.U12647-000
 Flap, Left Hand61129-000
 Flap, Right Hand61129-001
 Spar—FlapU61277-000

Engine

Pawnee 150 hp. Exhaust System

Rear Exhaust StackU12043-022
 Front Exhaust StackU12043-023
 Tail Pipe, SN 656 and up61764-003
 Muffler, SN 722 and upU10308-003

Pawnee 150 hp. Nose Cowl FAA/PMA Approved



Nose CowlU13778-000

Engine Mounts FAA/PMA Approved

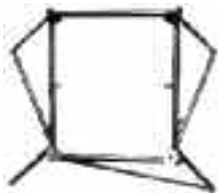

150 hp.U11786-013
 235-260 hp.L64030-000

Engine (continued)

PA-25 Pawnee Spinner Assemblies



FAA/PMA Approved

150 hp. Spinner
 Assembly

Spinner DomeU14422-000
 Front PlateU14426-000
 Back PlateU14424-000
 Complete AssemblyU14422-A

PA-25 235 hp. Spinner Components



Assembly for Fixed Pitch Propellers Serial Numbers 2986-3691

Dome OnlyU14422-000
 Back PlateU14424-005
 Front PlateU14426-004
 Complete AssemblyU14422-B

Spinner Components for 235 hp. with FA8452 McCauley Propeller

Dome only.....U64336-000
 Back Plate*U64310-000
 Front Plate*U64309-000

*We recommend that both front and back plates be replaced at the same time. Our plates have a slight rotation of prop bolt holes to eliminate dome-propeller contact thus decreasing plate and dome stress.

Wings

Wooden Wing Tip Bow FAA/PMA Approved



Wing Tip BowU453-126

Wings (continued)

FAA/PMA Approved Leading Edges

<i>Description</i>	<i>Part No.</i>
Inboard, #1, Left Hand.....	U60015-000
Inboard, #1, Right Hand	U60015-001
Inboard, #2, Left Hand.....	U61297-000
Inboard, #2, Right Hand	U61297-001
Center, #3, Left Hand	U61296-000
Center, #3, Right Hand	U61296-001
Outboard, #4, SN 1-7405572, LH and RH	U13072-006
Outboard, #4, SN 7405573 and up, 235-260 hp., LH and RH.....	U13072-007
Outboard, #5, SN 7405573 and up, 235-260 hp., Left Hand	U60329-000
Outboard, #5, SN 7405573 and up, 235-260 hp., Right Hand	U60329-001
Tip Cover, Left Hand	U15723-000
Tip Cover, Right Hand.....	U15723-001

Spars

FAA/PMA Approved For 150 hp. Pawnee

Left Front Spar.....U61156-002
 Right Front Spar.....U61156-003
 Left Rear Spar.....U61157-002
 Right Rear Spar.....U61157-003

For 235-260 hp. Pawnee

Left Front Spar.....U64055-006
 Right Front Spar.....U64055-007
 Left Rear Spar.....U64056-002
 Right Rear Spar.....U64056-003

Wing Navigation Light Bracket

For use with
 Grimes Model
 "E" Type Light
 or equivalent

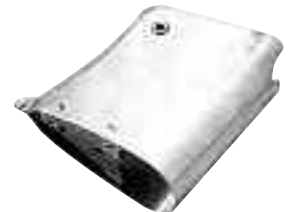

Light BracketU12560-000

End Repetitive AD Inspections! Pawnee Lift Struts FAA/PMA Approved

(Oiled and Sealed
 to comply with
 AD 93-10-06)



Lift Struts (235-260 hp.)L64038-002
 Lift Struts (150 hp.).....U61046-000

PIPER PA-25 PAWNEE

Wings (continued)

**PA-25 Pawnee Wing Parts
Serial Numbers 7405573 and up**

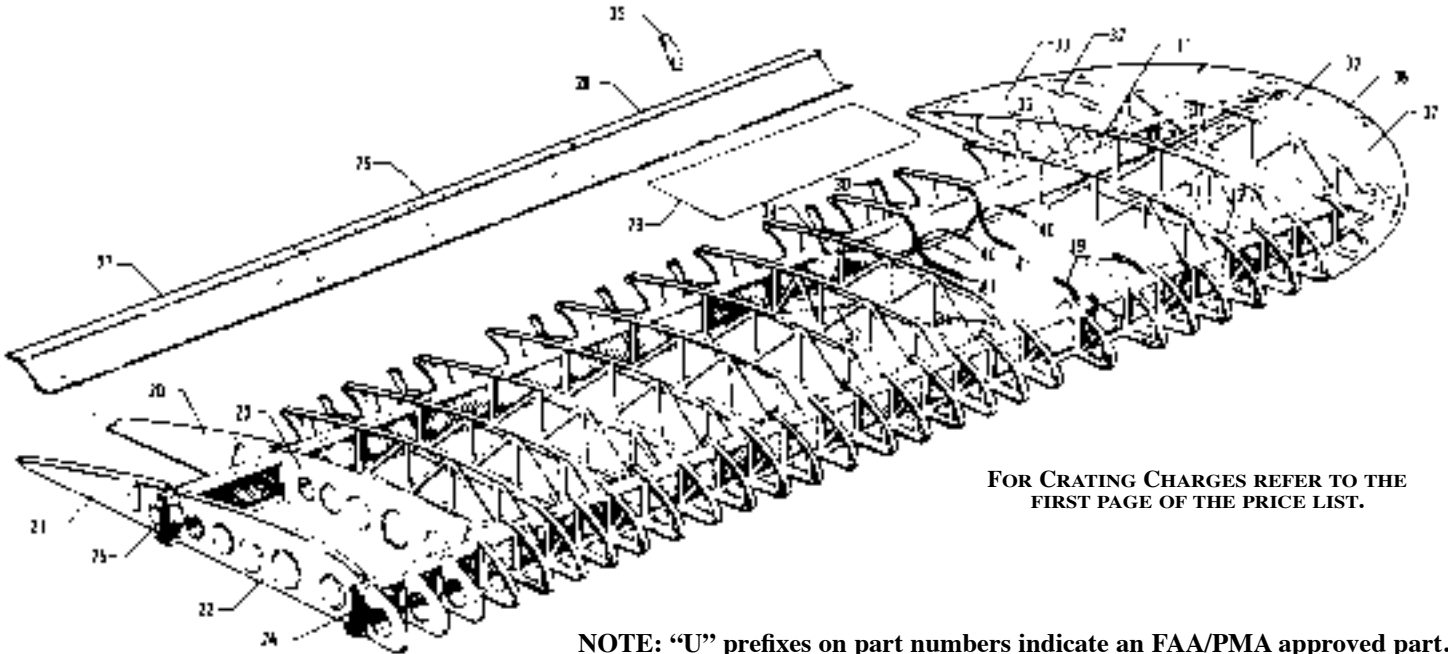

**FOR CRATING CHARGES REFER TO THE
FIRST PAGE OF THE PRICE LIST.**

NOTE: "U" prefixes on part numbers indicate an FAA/PMA approved part.

<i>Figure No. Description</i>	<i>Part Number</i>	<i>No. Required</i>
20	U61210-003	Rib, Trailing Edge, Left Hand.....1
	U61210-002	Rib, Trailing Edge, Right Hand1
21	U61210-000	Rib, Trailing Edge, Left Hand.....1
	U61210-001	Rib, Trailing Edge, Right Hand1
22	U61211-006	Rib, Outboard, Left Hand.....1
	U61211-007	Rib, Outboard, Right Hand1
23	U61211-007	Rib, Center, Left Hand1
	U61211-006	Rib, Center, Right Hand1
24	U64055-006	Spar Assembly, Front, Left Hand.....1
	U64055-007	Spar Assembly, Front, Right Hand.....1
25	U64056-002	Spar Assembly, Rear, Left Hand1
	U64056-003	Spar Assembly, Rear, Right Hand1
26	U64292-000	Spar, False, Left Hand.....1
	U64292-001	Spar, False, Right Hand.....1
27	U61322-000	Spar Assembly, Inboard False, Left Hand1
	U61322-001	Spar Assembly, Inboard False, Right Hand1
28	U15572-002	Spar Assembly, Outboard False, Left Hand1
	U15572-003	Spar Assembly, Outboard False, Right Hand.....1
29	60333-000	Spar Assembly, Wing, False.....1
30	U14541-000	Brace, False Spar.....7
	64258-000	Brace, False Spar, Station 1291
31	U12252-002	Brace, Channel2
32	U12252-003	Brace, Channel9
33	U12252-005	Brace, Channel1
34	U12252-006	Brace, Channel2
35	U13171-000	Gusset, False Spar1
36	U453-126	Tip Bow, Wing1
39	U10648-003	Strap Assembly, Fuel Tank, Front2
40	U10649-003	Strap Assembly, Fuel Tank, Rear2
41	U10650-002	Strap Assembly, Fuel Tank2

NOTE: When ordering, always specify **part number, description, and serial number** of aircraft.

All items on this page are Price Code 150 unless otherwise noted

Price and availability subject to change without notice. Univair's Toll Free Sales: 1-888-433-5433

PIPER PA-25 PAWNEE

PA-25 Pawnee Hydrasorbs

FAA/PMA Approved

- 1 Top FittingU64026-006
- 2 HydrasorbU486-604-1
- 3 Bottom FittingU64029-000
- 4 Shock Cord U31322-005
- 5 Hydrasorb Assembly (1280 HD)
.....U64052-003

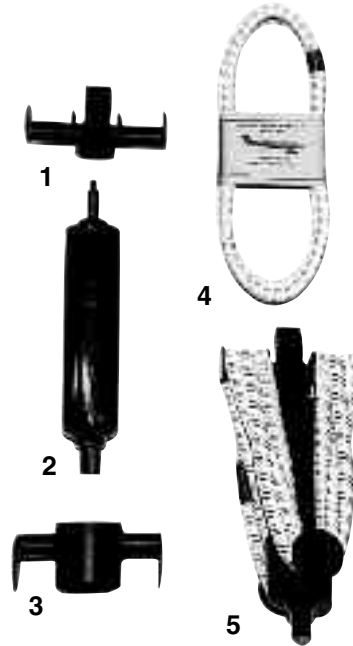

NOTE: These parts are originally used on PA-25 Pawnee 235-260 hp. with Serial Numbers 2772 to 4171 and 7405573 and up.

Windshields

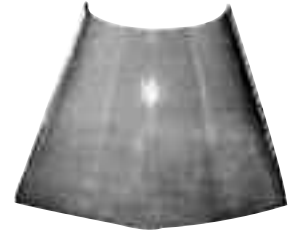

Pawnee Windshields

For SN 1 thru 655

- Clear.....61312-000
- Green Tint61312-000G

For SN 656 and up

- Clear.....61802-003
- Green Tint61802-003G

Pawnee 235-260 hp. Landing Gear FAA/PMA Approved



- Left Hand.....L60277-002
- Right Hand.....L60277-003

Tailwheel for Pawnee 235-260 hp. Serial Numbers 4387 and up (2 Hole Type)



Pawnee Tailwheel **PC 690** 3200-3

Tailwheel Spring Sets FAA/PMA Approved



- Pawnee 4-leaf, 1-hole Set.....PA25TWS1
- Pawnee 150 hp. SetPA18TWS4L
- Pawnee 4-leaf, 2-hole Set
SN 4387-4921PA25TWS2
- SN 4922 and upPA25TWS2-1
- 3 leaf 1 holePA25TWS1-3L

UNIVAIR Carries Many Fine Distributor Items

- AERODUCT
- AIRBORNE
- AIR MAZE
- AIRPATH
- BENDIX
- CECONITE
- CHAMPION
- CLEVELAND
- CONCORDE
- GOODYEAR
- HOBBS
- LYCOMING
- MAULE
- MEGUIARS
- POLY-FIBER
- RANDOLPH
- SPECIALTY TIRES
- STEWART WARNER
- SUPERIOR AERORING
- TEMPO
- WHELEN

Piper Rib Repair Sections

Applicable to Piper
Truss Type Ribs

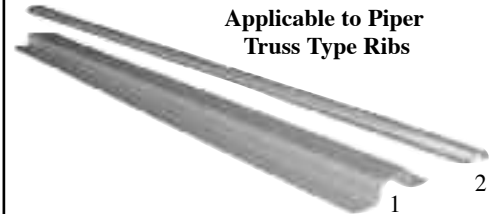

- 1. Rib Cap Repair Splice Strip
(1 foot section) ..(FAA/PMA.....U16651-004
- 2. Diagonal Brace Repair Section
(18 in. long).....U750-287-18

Fabric Reinforcement

Applicable on 235 and
260 hp. Pawnees S/N
25-4727 and up.



Fabric Reinforcement.....64983-000

**Use your PA-25 Parts Manual
with this catalog to assist you when
you order parts from UNIVAIR.**

Toll Free 1 (888) 433-5433

PIPER STC's, Conversions & Modifications

UNIVAIR One-Piece Stamped Aluminum Ribs FAA/STC Approved for Metal Spar Wing Pipers!

Univair wing ribs are not approved on wood spars.

In response to the decreasing availability and increasing cost of many of the original Piper ribs, UNIVAIR has spent considerable time and expense to develop high quality replacement aluminum ribs for the metal spar Pipers.

UNIVAIR ribs are formed out of one piece of .032 5052-H34 aluminum, thus eliminating the many individual braces and cap strips, and the multitude of rivets found in the Piper ribs. This one-piece construction provides a stronger, more durable and less expensive rib. Due to the nature of our rib construction, pop rivets may be used for fabric attachment. Pop rivets provide for a stronger and faster means of fabric attachment. Conventional rib stitching or Martin wire may also be used.

As one can see from our rib application lists on the following pages, we have designed a replacement rib for many of the corresponding Piper ribs. UNIVAIR ribs are designed to be direct replacements and may be used in conjunction with the original Piper ribs. When required, UNIVAIR ribs will include the necessary cable fairlead holes, gas tank cover flanges, etc.—as needed for a proper installation. This means that the butt ribs are designed as butt ribs, not as generic full ribs requiring modification. Flap bay ribs are designed differently from aileron bay ribs, and so on. Our ribs are also approved to be separated into three pieces and reassembled to replace a damaged rib at any station along the wing, thus eliminating the need to take the ribs off of the spars to reach the damaged rib.

When ribs are separated into 3 pieces, a fourth doubler is required to reinforce the spar hole opening.

Doubler for Left Hand Flanged Ribs.....U1303-01
 Doubler for Right Hand Flanged Ribs.....U1303-02
 Fabric Pop Rivet (1/8 inch in diameter, 1/4 inch long) **PC 102**. AD42BSLF

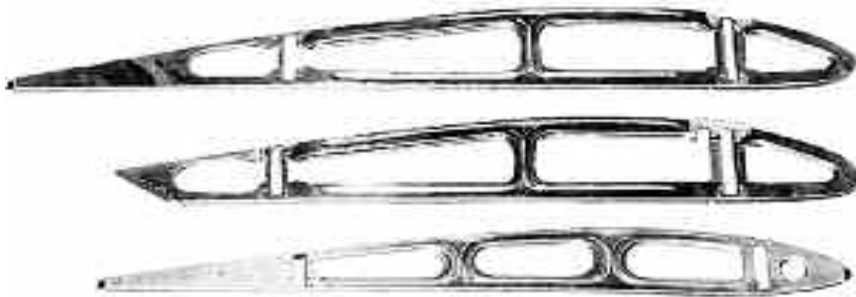

NOTE: For proper replacement rib selection, refer to our Rib Application Lists. There are a few cases where a given Piper rib has more than one corresponding UNIVAIR replacement rib.

Approved Repair and Alternate Installation Procedure

Although it is desirable to install new ribs intact, the following procedure may be used to install new ribs when it is unnecessary to disassemble the remainder of the wing.

When installing a Univair rib in sections, the entire Piper rib must be replaced by a Univair rib. Splicing a section of a Univair rib into a Piper rib is not permitted.

1. Drill out rivets through angles and doublers as required to permit cutting of rib.
2. Cut through rib flange and web so that cut extends vertically from the center of the spar notches. Remove the damaged section.
3. Deburr cut areas as required.
4. Reassemble rib using new section(s) as required. Reattach doublers using AN470AD4 sections in the original holes. If desired, rivets may be replaced by #6 or #8 steel machine screws and AN365 stop nuts.
5. Since UNIVAIR stamped replacement ribs do not have a doubler at the upper rear spar notch, one must be installed if the flange and web are cut at this point. Install doubler with the doubler flange and rib flange facing the same direction. Using existing holes as a guide, drill holes through doubler and install rivets or screws as per step #4.

APPLICATION LISTS FOR UNIVAIR WING RIBS

J-3			
Piper #	Univair No.	Description	# Per Wing
10742-002	..U1202-00Tip Rib, LH #131
10742-003	..U1202-01Tip Rib, RH #131
12662-002	..U1200-02Nose Rib10
12902-000	..U1206-00Outboard Aileron Bay Rib, LH #121
12902-001	..U1206-01Outboard Aileron Bay Rib, RH #121
13022-002	..U1207-003/4 Rib, #10 and #112
13022-002	..U1207-023/4 Rib, LH or RH #71
13022-002	..U1207-033/4 Rib, LH or RH #81
13022-005	..U1223-013/4 Rib, LH or RH #61
13022-006	..U1208-003/4 Rib, #9 at strut point1
13042-000	..U1228-00Inboard Aileron Bay Rib, LH #51
13042-001	..U1228-01Inboard Aileron Bay Rib, RH #51
13052-002	..U1227-04Full Rib, LH or RH #21
13052-002	..U1228-003/4 Rib, #3 and #42
13052-004	..U1227-00Butt Rib, LH #11
13052-004	..U1227-01Butt Rib, RH #11
15712-000	..U1200-05Nose Rib at strut point1
16192-000	..U1216-00Tip Nose Rib, LH1
16192-001	..U1216-01Tip Nose Rib, RH1

PA-11			
Piper #	Univair No.	Description	# Per Wing
10634-000	..U1219-00Butt Rib, LH #11
10634-008	..U1219-01Butt Rib, RH #1, w/RH tank1
10635-000	..U1224-00Tank Rib, LH #21
10653-000	..U1221-01Full Rib, LH #31
10653-006	..U1221-00Full Rib, RH #3, w/RH tank1
10742-002	..U1202-00Tip Rib, LH #131
10742-003	..U1202-01Tip Rib, RH #131
10907-000	..U1217-00Full Rib, RH #31
10908-000	..U1217-01Butt Rib, RH #11
12662-002	..U1200-02Nose Rib8-L, 10-R
12662-004	..U1200-08Nose Rib at Tank Bay2
12902-000	..U1206-00Outboard Aileron Bay Rib, LH #121
12902-001	..U1206-01Outboard Aileron Bay Rib, RH #121
13022-002	..U1207-003/4 Rib, #7, #8, #10 and #114
13022-005	..U1209-003/4 Rib, LH or RH #61
13022-006	..U1208-003/4 Rib, #9 at strut point10742-001
U1203-01	..U1217-01Tip Rib, RH #161
13042-000	..U1222-00Inboard Aileron Bay Rib, LH #51
13042-001	..U1222-01Inboard Aileron Bay Rib, RH #51
13052-002	..U1220-02Full Rib, R #2, L/R #41-L, 2-R
15712-000	..U1200-05Nose Rib at strut point1
16192-000	..U1216-00Tip Nose Rib, LH1
16192-001	..U1216-01Tip Nose Rib, RH1

J-5C, PA-12			
Piper #	Univair No.	Description	# Per Wing
10108-002	..U1235-02Full Rib, LH #41
10108-003	..U1235-03Full Rib, RH #41
10109-000	..U1236-00Full Rib, LH or RH #51
10119-000	..U1234-00Tank Bay Rib, L/R #2 and #32
10222-002	..U1235-00Butt Rib, LH #11
10227-003	..U1235-01Butt Rib, RH #11
10642-005	..U1236-01Full Rib, LH or RH #61
10692-004	..U1236-02Inboard Aileron Bay Rib, LH #71
10692-005	..U1236-03Inboard Aileron Bay Rib, RH #71
10702-004	..U1236-04Outboard Aileron Bay Rib, LH #151
10702-005	..U1236-05Outboard Aileron Bay Rib, RH #151
10712-003	..U1237-063/4 Rib, LH or RH #141
10722-003	..U1237-023/4 Rib, LH or RH #111
10732-004	..U1237-003/4 Rib, LH or RH #91
10732-005	..U1237-013/4 Rib, #8, #10, #12 and #134
10742-000	..U1203-00Tip Rib, LH #161

Caution:
If fabric is rib stitched to Univair stamped ribs, DO NOT use pre-drilled pop rivet holes. Pass rib stitch cord around the outside surfaces of the rib just like on the original truss type Piper ribs.

All items on this page are Price Code 150 unless otherwise noted
 Price and availability subject to change without notice. Univair's Toll Free Sales: 1-888-433-5433

PIPER STC's, Conversions & Modifications

Application Lists for UNIVAIR Wing Ribs (continued)

PA-14

Piper #	Univair No.	Description	# Per Wing
10702-004	U1236-04	Outboard Aileron Bay Rib, LH #15	1
10702-005	U1236-05	Outboard Aileron Bay Rib, RH #15	1
10712-003	U1237-06	3/4 Rib, LH or RH, #14	1
10722-003	U1237-02	3/4 Rib, LH or RH, #11	1
10732-005	U1237-03	3/4 Rib, #8, #10, #12 and #13	4
10732-006	U1237-04	3/4 Rib, LH or RH, #7 and #9	2
10732-007	U1237-05	3/4 Rib, LH or RH, #6	1
10732-008	U1237-03	3/4 Rib, LH or RH, #5	1
10742-000	U1203-00	Tip Rib, LH #16	1
10742-001	U1203-01	Tip Rib, RH #16	1
11687-000	U1238-00	Butt Rib, LH #1	1
11687-002	U1238-01	Butt Rib, RH #1	1
11688-000	U1234-01	Tank Bay Rib, LH or RH, #2	1
11688-002	U1234-02	Tank Bay Rib, LH or RH, #3	1
11689-002	U1238-02	3/4 Rib, LH #4	1
11689-003	U1238-03	3/4 Rib, RH #4	1

PA-15 and PA-17

Piper #	Univair No.	Description	# Per Wing
10742-002	U1202-00	Tip Rib, LH #11	1
10742-003	U1202-01	Tip Rib, RH #11	1
12662-002	U1200-02	Nose Rib	6
12902-000	U1206-00	Outboard Aileron Bay Rib, LH #10	1
12902-001	U1206-01	Outboard Aileron Bay Rib, RH #10	1
13022-002	U1207-00	3/4 Rib, #5, #6, #8 and #9	4
13022-006	U1208-00	3/4 Rib, LH or RH, #7	1
13022-007	U1233-00	3/4 Rib, LH or RH, #4	1
13042-000	U1228-02	Inboard Aileron Bay Rib, LH #3	1
13042-001	U1228-03	Inboard Aileron Bay Rib, RH #3	1
13052-002	U1228-05	Full Rib, LH or RH, #2	1
13052-005	U1227-02	Butt Rib, LH #1	1
13052-005	U1227-03	Butt Rib, RH #1	1
15712-000	U1200-05	Nose Rib at strut point	1
16192-000	U1216-00	Tip Nose Rib, LH	1
16192-001	U1216-01	Tip Nose Rib, RH	1

PA-16

Piper #	Univair No.	Description	# Per Wing
10634-002	U1229-00	Butt Rib, LH #1	1
10635-000	U1224-00	Tank Bay Rib, LH #2	1
10742-002	U1202-00	Tip Rib, LH #12	1
10742-003	U1202-01	Tip Rib, RH #12	1
11750-000	U1232-00	Inboard Aileron Bay Rib, LH #3	1
11752-000	U1225-02	3/4 Tank Bay Rib, LH #4	1
12046-002	U1228-05	Full Rib, RH #2	1
12046-003	U1228-03	Inboard Aileron Bay Rib, RH #3	1
12046-004	U1207-00	3/4 Rib, #6-#9, #5 R, #10 L, 5 L, 5 R	1
12046-006	U1233-00	3/4 Rib, LH #5, RH #4	1
12046-007	U1206-00	Outboard Aileron Bay Rib, LH #11	1
12046-008	U1206-01	Outboard Aileron Bay Rib, RH #11	1
12662-002	U1200-02	Nose Rib	6 L, 5 R
13052-005	U1227-03	Butt Rib, RH #1	1
15712-000	U1200-05	Nose Rib at strut point	1
16192-000	U1216-00	Tip Nose Rib, LH	1
16192-001	U1216-01	Tip Nose Rib, RH	1

PA-18 95 hp.

Piper #	Univair No.	Description	# Per Wing
10634-004	U1219-00	Butt Rib, LH #1	1
10634-008	U1219-01	Butt Rib, RH #1	1
10635-000	U1224-00	Tank Bay Rib, L/R #2 w/RH tank	1

PA-18 95 hp. (continued)

Piper #	Univair No.	Description	# Per Wing
10653-000	U1221-01	Tank Bay Rib, LH #3	1
10653-006	U1221-00	Tank Bay Rib, RH #3 w/RH tank	1
10742-002	U1202-00	Tip Rib, LH #13	1
10742-003	U1202-01	Tip Rib, RH #13	1
10907-000	U1217-00	Full Rib, RH #3 w/o RH tank	1
10908-003	U1217-01	Butt Rib, RH #1 w/o RH tank	1
12662-002	U1200-02	Nose Rib	Note C
12662-004	U1200-08	Nose Rib at Tank Bay	Note D
12902-000	U1206-00	Outboard Aileron Bay Rib, LH #12	1
12902-001	U1206-01	Outboard Aileron Bay Rib, RH #12	1
13022-002	U1207-00	3/4 Rib, #7, #8, #10 and #11	4
13022-005	U1209-00	3/4 Rib, #6	1
13022-009	U1208-00	3/4 Rib, LH or RH, #9	1
13042-000	U1222-00	Inboard Aileron Bay Rib, LH #5	1
13042-001	U1222-01	Inboard Aileron Bay Rib, RH #5	1
13052-002	U1220-02	Full Rib, RH #2 w/o RH tank	1
		Full Rib, LH or RH, #4	1
15712-000	U1200-05	Nose Rib at strut point	1
16192-000	U1216-00	Tip Nose Rib, LH	1
16192-001	U1216-01	Tip Nose Rib, RH	1

PA-18 105-125 hp.

Piper #	Univair No.	Description	# Per Wing
10634-005	U1215-01	Butt Rib, LH #1 (With Flaps)	1
10634-007	U1215-02	Butt Rib, RH #1 w/RH tank (With Flaps)	1
10635-002	U1214-00	Tank Bay Rib, L/R #2 w/RH tank	1
10653-002	U1213-01	3/4 Rib, LH #3	1
10653-005	U1213-00	3/4 Rib, RH #3 w/RH tank	1
10742-002	U1202-00	Tip Rib, LH #13	1
10742-003	U1202-01	Tip Rib, RH #13	1
10907-002	U1213-02	3/4 Rib, RH #3 w/o RH tank	1
10908-004	U1215-10	Butt Rib, RH #1 w/o RH tank	1
12662-002	U1200-02	Nose Rib	Note C
12662-004	U1200-08	Nose Rib at Tank Bay	Note D
12902-000	U1206-00	Outboard Aileron Bay Rib, LH #12	1
12902-001	U1206-01	Outboard Aileron Bay Rib, RH #12	1
13022-002	U1207-00	3/4 Rib, #6 thru #8, #10 and #11	5
13022-009	U1208-00	3/4 Rib, LH or RH, #9	1
13042-002	U1210-01	3/4 Rib, LH #5	1
13042-003	U1210-00	3/4 Rib, RH #5	1
13052-007	U1212-00	3/4 Rib, RH #2 w/o RH tank	1
		3/4 Rib, LH or RH, #4	1
15712-000	U1200-05	Nose Rib at strut point	1
16192-000	U1216-00	Tip Nose Rib, LH	1
16192-001	U1216-01	Tip Nose Rib, RH	1

PA-18 135 hp.

Piper #	Univair No.	Description	# Per Wing
10634-005	U1215-01	Butt Rib, LH #1	1
10634-007	U1215-02	Butt Rib, RH #1	1
10635-002	U1214-00	Tank Bay Rib, LH #2—Note A	1
		Tank Bay Rib, #2 and #3—Note B	2
10653-002	U1213-01	3/4 Rib, LH #3	1
		3/4 Rib, LH #4—Note B	1
10653-005	U1213-00	3/4 Rib, RH #3	1
		3/4 Rib, RH #4—Note B	1
10742-002	U1202-00	Tip Rib, LH #13	1
10742-003	U1202-01	Tip Rib, RH #13	1
12662-002	U1200-02	Nose Rib	10
12262-004	U1200-08	Nose Rib Tank Bay	2 L, 2 R, w/tank
12902-000	U1206-00	Outboard Aileron Bay Rib, LH #12	1
12902-001	U1206-01	Outboard Aileron Bay Rib, RH #12	1

PA-18 135 hp. (continued)

Piper #	Univair No.	Description	# Per Wing
13022-002	U1207-00	3/4 Rib, #6 thru #11—Note A	6
		3/4 Rib, LH or RH, #10—Note B	1
13022-009	U1208-00	3/4 Rib, LH or RH, #11—Note B	1
13022-010	U1209-00	3/4 Rib, LH or RH, #8—Note B	1
13022-011	U1207-00	3/4 Rib, LH or RH, #9—Note B	1
13042-002	U1210-01	3/4 Rib, LH #5—Note A	1
		3/4 Rib, LH #7—Note B	1
13042-003	U1210-00	3/4 Rib, RH #5—Note A	1
		3/4 Rib, RH #7—Note B	1
13052-007	U1212-00	3/4 Rib, LH or RH, #5—Note B	1
13052-009	U1211-01	3/4 Rib, RH #6—Note B	1
13052-010	U1211-00	3/4 Rib, LH #6—Note B	1
15712-000	U1200-05	Nose Rib at strut point—Note A	1
15712-002	U1200-05	Nose Rib at strut point—Note B	1
16192-000	U1216-00	Tip Nose Rib, LH	1
16192-001	U1216-01	Tip Nose Rib, RH	1

PA-18 150 hp.

Piper #	Univair No.	Description	# Per Wing
10634-005	U1215-01	Butt Rib, LH #1	1
10634-007	U1215-02	Butt Rib, RH #1	1
10635-002	U1214-00	Tank Bay Rib, #2 and #3	2
10653-002	U1213-01	3/4 Rib, LH #4	1
10653-005	U1213-00	3/4 Rib, RH #4	1
10742-002	U1202-00	Tip Rib, LH #16	1
10742-003	U1202-01	Tip Rib, RH #16	1
12662-002	U1200-02	Nose Rib	10
12902-000	U1206-00	Outboard Aileron Bay Rib, LH #15	1
12902-001	U1206-01	Outboard Aileron Bay Rib, RH #15	1
13022-002	U1207-00	3/4 Rib, #10, #13 and #14	3
13022-009	U1208-00	3/4 Rib, LH or RH, #11	1
13022-010	U1209-00	3/4 Rib, LH or RH, #8	1
13022-011	U1207-00	3/4 Rib, LH or RH, #9 and #12	2
13042-002	U1210-01	3/4 Rib, LH #7	1
13042-003	U1210-00	3/4 Rib, RH #7	1
13052-007	U1212-00	3/4 Rib, LH or RH, #5	1
13052-009	U1211-01	3/4 Rib, RH #6	1
13052-010	U1211-00	3/4 Rib, LH #6	1
15712-000	U1200-05	Nose Rib at strut point	1
16192-000	U1216-00	Tip Nose Rib, LH	1
16192-001	U1216-01	Tip Nose Rib, RH	1

PA-20 115 hp.

Piper #	Univair No.	Description	# Per Wing
10634-002	U1229-00	Butt Rib, LH #1	1
10634-006	U1229-01	Butt Rib, RH #1	1
10635-000	U1224-00	Tank Bay Rib, #2 and #3	2
10742-002	U1202-00	Tip Rib, LH #12	1
10742-003	U1202-01	Tip Rib, RH #12	1
12046-003	U1228-03	Inboard Aileron Bay Rib, RH #6	1
12046-004	U1207-00	3/4 Rib, LH or RH #7 thru #10	4
12046-007	U1206-00	Outboard Aileron Bay Rib, LH #11	1
12046-008	U1206-01	Outboard Aileron Bay Rib, RH #11	1
12046-009	U1228-02	Inboard Aileron Bay Rib, LH #6	1
12046-010	U1229-02	Full Rib, LH #4	1
12046-011	U1229-03	Full Rib, RH #4	1
12662-002	U1200-02	Nose Rib	5
12825-000	U1218-00	Full Rib, LH or RH #5	1
15712-000	U1200-05	Nose Rib at strut point	1
16192-000	U1216-00	Tip Nose Rib, LH	1
16192-001	U1216-01	Tip Nose Rib, RH	1

Note A: For SN 1 thru 3770 and 3772 thru 3780. **Note B:** For SN 3771 and 3781 and up. **Note C:** Without RH tank: 10 Ribs—RH Wing, 8 Ribs—LH Wing. With RH tank: 8 Ribs—RH Wing, 8 Ribs—LH Wing. **Note D:** Only with tank: 2 Ribs—RH Wing, 2 Ribs—LH Wing.

PIPER STC's, Conversions & Modifications

Application Lists for UNIVAIR Wing Ribs (continued)

PA-20 125-135 hp.

Piper #	Univair No.	Description	# Per Wing
10742-002	.U1202-00	Tip Rib, LH #12	1
10742-003	.U1202-01	Tip Rib, RH #12	1
11752-000	.U1225-02	3/4 Rib, LH #4	1
11752-001	.U1225-03	3/4 Rib, RH #4	1
12046-004	.U1207-00	3/4 Rib, #5 thru #10	6
12046-007	.U1206-00	Outboard Aileron Bay Rib, LH #11	1
12046-008	.U1206-01	Outboard Aileron Bay Rib, RH #11	1
12470-000	.U1225-00	Butt Rib, LH #1	1
12470-001	.U1225-01	Butt Rib, RH #1	1
12472-000	.U1226-00	Tank Bay Rib, LH/RH, #2 and #3	2
12662-002	.U1200-02	Nose Rib	5
15712-000	.U1200-05	Nose Rib at strut point	1
16192-000	.U1216-00	Tip Nose Rib, LH	1
16192-001	.U1216-01	Tip Nose Rib, RH	1

PA-22 108 hp.

Piper #	Univair No.	Description	# Per Wing
10634-002	.U1229-00	Butt Rib, LH #1	1
10634-009	.U1229-01	Butt Rib, RH #1 w/RH tank	1
10635-000	.U1224-00	Tank Bay Rib, LH #2 and #3	2
10635-003	.U1224-00	Tank Bay Rib, RH #2 and #3 w/RH tank	2
10742-002	.U1202-00	Tip Rib, LH #13	1
10742-003	.U1202-01	Tip Rib, RH #13	1
12046-002	.U1228-05	Full Rib, RH #2 thru #4, w/o RH tank	3
12046-004	.U1207-00	3/4 Rib, #6 thru #11	6
12046-007	.U1206-00	Outboard Aileron Bay Rib, LH #12	1
12046-008	.U1206-01	Outboard Aileron Bay Rib, RH #12	1
12046-010	.U1229-02	Full Rib, LH #4	1
12046-011	.U1229-03	Full Rib, RH #4 w/RH tank	1
12662-002	.U1200-02	Nose Rib	7
12825-000	.U1218-00	Full Rib, LH or RH, #5	1
13052-011	.U1227-03	Butt Rib, RH #1 w/o RH tank	1
15131-000	*	Inboard Aileron Bay Trailing Edge Rib, LH	1
15131-001	*	Inboard Aileron Bay Trailing Edge Rib, RH	1
15712-002	.U1200-05	Nose Rib at strut point	1
16192-000	.U1216-00	Tip Nose Rib, LH	1
16192-001	.U1216-01	Tip Nose Rib, RH	1

PA-22 125-135 hp.

Piper #	Univair No.	Description	# Per Wing
10742-002	.U1202-00	Tip Rib, LH #12	1
10742-003	.U1202-01	Tip Rib, RH #12	1
11752-000	.U1225-02	3/4 Rib, LH #4	1
11752-001	.U1225-03	3/4 Rib, RH #4	1
12046-004	.U1207-00	3/4 Rib, #5 thru #10	6
12046-007	.U1206-00	Outboard Aileron Bay Rib, LH #11	1
12046-008	.U1206-01	Outboard Aileron Bay Rib, RH #11	1
12470-000	.U1225-00	Butt Rib, LH #1	1
12470-001	.U1225-01	Butt Rib, RH #1	1
12472-000	.U1226-00	Tank Bay Rib, #2 and #3	2
12662-002	.U1200-02	Nose Rib	5
15712-000	.U1200-05	Nose Rib at strut point	1
16192-000	.U1216-00	Tip Nose Rib, LH	1
16192-001	.U1216-01	Tip Nose Rib, RH	1

PA-22 150-160 hp.

Piper #	Univair No.	Description	# Per Wing
10742-002	.U1202-00	Tip Rib, LH #13	1
10742-003	.U1202-01	Tip Rib, RH #13	1
11752-000	.U1225-02	3/4 Rib, LH #4	1
11752-001	.U1225-03	3/4 Rib, RH #4	1
12046-004	.U1207-00	3/4 Rib, #5 thru #11	7
12046-007	.U1206-00	Outboard Aileron Bay Rib, LH #12	1
12046-008	.U1206-01	Outboard Aileron Bay Rib, RH #12	1
12470-000	.U1225-00	Butt Rib, LH #1	1
12470-001	.U1225-01	Butt Rib, RH #1	1
12472-000	.U1226-00	Tank Bay Rib, #2 and #3	2
12662-002	.U1200-02	Nose Rib	7
15712-000	.U1200-05	Nose Rib at strut point	1
16192-000	.U1216-00	Tip Nose Rib, LH	1
16192-001	.U1216-01	Tip Nose Rib, RH	1

PA-25 150

Piper #	Univair No.	Description	# Per Wing
61068-000	*	Nose Rib, LH #1	1
61068-001	*	Nose Rib, RH #1	1
61068-002	*	Nose Rib, LH #2 and #3	2
61068-003	*	Nose Rib, RH #2 and #3	2
61068-004	*	Nose Rib, LH #4	1
61068-005	*	Nose Rib, RH #4	1
12662-002	.U1200-02	Nose Rib, #5 - #11 and #13 - #16	11
12662-005	.U1200-07	Nose Rib #12	1
16192-000	.U1216-00	Tip Nose Rib, LH	1
16192-001	.U1216-01	Tip Nose Rib, RH	1
61424-004	*	3/4 Rib, #3, #5 and #6	3
61424-002	*	3/4 Rib, #4	1
61424-003	*	3/4 Rib, #7	1
61424-006	*	3/4 Rib, #8	1
61298-000	*	3/4 Rib, #9	1
61424-005	*	3/4 Rib, #10	1
13022-011	.U1207-00	3/4 Rib, #11	1
13022-002	.U1207-02	3/4 Rib, #12 and #13	2
12902-000	.U1206-00	Outboard Aileron Bay Rib, LH #14	1
12902-001	.U1206-01	Outboard Aileron Bay Rib, RH #14	1
10742-002	.U1202-00	Tip Rib, LH #15	1
10742-003	.U1202-01	Tip Rib, RH #15	1
61210-000	.U61210-000	Trailing Edge Wing Walk Rib, LH #1 - Note E	1
61210-001	.U61210-001	Trailing Edge Wing Walk Rib, RH #1 - Note E	1
61210-003	.U61210-003	Trailing Edge Wing Walk Rib, LH #2 - Note E	1
61210-002	.U61210-002	Trailing Edge Wing Walk Rib, RH #2 - Note E	1
61211-004	.U61211-006	Wing Walk Rib, LH #1	1
61211-005	.U61211-007	Wing Walk Rib, RH #1	1
61211-007	.U61211-007	Wing Walk Rib, LH #2 - Note E	1
61211-006	.U61211-006	Wing Walk Rib, RH #2 - Note E	1

PA-25 235D and 260D

Piper #	Univair No.	Description	# Per Wing
61068-000	*	Nose Rib, LH #1	1
61068-001	*	Nose Rib, RH #1	1
61068-002	*	Nose Rib, LH, #2 and #3	2
61068-003	*	Nose Rib, RH, #2 and #3	2
61068-004	*	Nose Rib, LH #4	1
61068-005	*	Nose Rib, RH #4	1
12662-002	.U1200-02	Nose Rib, #5 thru #11 and #15	8
12662-005	.U1200-07	Nose Rib #12	1
12662-004	.U1200-08	Nose Tank Bay Rib #13 and #14	2
16192-000	.U1216-00	Tip Nose Rib, LH	1
16192-001	.U1216-01	Tip Nose Rib, RH	1
64269-000	*	3/4 Rib, #3 and #5	2
64267-002	*	3/4 Rib, #6	1
64268-000	*	3/4 Rib, #4	1
64216-000	*	3/4 Rib, #7	1
64215-000	*	3/4 Rib, #8	1
64217-002	*	3/4 Rib, #9	1
64214-002	*	3/4 Inboard Tank Bay Rib, LH #10	1
64214-003	*	3/4 Inboard Tank Bay Rib, RH #10	1
60304-000	*	Tank Bay Rib, #11 and #12	2
13022-012	*	3/4 Outboard Tank Bay Rib, LH #13	1
13022-013	*	3/4 Outboard Tank Bay Rib, RH #13	1
12902-000	.U1206-00	Outboard Aileron Bay Rib, LH #14	1
12902-001	.U1206-01	Outboard Aileron Bay Rib, RH #14	1
10742-002	.U1202-00	Tip Rib, LH #15	1
10742-003	.U1202-01	Tip Rib, RH #15	1
61210-000	.U61210-000	Trailing Edge Wing Walk Rib, LH #1 - Note E	1
61210-001	.U61210-001	Trailing Edge Wing Walk Rib, RH #1 - Note E	1
61210-003	.U61210-003	Trailing Edge Wing Walk Rib, LH #2 - Note E	1
61210-002	.U61210-002	Trailing Edge Wing Walk Rib, RH #2 - Note E	1
61211-004	.U61211-006	Wing Walk Rib, LH #1	1
61211-005	.U61211-007	Wing Walk Rib, RH #1	1
61211-007	.U61211-007	Wing Walk Rib, LH #2 - Note E	1
61211-006	.U61211-006	Wing Walk Rib, RH #2 - Note E	1

PA-25 235D and 260D (continued)

Piper #	Univair No.	Description	# Per Wing
61211-006	.U61211-006	Wing Walk Rib, RH #2 - Note E	1
15831-007	.U1200-02	Nose Rib, #5 thru #11, #13 and #15 - Note F	9
15831-007	.U1200-07	Nose Rib #12 - Note F	1
15831-008	.U1200-08	Nose Tank Bay Rib #14 - Note F	1

PA-25 235, 235B, 235C and 260C

Piper #	Univair No.	Description	# Per Wing
61068-000	*	Nose Rib, LH #1	1
61068-001	*	Nose Rib, RH #1	1
61068-002	*	Nose Rib, LH, #2 and #3	2
61068-003	*	Nose Rib, RH, #2 and #3	2
61068-004	*	Nose Rib, LH #4	1
61068-005	*	Nose Rib, RH #4	1
12662-002	.U1200-02	Nose Rib, #5 thru #11, #13, #15 and #16	10
12662-005	.U1200-07	Nose Rib #12	1
16192-000	.U1216-00	Tip Nose Rib, LH	1
16192-001	.U1216-01	Tip Nose Rib, RH	1
64269-000	*	3/4 Rib, #3 and #5	2
64267-002	*	3/4 Rib, #6	1
64268-000	*	3/4 Rib, #4	1
64216-000	*	3/4 Rib, #7	1
64215-000	*	3/4 Rib, #8	1
64217-002	*	3/4 Rib, #9	1
64214-000	*	3/4 Rib, #10	1
64212-000	*	3/4 Rib, #11	1
13022-002	.U1207-00	3/4 Rib, #12 and #13	2
12902-000	.U1206-00	Outboard Aileron Bay Rib, LH #14	1
12902-001	.U1206-01	Outboard Aileron Bay Rib, RH #14	1
10742-002	.U1202-00	Tip Rib, LH #15	1
10742-003	.U1202-01	Tip Rib, RH #15	1
61210-000	.U61210-000	Trailing Edge Wing Walk Rib, LH #1 - Note E	1
61210-001	.U61210-001	Trailing Edge Wing Walk Rib, RH #1 - Note E	1
61210-003	.U61210-003	Trailing Edge Wing Walk Rib, LH #2 - Note E	1
61210-002	.U61210-002	Trailing Edge Wing Walk Rib, RH #2 - Note E	1
61211-004	.U61211-006	Wing Walk Rib, LH #1	1
61211-005	.U61211-007	Wing Walk Rib, RH #1	1
61211-007	.U61211-007	Wing Walk Rib, LH #2 - Note E	1
61211-006	.U61211-006	Wing Walk Rib, RH #2 - Note E	1

For "Approved Repair and Alternate Installation Procedure" see page 5-58

When using a Univair stamped aluminum replacement rib, AD42BSLF pop rivets may be used as the fabric attachment method. The pop rivet is installed through standard 1/2-inch reinforcement tape and covered with 2-inch fabric tape, just as though rib stitching were used. The hole for the pop rivet is to be made with an awl or other sharp pointed, round instrument to part the cloth fibers rather than cut them. All ribs requiring fabric attachment are pre-drilled at the approved location and spacing. In some wing assemblies, the same rib may be placed both within the propeller slipstream and outside the propeller slipstream. All Univair stamped ribs have flanges that are drilled for use outside the slipstream. (3-inch rivet spacing, approximate) To use these ribs within the slipstream area, drill an additional #30 rivet hole centered between each existing hole. The nose ribs do not require fabric attachment; therefore, no holes are drilled for the pop rivets. Notches on some wing leading edge covers may require modification to clear the upper reinforcement doubler on Univair ribs. Remove only the minimum amount of material necessary to clear the doubler and deburr the notch as required after modification.

SHEET METAL SCREW ATTACHMENT OF FABRIC IS NOT PERMITTED.

* UNIVAIR equivalent is not available at this time.

Note E: Indicates UNIVAIR ribs FAA/PMA approved separately from these STC'd ribs.

Note F: Indicates Piper stamped aluminum ribs that may replace original built-up Piper ribs.

All items on this page are Price Code 150 unless otherwise noted

Price and availability subject to change without notice. Univair's Toll Free Sales: 1-888-433-5433

PIPER STC's, Conversions & Modifications

Wing Assemblies Using UNIVAIR Ribs (uncovered)

<i>Model and hp.</i>	<i>Left Hand</i>	<i>Right Hand</i>
J-3 (STC/PMA Approved)	U15556-000	U15556-001
PA-11	10625-000UR	10625-001UR
PA-12	14766-002UR	14766-001UR
PA-15/17	11520-000UR	11520-001UR
PA-16	11777-000UR	11777-001UR
PA-18 95 hp., SN 1 thru 468 (without Tank Bay)	10625-004UR	10625-003UR
PA-18 95 hp., SN 469 and up (with Tank Bay)	10625-006UR	10625-005UR
PA-18 105-125 hp., SN 1 thru 468 (without Tank Bay)	12778-000UR	12778-001UR
PA-18 105-125 hp., SN 469 and up (with Tank Bay)	12778-004UR	12778-003UR
PA-18 135 hp.	12778-008UR	12778-003UR
PA-18 150 hp. (STC/PMA Approved)	U14394-000	U14394-001
PA-20 125 hp.	12483-000UR	12483-001UR
PA-20 135 hp.	12483-002UR	12483-001UR
PA-22 108 hp. (without Tank in Right Wing)	15094-000UR	15094-001UR
PA-22 108 hp. (with Tank in Right Wing)	15094-000UR	15094-003UR
PA-22 125 hp.	12483-000UR	12483-001UR
PA-22 135 hp.	12483-002UR	12483-003UR
PA-22 150-160 hp.	14407-000UR	14407-001UR

NOTE: J-3 and PA-18-150 wings are kept in stock. All other wings are built on a made-to-order basis. Crating charges apply; see first page of Price List.

STC's, Conversions and Modifications

Lycoming O-290-D in J-5A Only

Includes a 501 engine mount, installation instructions and STC approval.

Part Number **PC 155** STC-SA495AL

STC-SA35AL

PA-11 Flap Conversion Kit

Consists of two each PA-18 flaps, flap handle, flap handle support, flap brackets, cables, pulleys, pulley supports, fairleads, bushing supports, and installation instructions.

STC Approval Only STC-SA35AL
STC and Flaps (Uncovered)..... STC-SA35ALU

**If there is something you want,
but can't find, contact us!**

Univair Aircraft Corporation
2500 Himalaya Road
Aurora, CO 80011-8156
Toll Free Sales: 1-888-433-5433
Information: 303-375-8882
e-mail: info@univair.com
web site: www.univair.com

STC's, Conversions and Modifications (continued)

J-3 C Crankcase Pressure Relief Valve

Relieves crankcase pressure and prevents engine damage and failure due to oil loss from from freezing of breather line.

Crankcase Pressure Relief Valve
and STC **PC 155** STC-SA507AL

PA-20 Crankcase Pressure Relief Valve

Relieves crankcase pressure and prevents engine damage and failure due to oil loss from freezing of the breather line.

For all Lycoming 0-320

Pressure Relief Valve and STC..... STC-SA509AL
PC 155

Crankcase Pressure Relief Valve for Lycoming 0-320 Series

Relieves crankcase pressure and prevents engine damage and failure due to oil loss from freezing of the breather line.

Part Number **PC 155** STC-SE508AL

1 1/2 inch Axle Landing Gear for PA-18

This STC is required for installation of the L10033 and L1015 series gears with 1 1/2 inch axle for either Cleveland or McCauley wheels and brakes. See PA-18 Landing Gear section for details on gears.

Part NumberSTC-SA17RMM

STC's, Conversions and Modifications (continued)

Drum-to-Disc Brakes for the PA-22

This kit consists of two Cleveland 40-28 wheels, two Cleveland 30-18 brakes and one STC Approval.

Part Number STC-SA91AL
PC 155

Rib Kits using the Univair Stamped Aluminum Wing Ribs (ribs only)

<i>Description</i>	<i>Kit No.</i>
J-3 Rib Kit, LH	RK-0301
J-3 Rib Kit, RH	RK-0302
PA-11 Rib Kit, LH	RK-1101
PA-11 Rib Kit, RH	RK-1102
PA-11 Rib Kit, RH, with Tank Bay	RK-1103
PA-12 Rib Kit, LH	RK-1201
PA-12 Rib Kit, RH	RK-1202
PA-14 Rib Kit, LH	RK-1401
PA-14 Rib Kit, RH	RK-1402
PA-15/17 Rib Kit, LH	RK-1501
PA-15/17 Rib Kit, RH	RK-1502
PA-16 Rib Kit, LH	RK-1601
PA-16 Rib Kit, RH	RK-1602
PA-18 95 hp. Rib Kit, LH	RK-1801
PA-18 95 hp. Rib Kit, RH	RK-1802
PA-18 95 hp. Rib Kit, RH, with Tank Bay	RK-1803
PA-18 105-125 hp. Rib Kit, LH	RK-1804
PA-18 105-125 hp. Rib Kit, RH	RK-1805
PA-18 105-125 hp. Rib Kit, RH, with Tank Bay	RK-1806
PA-18 135 hp. Rib Kit, LH, early	RK-1807
PA-18 135 hp. Rib Kit, RH, early	RK-1808
PA-18 135 hp. Rib Kit, LH, late	RK-1809
PA-18 135 hp. Rib Kit, RH, late	RK-1810
PA-18 150 hp. Rib Kit, LH	RK-1811
PA-18 150 hp. Rib Kit, RH	RK-1812
PA-20/22 125-135 hp. Rib Kit, LH	RK-2001
PA-20/22 125-135 hp. Rib Kit, RH	RK-2002
PA-20 115 hp. Rib Kit, LH	RK-2003
PA-20 115 hp. Rib Kit, RH	RK-2004
PA-22 108 hp. Rib Kit, LH	RK-2201
PA-22 108 hp. Rib Kit, RH	RK-2202
PA-22 108 hp. Rib Kit, RH, with Tank Bay	RK-2203
PA-22 150-160 hp. Rib Kit, LH	RK-2204
PA-22 150-160 hp. Rib Kit, RH	RK-2205

PIPER STC's, Conversions & Modifications

Engine Conversions

Installation of Lycoming O-290 D or O-290 D2 in PA-12 or PA-12S

Minimum Required Purchase:

501 Engine Mount, Installation Instructions & STC Approval **PC 155** STC-SA59AL

Installation Kit (excludes engine & oil cooler)

501 Engine Mount, STC and items listed below **PC 155** STC-SA59ALK

Kit consists of:

Engine Baffles:

12424-000	12749-005
12428-004	12425-000
12367-006	12426-000
12427-000	13744-000

Oil Cooler Installation:

AN6264-8-32 Hose	PC 580
AN6264-8-38 Hose	PC 580
(3) AN822-8D Fittings	PC 580
AN823-8D Fitting	PC 580
13725-000 Mounting Bracket	
13720-000 Mounting Bracket	

Exhaust System (PA-18 crossover):

U12457-012Front Stack Assembly	12436-000.....Muffler Shroud
U12457-013.....Rear Stack Assembly	U71261-005.....Shroud Clip
U12433-015.....Muffler	U13717-000..... Oil Cooler Scoop

Installation of Lycoming O-320, -A1A, -A1B, -A2A, -A2B, -A2C, -A3A, -A3B, -A3C, -C2A, -C2B, -C3A, -C3B into PA-12 or PA-14

Minimum Required Purchase:

501 Engine Mount, Installation Instructions & STC Approval **PC 155** STC-SA83AL-501

Installation Kit (excludes engine and oil cooler)

501 Engine Mount, STC and items listed below **PC 155**STC-SA83ALK

Kit consists of:

Engine Baffles:

U14439-000
U14440-000
U14455-000
U14456-000
U14452-000
U14457-000
U14458-000
U14467-000

Tie Rods: (2) U14513-000

(2) 72150	Inner Cylinder Baffle	PC 210
(2) 71610	Hooks	PC 210
(2) 71611	Brackets	PC 210

Oil Cooler Installation:

AN6264-8-32	Hose	PC 580
AN6264-8-38	Hose	PC 580
(3) AN822-8D	Fittings	PC 580
AN823-8D	Fitting	PC 580
13725-000	Mounting Bracket	
13720-000	Mounting Bracket	
U13717-000	Oil Cooler Scoop	

All of the above items are Price Code 150 unless otherwise noted

Aeroquip Hoses for Oil Cooler



For PA-12, PA-14, PA-18, PA-20 and PA-22. Aeroquip hoses for oil cooler to replace steel tubes. Set consists of one 32" long hose and one 38" long hose. Length is overall measurement including end fittings (three 90° elbows and one 45° elbow 3/8-inch pipe). Field approval required.

Part Number **PC 155**AEROQUIP-KT

Muffler Wire Bail



For all Piper models up to and including the PA-22. Prevents loss of power due to failure of muffler flame tubes. Field approval required.

Part Number **PC 150** .. U452-093

Cleveland Wheel and Brake Conversions for Piper STC-SA11RM for Cleveland Wheels and Brakes

J-3, PA-11, PA-12, PA-14, PA-15, PA-16, PA-17, PA-18 and PA-20 Brake Conversion

Cleveland Conversion Kit 199-07100

For use with 1 1/4" axles

Cleveland Wheel and Brake Kit **PC 660**199-07100

Installation of this kit may require:

Lines (2 each)	PC 150 ..	U60703-002
Elbows (2 each)	PC 525	402X4
Elbows (2 each)	PC 525	502X4



STC-SA11RM-1.25

This STC provides for the installation of the popular Cleveland 199-07100 kit on many of the older Pipers using 1 1/4" axles. This kit replaces the original Goodrich (Hayes) wheels and brakes. The 199-07100 kit uses the 6.00 X 6 tire and this STC will allow larger tires up to the 8.00 X 6 to be installed. Request STC-SA11RM-1.25 when you purchase the above kit and it is available at no charge. Not applicable on J-4, and J-5.

Approval only for 1 1/4" axles as used with 199-07100 Kit **PC 150**STC-SA11RM-1.25

Heavy Duty Conversion

Univair also has a version of this STC that will cover the installation of larger 1 1/2" axles so that a "heavy duty" double puck wheel and brake assembly can be installed.

Cleveland Heavy Duty Conversion Kit 199-23100 for use with 1 1/2" straight axles only.



This dual piston brake is designed for superior performance. (Includes 2 each, wheels & brakes)..... **PC 660**199-23100*

This kit may require the purchase of axle spacers for proper installation, depending on application. Axle Spacers sold separately. Must have STC approval.

*For use with 600X6 & 700X6 Tires only.

Approval only for 1 1/2" axles as used with "Heavy Duty" Cleveland Wheels and Brakes **PC 150**STC-SA11RM-1.5
Request STC-SA11RM-1.5 when you purchase the above kit and it is available at no charge.
Not applicable on J-4, and J-5.

All items on this page are Price Code 150 unless otherwise noted

Price and availability subject to change without notice. Univair's Toll Free Sales: 1-888-433-5433

PIPER STC's, Conversions & Modifications

J-3 Continental O-200A (100 hp.) Engine Conversion O-200A Conversion for J-3 with standard length Metal Spar Wings

This conversion, STC-SA7435SW, is for the stock J-3 with metal spars. The installation of the O-200A engine will require an electrical system. Fuel capacity will have to be increased by at least 15 U.S. gallons. Any STC'd auxiliary wing-mounted fuel system for the J-3 will cover this requirement. However, the original 12-gallon fuselage tank will be limited to six usable gallons. Additional information detailing other requirements of this installation is available from UNIVAIR.

Conversion STC-SA7435SW.

STC and Paperwork	STC-SA7435SW
Engine Mount (if UNIVAIR-built mount is not already installed)	U71163-000
McCauley Prop	PC 230 ...DCM6944
Engine Bushing Hardware Kit.....	DK200-1
Battery Box Installation Kit.....	DK200-2
Wing Tank Installation Kit	DK200-3
162-inch Stringer.....	PC 4701232-162

Critical Requirements of Piper J-3 O-200A Installations of STC-SA107RM & STC-SA7435SW

1. The aircraft must have the Univair P/N U71163-000 Engine Mount, if not already installed previously.
2. Fuel capacity must be increased using wing tanks of at least 15 gallons additional capacity. The Piper 18 gallon wing tank specified in the STC or any other STC approved tank system may be used.
3. An electrical system is optional.
4. A wide stringer must be installed along the left side of the fuselage so fabric will clear the fuel selector valve that is part of the fuel system modification. A window stop channel is also installed above the fuel selector valve.
5. Cowling and exhaust stack modifications are required if an electrical system is installed and may be necessary even if the electrical system is omitted.
6. The Continental O-200A Engine must be equipped with a 15 amp generator and a key activated starter if an electrical system is installed. These requirements must be met so that the accessories clear the firewall.
7. Some types of high profile magnetos eligible for use on the O-200A engine may not be suitable for installation on the Piper J-3 aircraft due to interference with the engine top cowl assembly.
8. There is no gross weight increase using STC-SA7435SW. Weight added during conversion reduces useful load and may limit the aircraft's utility.

Tail Repair Sections For:

Our jig-welded 4130 steel repair assemblies includes: tail post, bottom rudder hinges, stabilizer rear brackets, tail spring and brace tube attach fittings, jack screw tower, and top and bottom longeron stub tubes. Kit includes splice tubes, STC and instructions.

J-3, PA-11 & PA-18 STC Approvals

J-3, PA-11 SHORT TAIL REPAIR SECTION PN SA00002DE-02

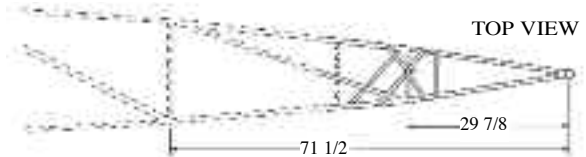

TOP VIEW

J-3, PA-11 LONG TAIL REPAIR SECTION PN SA00002DE-01

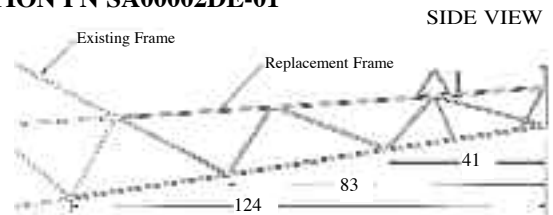
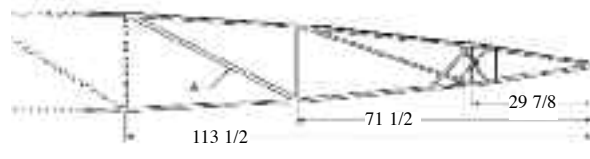

TOP VIEW

PA18 LONG TAIL REPAIR SECTION PN STC-SA4077NM-01

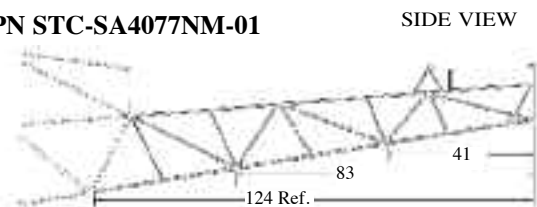
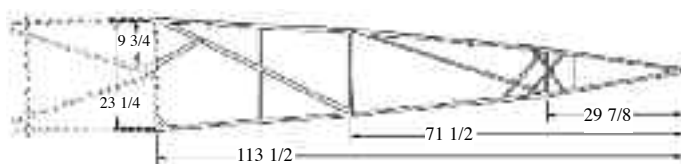

PA-18 Short Tail Repair Section With Jackscrew Tower

PN STC- SA4077NM-02

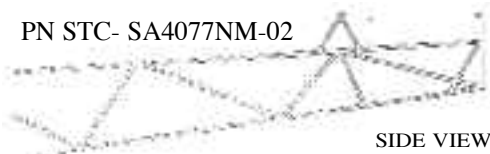

FAA/PMA Approved

PA-18 Short Tail Repair Section Without Jackscrew Tower

PN U12183-TSK



PIPER FUSELAGES

Univair is now Producing

STC Approved Fuselages for Piper J-3, PA-11, & PA-18

Fuselage Standard Features: J3, PA-11, PA-18

- All fuselages are STC approved.
- All fuselages are sandblasted & epoxy primed.
- Upper and lower doors included.
- Heavy duty tailwheel support is internally bushed.
- Longerons are internally oiled and sealed.
- All 4130 tube construction



PA-18 Fuselage Shown

AIRCRAFT

J-3 Cub
 PA-11 Cub Special
 PA-18 Super Cub
 PA-18 Super Cub (same as above but includes tabs for metal belly skins)

PART NO.

R24096-000
R10560-000
J12446-006
J12446-007

Univair PA-18 Standard Alaskan Features

In addition to the above features Univair PA-18 Fuselages **include** the following features STC Approved

1. PA-18 includes inverted "Dog Leg" brace behind baggage compartment
2. Internally sleeved upper longeron under horizontal stabilizer mount
3. Heavy Duty .049" lower longeron in cabin aft to "factory" splice
4. Top Cabin "X" brace
5. Additional Tail Section bracing
6. Extended internal sleeve in lower longeron up to the first longeron brace
7. Addition of small longeron brace tubes in each bay aft of cabin
8. STC Approved Tail Brace wire attachment eliminates AD
9. "X" Braced Tail

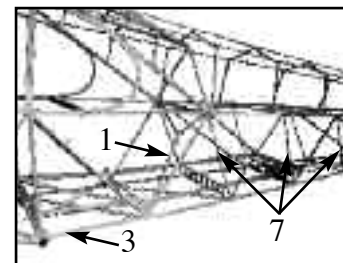
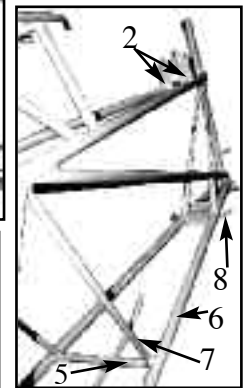
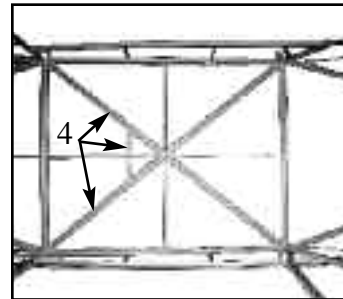

PA-18 Super Cub STC Approved Options and Modifications (Not Sold Separately)

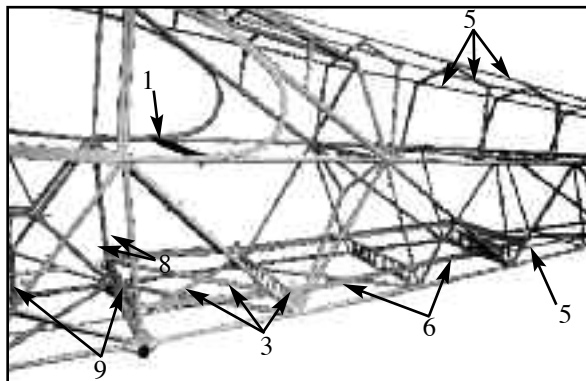

Description

Description	Part No.
1. Removable Rear Seat Cross-Member	F1400-00
2. Shoulder Harness Attach Points (not shown)	F1400-01
3. Reinforced Baggage Floor & Tie Down Points	F1400-02
5. Tubular Keel and Stringers 3/8" welded in	F1400-04
5. Tubular Keel and Stringers 1/2" welded in	F1400-05
6. Extended Cabin Sleeping Compartment Channels & Supports (Structures only approved)	F1400-06
7. Front Seat Belt Attach Points to Fuselage Frame (not shown)	F1400-07
8. Heavy Duty Welded Float Fittings (F.A. Dodge)	F1400-08
9. Rear Seat Cross Tube without Spring Holes	F1400-29
10. Extra Handholds on Longerons	F1400-28
11. Custom Window Frames for L-21	F1400-22
12. Water Rudder Cable Tabs	F1400-24

• Special Order Tabs or modifications i.e. for panels, cargo pods & inspection covers will apply.

Fuselage Crating Charges Extra

PA-18 Modifications STC Approved and can be sold separately

Description	Part No.
Shoulder Harness STC Provides weld on attach points for both front & rear seat.	STC-SA00248DE
"X" Bracing for Cabin STC provides extra strength and protection. STC includes paperwork and weld on X brace.	STC-SA00083DE

All items on this page are Price Code 150 unless otherwise noted

Price and availability subject to change without notice. Univair's Toll Free Sales: 1-888-433-5433

PIPER FUSELAGES

PMA Approved Fuselages for Piper PA-12 Super Cruiser

PA-12 Fuselage Frame and Superstructure P/N U24066-000

General Information: This is built similar to the later version of the Piper print for the PA-12; the main difference is the windshield attach point. This frame is for a square-top windshield. There is also some difference in the doors and door channels. Also, a difference in the rear seat area from earlier '47 models.

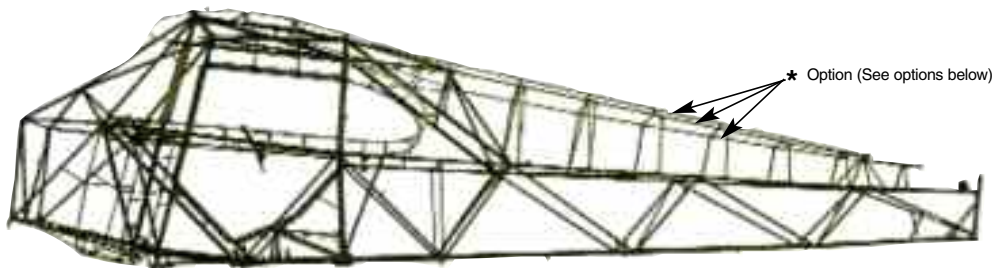

Standard upgrades included in base frame:

- X-brace in Upper cabin
- Heavy Duty Tailspring attach tube
- Heavy Duty Tail-brace wire attach
- All 4130 tube construction (Door not included)
- Rear Baggage Diagonal replaced with inverted Dog Leg



X Brace

Options:

Part Number

- | | | |
|---|----------|-------------------|
| • PA-18 style elevator cable routing | F1401-00 | Separate STC Req. |
| • Cargo attach points | F1401-01 | Field Approval |
| • PA-18 landing gear attach | F1401-02 | Separate STC Req. |
| • Floor mount seat belt attach points | F1401-04 | |
| • Left Hand Tube from wing fitting to Gear Fitting - Seaplane Brace | F1401-06 | |
| • PA-14 Double Wishbone over baggage area | F1401-07 | |
| • F.A. Dodge float fittings & water rudder cable tabs (F.A. Dodge STC Inc.) | F1401-08 | |
| * • Tubular Top Stringers (3) each | F1401-09 | |



Inverted Dog Leg

Service Assemblies:

Part Number

- | | |
|--|-------------|
| • Long Tail Section | DA24056-200 |
| • Short Tail Section (forward of Jack screw tower-aft) | DA24056-201 |
| • Jack Screw Tower | DA24056-202 |
| • Turtle Deck Arches | DA21703-SET |
| • Top Deck | U24066-003 |

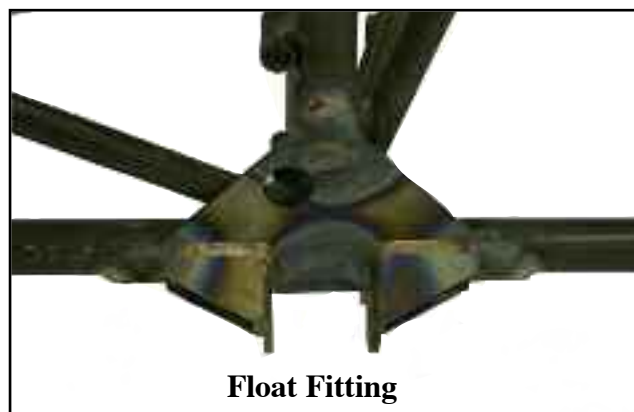

Float Fitting

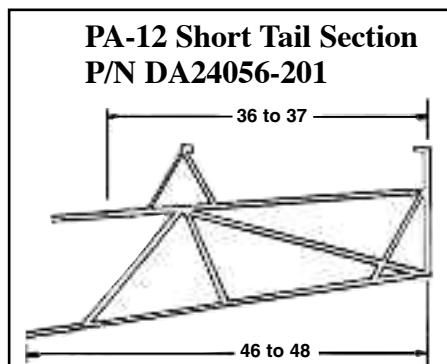

PA-12 Short Tail Section
P/N DA24056-201

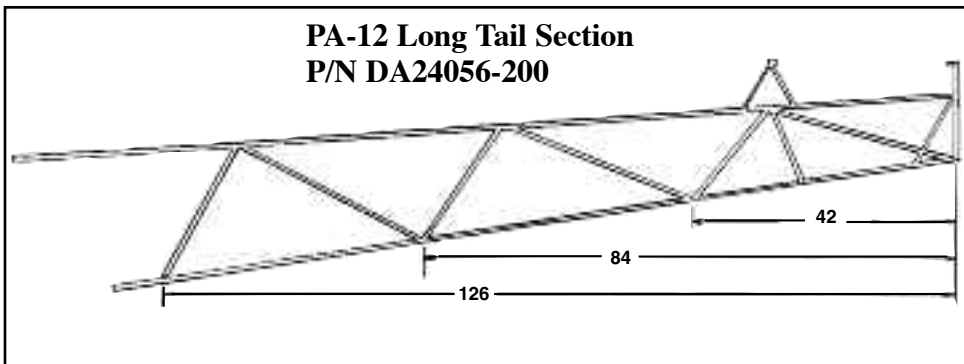

PA-12 Long Tail Section
P/N DA24056-200

PA-22 Instrument Panel Modification

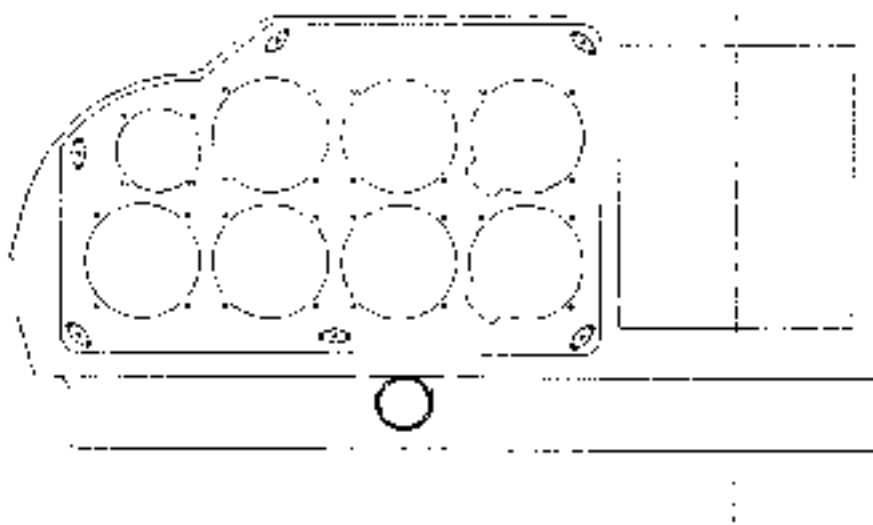

Application

The later model Tripacers and Colts have a full gyro panel, identified by the raised portion on the L/H side. The production instrument panel was designed to accommodate the AN style instruments available at the time the airplanes were produced. Structural tubing behind the panel complicates the installation of deep instruments (such as a DG) low in the panel, hence the odd configurations seen in many airplanes.

Design Features

This modification (STC SA00428SE) upgrades the panel to use modern 3 1/8" instruments. It raises the location of all instruments and allows for the installation of typical DGs in the center of the "T" below the artificial horizon.

The modification has provisions for (7) 3 1/8" instruments and (1) 2 1/4" instrument. The cutouts for the horizon and turn coordinator allow for leveling to correct for any installation misalignment.

In the event the airplane is to be returned to the production configuration, this can be done in a manner which closely matches the original.

The Kit

The kit consists of a panel overlay with cutouts for the instruments. Placards and mounting hardware together with installation instructions and drawings are included.

Installation

The installation requires trimming the existing panel, deburring and touching up the trimmed areas and the installation of nutplates. No structural tubing needs to be cut.

Approval

After installing the modification, a Form 337 must be completed and signed by an A/C confirming that the installation was done per the STC. A record of each aircraft modified will be kept.

The installation of new 3 1/8" instruments is not a part of this STC and will require a separate Form 337.

Kit for PA-22-150/160P/N92WD005100-1

Kit for PA-22-108 ColtP/N92WD005100-501

All items on this page are Price Code 150 unless otherwise noted

Price and availability subject to change without notice. Univair's Toll Free Sales: 1-888-433-5433

PIPER Decal's & Tachometer Cables



PIPER CUB
Special
2, 3

Super Cruiser
4

PIPER
Family Cruiser
5, 6

PIPER CUB
Vagabond
7

TRAINER
8

PIPER
Clipper
9

PIPER
Super Cub
10, 11

PIPER
Pacer
12

PIPER
Super Pacer
13, 14

PIPER
SUPER CUB
15

Super Cub
16

Piper
17

PIPER
18



19

Need Help?
Univair's Sales People are waiting to help.
Toll Free: 1-888-433-5433

Authentic Piper Decal's

1. J-3, J-4, J-5 "Bear Cub" Decal, brown and red/black trim10206-000
2. PA-11 1947-48 "Piper Cub Special" Decal, yellow letters/red trim10749-000-Y/R
3. PA-11 1949 "Piper Cub Special" Decal, brown letters/black trim10749-000-BRN
4. PA-12 "Piper Super Cruiser" Decal, cream letters/red trim10208-000
5. PA-14 1949 "Piper Family Cruiser" Decal, gold letters/black trim12185-000G
6. PA-14 "Piper Family Cruiser" Decal, red letters12185-000R
7. PA-15 "Piper Cub Vagabond" Decal, blue letters11714-000
8. PA-17 "Trainer" Decal, blue letters, used with "Vagabond" Decal11919-000
9. PA-16 "Piper Clipper" Decal, gold and red letters/black trim.....12186-000
10. PA-18 "Piper Super Cub" Decal, gold and yellow letters/black trim ..CS-PA18GBY
11. PA-18 "Piper Super Cub" Decal, gold and red letters/black trimCS-PA18GRB
12. PA-20 "Piper Pacer" Decal, gold letters/black trim.....CS-PA20
- PA-20 "Piper Pacer" Decal, silver letters/black trimCS-PA20S
13. PA-22/20 "Super Pacer" conversions, silver letters/black trimCS-PA22-20
14. PA-22/20 "Super Pacer" conversions, gold letters/black trimCS-PA22-20G
15. Piper Super Cub Decal, "Piper Super Cub", white letters60753-002
16. PA-18 "Super Cub" decal, white letters15098-000
17. PA-18 "Piper" decal, red letters.....22859-000
18. Piper decal (cream letters)456-501
19. Piper Logo Decal; yellow on blackCS12763-000

FAA/ PMA TACHOMETER CABLES FOR PIPER AIRCRAFT



TACHOMETER CABLES FOR PIPER FAA/PMA APPROVED

Part No. For Rotating Tachometers	Part No. For PMA's Applications Non-Rotating Tachometers	Piper Aircraft Listing	Piper Part No.
U1713-R251		PA-18"150", PA-13A"150", PA-185"150", PA-18AS"150", PA-18A (Restricted), PA-18A"150" (Restricted), PA-18A"150" (Restricted)	486-574
U1713-R250		Piper PA-28-235	486-564
U1713-R280		Piper PA-28-235	486-568
U1713-H285		Piper J3C-40, J3C-60, J3C-68S, J3C-65, ARMY L-4, L-4A, L-4B, L-4H, L-4J, NAVY NE-1, NE-2, J3C-65S, J3F-50, J3F-50S, J3F-60, J3F-60S, J3F-65, ARMY L-4C, J3F-65S, J3L, J3L-S, J3L-65, ARMY L-4C, J3L-65S	796-089
U1713-R300		PA-24-250, PA-24-235	486-570
	U1713-N310	Piper J3C-40, J3C-60, J3C-68S, J3C-65, ARMY L-4, L-4A, L-4B, L-4H, L-4J, NAVY NE-1, NE-2, J3C-65S, J3F-50, J3F-50S, J3F-60, J3F-60S, J3F-65, ARMY L-4C, J3F-65S, J3L, J3L-S, J3L-65, ARMY L-4C, J3L-65S	486-580
U1713-R325		Piper J3C-40, J3C-60, J3C-68S, J3C-65, ARMY L-4, L-4A, L-4B, L-4H, L-4J, NAVY NE-1, NE-2, J3C-65S, J3F-50, J3F-50S, J3F-60, J3F-60S, J3F-65, J3F-65S, ARMY L-4C, L-4D, J3L, J3L-S, J3L-65, PA-11, PA-11S, PA-12, PA-12S, PA-14, PA-14S, PA-15, PA-15S, PA-17, PA-17S, ARMY L-16C, PA-18, PA-18"125", PA-18A, PA-18"135", PA-18A"135", PA-18"105", PA-18S, PA-18S, PA-18S"125", PA-18S"135", PA-18AS"125", PA-18AS"135", PA-18S"105"	486-565
U1713-R325		PA-20, PA-20S, PA-20"115", PA-20S"115", PA-20"130", PA-20S"130", PA-22, PA-22"135", PA-22S"135", PA-22"150", PA-22S"150", PA-22"180", PA-22S"180", PA-22"100", PA-22"108", PA-22"140, PA-22"150", PA-20"100", PA-20"180", PA-20S"100, PA-20S"180"	486-570
U1713-R350		Piper J3C-40, J3C-60, J3C-68S, J3C-65, ARMY L-4, L-4A, L-4B, L-4H, L-4J, NAVY NE-1, NE-2, J3C-65S, J3F-50, J3F-50S, J3F-60, J3F-60S, J3F-65, J3F-65S, ARMY L-4C, L-4D, J3L, J3L-S, J3L-65, PA-11, PA-11S, PA-12, PA-12S, PA-14, PA-14S, PA-15, PA-15S, PA-17, PA-17S, ARMY L-16C, PA-18, PA-18"125", PA-18A, PA-18"135", PA-18A"135", PA-18"105", PA-18S, PA-18S, PA-18S"125", PA-18S"135", PA-18AS"125", PA-18AS"135", PA-18S"105"	486-565
U1713-R350		PA-24, PA-24"200", PA-24"200", PA-24"400", PA-24S"100", PA-24S"200"	486-575
U1713-R375		PA-24	486-580
U1713-R425		PA-25	486-582

All items on this page are Price Code 150 unless otherwise noted

Price and availability subject to change without notice. Univair's Toll Free Sales: 1-888-433-5433