

TIRES, WHEELS AND BRAKES



Air Trac Tires

These tires with their shock absorbing nylon carcass and wide tread deliver safe, confident takeoffs and landings.

(formerly McCreary)

All tires are nylon tube-type tires.

Size No.	Ply Rating	Tire Part No.	Tube	Tube Part
2.80/2.50-4	4	280250X4TAT	2.80-4	280X4U
10 x 3.50-4	4	10X350X4TAT	3.50/4.10-4	350410X4U
5.00-5	4	500X5T4AT	5.00-5	500X5U
5.00-5	6	500X5T6AT		
6.00-6	4	600X6T4AT	6.00-6	600X6U
6.00-6	6	600X6T6AT		
6.00-6	8	600X6T8AT		
7.00-6	6	700X6T6AT	7.00/8.00-6	700800X6U
7.00-6	8	700X6T8AT		
8.00-6	4	800X6T4AT		
8.00-6	6	800X6T6AT		
8.50-6	6	850X6T6AT	8.50-6	850X6U
6.50-8	6	650X8T6AT	6.50/7.00-8	650700X8U
6.50-8	8	650X8T8AT		
6.50-10	6	650X10T6AT	6.50-10	650X10U
6.50-10	8	650X10T8AT		
6.50-10	10	650X10T10AT		
7.50-10	6	750X10T6AT	7.50-10	750X10U
8.50-10	6	850X10T6AT	8.50-10	850X10U
8.50-10	8	850X10T8AT		
15 x 6.00-6	4	15X6-6T4AT	15 x 6.00-6	15X600X6U
15 x 6.00-6	6	15X6-6T6AT		

Air Hawk Tires

These are first line quality tires. When it's replacement time, look for the Specialty Tires name. All tires are nylon tube-type tires.

Size	Ply Rating	Tire Part No.	Tube	Tube Part No.
5.00-5	4	500X5T4AH	5.00-5	500X5U
5.00-5	6	500X5T6AH		
6.00-6	4	600X6T4AH	6.00-6	600X6U
6.00-6	6	600X6T6AH		
6.00-6	8	600X6T8AH		
7.00-6	6	700X6T6AH	7.00/8.00-6	700800X6U
7.00-6	8	700X6T8AH		
8.00-6	4	800X6T4AH		
8.00-6	6	800X6T6AH		
8.00-6	8	800X6T8AH		
6.50-8	6	650X8T6AH	6.50/7.00-8	650700X8U
6.50-8	8	650X8T8AH		
6.50-10	6	650X10T6AH	6.50-10	650X10U
6.50-10	8	650X10T8AH		
6.50-10	10	650X10T10AH		
8.50-10	6	850X10T6AH	8.50-10	850X10U
8.50-10	8	850X10T8AH		
18 x 5.5	8	18X5.5T8AH		
22 x 8.0-8	6	22X8-8T6AH		
29 x 11.0-10	10	29X11-10TAH	29 x 11.0-10	29X11-10U

Goodyear Tire



Nylon Tire

8.00 x 4 4-Ply Rib Tread

Used on all Pipers with Goodrich wheels and brakes.

Tire Part Number800X4X4

Tube Part Number800X4

PC 680

Aero Classic Tires

NYLON TUBELESS TIRES		
Size	Ply	Part No.
27" S.C.*	10	AA227
27" Rib	10	AA427
890 X 1250 S.C.*	6	AA313
890 X 1250 Rib	6	AA413
11 00 X 12	10	AA457
NYLON TUBE TYPE TIRES		
Size	Ply	Part No.
380-150-5 (1 1/2 X 500-5)	6	AA44A
420 X 150 (600 X 6.5)	4	AA4AB
7 00 X 8	6	AA4AC
7 00 X 7.5	8	AA4AD
800 X 260	4	AA494
500 X 150	6	AA444
400 X 150	6	AA454
1700 X 16	12	AA47A

* Diamond Tread

— NEW! — The Super Hawk

Designed to handle higher landing speeds and heavier loads, the Super Hawk offers advanced design, and precision craftsmanship. The result is a premium belted aircraft tire that surpasses FAA specifications and matches the performance levels of far more expensive brands. Super Hawk is the proven Value Leader in high performance, general aviation aircraft tires.

Size	Ply Rating	Tire Part No.
5.00-5	6	500X5-6AJ1D4
6.00-6	6	600X6-6AJ1E4

GENERAL 6 X 2.00 TIRE



Solid Rubber Tailwheel Tire

Used on Scott 2000 Tailwheel (3-24B)

Fresh New Tire.....PC 690.....1879

TIRES, WHEELS AND BRAKES

Cleveland Wheels & Brakes — Brake Assembly and Lining Application Chart

Brake Assy.	Lining	Qty.	Brake Assy.	Lining	Qty.	Brake Assy.	Lining	Qty.	Brake Assy.	Lining	Qty.
30-1	66-111	2	30-107	66-90	8	30-127	66-62	4	30-75A	66-105	2
30-2	66-5 shoe	2	30-107A	66-90	8	30-127A	66-62	4	30-75B	66-105	2
30-3	66-5 shoe	2	30-107B	66-90	8	30-127B	66-62	4	30-75X	66-105	2
30-3A	66-5 shoe	2	30-107C	66-90	8	30-127C	66-62	4	30-79	66-105	2
30-4	66-111	2	30-107D	66-90	8	30-129	66-62	4	30-79A	66-105	2
30-5	66-111	2	30-111	66-108	8	30-130	66-108	8	30-79B	66-105	2
30-6	66-111	2	30-113	66-64	8	30-131	66-90	8	30-82	66-44	4
30-7	66-111	2	30-113A	66-64	8	30-132	66-108	8	30-83	66-62	4
30-8	66-106 pp	4	30-119	66-73	8	30-133	66-105	2	30-83A	66-62	4
	66-106 bp	4	30-123	66-68	12	30-136	66-82	2	30-84	66-108	8
30-9	66-106	2	30-126	66-80	8	30-138	66-68	6	30-85	66-111 pp	1
30-9A	66-106	2	30-51	66-106 pp	2	30-139	66-62	8		66-106 bp	1
30-9B	66-106	2		66-106 bp	2	30-141	66-73	8	30-88	66-22	8
30-9C	66-106	2	30-51A	66-106 pp	2	30-142	66-73	8	30-89	66-108	6
30-12	66-106 pp	2		66-106 bp	2	30-143	66-73	8	30-89A	66-108	6
	66-106 bp	2	30-51B	66-106 pp	2	30-144	66-90	8	30-89B	66-108	6
30-13	66-106 pp	2		66-106 bp	2	30-144A	66-90	8	30-91	66-113	12
	66-106 bp	2	30-52	66-105	4	30-144B	66-90	8	30-92	66-68	12
30-18	66-106	2	30-52A	66-105	4	30-145	66-97	6	30-93	66-44	6
30-19	66-106	2	30-52B	66-105	4	30-146	66-91 pp	2	30-93A	66-22	6
30-19A	66-106	2	30-52D	66-105	4		66-92 bp	2	30-93B	66-44	6
30-21	66-106 pp	2	30-52E	66-105	4	30-63E	66-105	2	30-93C	66-97	6
	66-106 bp	2	30-52F	66-105	4	30-63F	66-105	2	30-94	66-108	8
30-23	(66-15 pp) 66-65 pp	1	30-52G	66-105	4	30-63J	66-105	2	30-94A	66-108	8
	(66-19 bp) 66-62 bp	2	30-52H	66-105	4	30-63K	66-105	2	30-95	66-33	8
30-23A	(66-15 pp) 66-65 pp	1	30-52J	66-105	4	30-63M	66-105	2	30-95A	66-66	8
	(66-19 bp) 66-62 bp	2	30-52K	66-105	4	30-63P	66-105	2	30-95B	66-66	8
30-23B	66-65 pp	2	30-52L	66-105	4	30-63Q	66-105	2	30-96	66-62	8
	66-62 bp	2	30-52M	66-105	4	30-65	66-105	4	30-97	66-64	8
30-23C	66-65 pp	2	30-52N	66-105	4	30-65A	66-105	4	30-146A	66-91 pp	2
	66-62 bp	2	30-52P	66-105	4	30-66	66-44	4		66-92 bp	2
30-24	66-106 pp	2	30-52Q	66-105	4	30-66A	66-110	4	30-148	66-113	16
	66-106 bp	2	30-52S	66-105	4	30-66B	66-110	4	30-149	66-66	12
30-28B	66-33	6	30-52T	66-105	4	30-66C	66-22	4	30-150	109-2	30
30-28C	66-33	6	30-52U	66-105	4	30-66D	66-22	4	30-151	66-44	6
30-28D	66-33	6	30-52V	66-105	4	30-66F	66-44	4	30-154	66-50	2
30-30	66-105	2	30-52W	66-105	4	30-66G	66-97	4	30-154A	66-50	2
30-31	66-25 tp	4	30-52X	66-105	4	30-67	66-108	4	30-155	66-33	6
	66-27 cp	4	30-52Y	66-105	4	30-67A	66-108	4	30-156	66-93	6
	66-26 bp	4	30-53	66-112	2	30-67B	66-108	4	30-158	66-68	8
30-32	(66-15 pp) 66-65 pp	1	30-53A	66-112	2	30-67C	66-108	4	30-159	66-90	8
	(66-19 bp) 66-62 bp	2	30-54	66-105	4	30-67D	66-108	4	30-159A	66-90	8
30-32A	66-106 pp	2	30-54A	66-105	4	30-67E	66-108	8	30-162	109-2	10
	66-106 bp	2	30-54B	66-105	4	30-67X	66-108	4	30-163	66-108	8
30-32B	66-106 pp	2	30-54C	66-105	4	30-68	66-33	6	30-164	66-62	2
	66-106 bp	2	30-55	66-105	2	30-68A	66-33	6	30-165	109-1	14
30-32C	66-106 pp	2	30-55B	66-105	2	30-68B	66-33	6	30-170	66-100	8
	66-106 bp	2	30-55D	66-105	2	30-69	66-22	4	30-176	66-108	4
30-32D	66-106 pp	2	30-56	66-105	2	30-69A	66-22	4	30-182	66-108	8
	66-106 bp	2	30-56A	66-105	2	30-69B	66-22	4	30-184	66-108	8
30-34	66-111	2	30-56B	66-105	2	30-72	66-65 pp	4			
30-35	66-106 pp	2	30-56C	66-105	2		66-62 bp	4			
	66-106 bp	2	30-56D	66-105	2	30-74	66-67	4			
30-40	66-106	2	30-56E	66-105	2	30-75	66-105	2			
30-40A	66-106	2	30-58A	66-105	4						
30-41	66-106 pp	2	30-59	66-112	2						
	66-106 bp	2	30-59A	66-112	2						
30-41A	66-106 pp	2	30-59D	66-112	2						
	66-106 bp	2	30-60	66-106 pp	2						
30-41B	66-106 pp	2		66-106 bp	2						
	66-106 bp	2	30-60A	66-106 pp	2						
30-45	66-111	2		66-106 bp	2						
30-98	66-108	12	30-61	66-105	4						
30-98A	66-108	12	30-61A	66-36	4						
30-98B	66-108	12	30-61B	66-36	4						
30-98C	66-108	12	30-61D	66-105	4						
30-98D	66-108	12	30-61E	66-105	4						
30-99	66-66	8	30-61F	66-105	4						
30-99A	66-66	8	30-63	66-105	2						
30-100	66-66	8	30-63A	66-105	2						
30-103	66-113	16	30-63B	66-105	2						
30-104	66-81	4	30-63C	66-105	2						
30-106	66-68	16	30-63D	66-105	2						

pp = pressure plate
 bp = back plate
 tp = torque plate
 cp = carrier plate



FAA/PMA Approved McCauley Lining Applications Aircraft Eligible for Installation of Cleveland Brake Parts

New Cleveland		Aircraft		Series	Old Aircraft
Part No.	Mfg.	Model	Serial No.	or	Mfg. Part No.
66-109 (lining)	Cessna	150 F, G, H, J, K	150-72004 and up		B-30026
66-109	Cessna	150 Aerobat	A-150-0227 and up		B-30026
66-109	Cessna	F150 Aerobat	FA-150-0082 and up		B-30026
66-109	Cessna	172 and Skyhawk	172-60835 and up		B-30026
66-109	Cessna	177, Cardinal, and Cardinal RG	177-02314 and up		B-30026
66-109	Cessna	180	180-52385 and up		B-30026
66-109	Cessna	182 and Skylane	182-55846 and up		B-30026
66-109	Cessna	185	185-02311 and up		B-30026
66-109	Cessna	206, U206, P206, Super Skylane, and Super Skywagon	206-02200 and up		B-30026
66-109	Cessna	210 and Centurion	210-60090 and up		B-30026
105-00700 (rivet)	Cessna	all above	all above		A-30087

All items on this page are Price Code 660 unless otherwise noted

Price and availability subject to change without notice. Univair's Toll Free Sales: 1-888-433-5433

TIRES, WHEELS AND BRAKES

Replacement Brake Linings

Replace worn linings with new, approved linings from Univair. Use these full-size templates to find the correct size lining for your plane.

The conditioning procedures described below for each type of lining will wear off high spots and generate sufficient heat to create a thin layer of glazed material at the lining friction surface. Normal brake usage should generate enough heat to maintain the glaze throughout the life of the lining.

Properly conditioned linings will provide many hours of maintenance-free service. A visual inspection of the brake disc will indicate the lining condition. A smooth surface, one without grooves, indicates that the linings are properly glazed. If the disc is rough (grooved), the linings must be reglazed. The conditioning procedure should be performed whenever the rough disc condition is observed.



Nonasbestos Organic Linings

Conditioning Procedures:

1. Taxi aircraft for 1500 feet with engine at 1700 rpm, applying brake pedal force as needed to develop a 5- to 10-mph taxi speed.
2. Allow the brakes to cool for 10 to 15 minutes.
3. Apply brakes and check for restraint at high static throttle. If brakes hold, conditioning is complete.
4. If brakes cannot hold aircraft during static run-up, allow brakes to completely cool, and repeat steps 1 through 3.

McCauley Brakes (B30)
Part No. 066-10900



(replaces part no. 066-00400)
Part No. 066-11100



(replaces part no. 066-00200 and two of this part will replace part no. 066-00300)
Part No. 066-10600



(replaces part no. 066-03000)
Part No. 066-10500



(replaces part no. 066-07100)
Part No. 066-11200



Metallic Linings

Conditioning Procedures:

1. Perform two consecutive full-stop braking applications from 30 to 35 knots. Do not allow the brake discs to cool substantially between the stops.
2. Allow the brakes to cool for 10 to 15 minutes.
3. Apply brakes and check for restraint at high static throttle. If brakes hold, conditioning is complete.
4. If brakes cannot hold aircraft during static run-up, allow brakes to completely cool, and repeat steps 1 through 3.

(replaces part no. 066-01000)
Part No. 066-06200

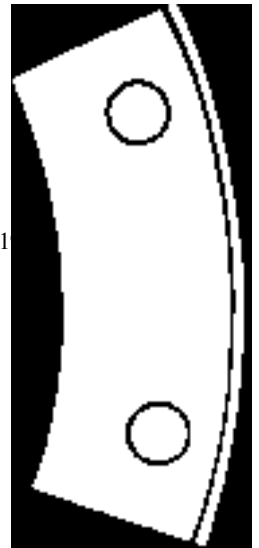

Part No. 066-03300

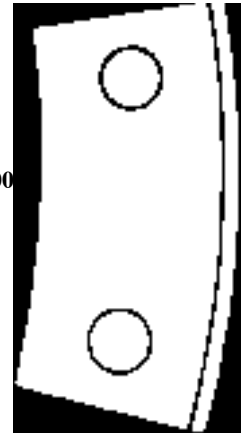

TIRES, WHEELS AND BRAKES

Cleveland

Wheels & Brakes



Conversion Kits

By popular demand, the Cleveland wheel and brake line of conversion kits is constantly being expanded, and it's no secret why: **Cleveland has the reputation for lower operating costs and improved braking performance.**

Cleveland wheels and brakes are easy to install, easy to service, and replacement spare parts are easy on the wallet. Down time to change linings can be measured in minutes.

Cleveland is the world's largest manufacturer of wheels and brakes for general aviation. Our distribution network is strategically located to provide fast, dependable delivery and service anywhere — WORLDWIDE!

* These items are carried as stock items. The others are available on a special-order basis.

Manufacturer	Kit Number	Aircraft Models / Tire Sizes
Aero Commander	199-06801	S2R Thrush (29 x 11.0-10 tires); replaces surplus 27-inch equipment
Aero Commander	199-07400	500, 500A, 500B, 500S, 500U, 560A, 560E, 560F, 680, 680E, 680F
Aero Commander	199-07401	680FP, 720
Aero Commander	199-08000	681, 681B, 685, 690, 690A, 690B
Aero Commander	199-08001	680FL, 680FL(P), 680T, 680V, 680W, 681, 681B, 685
Beech	199-04900	33 (6.00-6 tires)
Beech	199-04900	35, 36 Series (7.00-6 tires)
Beech	199-05000	34, 35, 95, 55 Series (6.50-8 tires)
Beech	199-07300	58P, 58TC, 60, A60, B60 (6.50-8 tires)
Cessna	199-04600*	120, 140, 170, 172, 175, 180, 182 (6.00-6 tires)
Cessna	199-06000	180, 185, 206, 210 (6.00-6 tires)
Cessna	199-06100	190, 195 (6.50-10 tires)
Cessna	199-06200*	180, 185, 206 (8.00-6 tires)
Cessna	199-06400	310, 320 (6.50-10 tires)
Cessna	199-07200	Upgrade existing Cleveland wheels and brakes to heavy duty wheels and brakes — 340, 401, 402, 411, 414 (6.50-10 tires)
Cessna	199-07600	Convert aircraft using Goodyear wheels and brakes to Cleveland — 401, 402, 411, 414, 421 (6.50-10 tires)
Cessna	199-07800	404
DeHavilland	199-07900	DH-CI Chipmunk 21, 22, 22A
Ercoupe	199-06900*	Erco 415 Series, Forney F-1, F-1A (6.00-6 tires)
Ercoupe	199-07100*	415 Series, serial numbers 113 thru 812 (337 approval required, 6.00-6 tires)
Grumman	199-00400	Widgeon G44 and G44A
Grumman	199-06500	Goose G21 and G21A (32 x 8.8 tires)
Navion	199-05200	A thru H (7.00-8 and 6.00-6, main gear and including nose wheel)
Navion	199-05201	A thru H (7.00-8, without nose wheel)
Piper	199-06300	Aztec Series (7.00-6 tires)
Piper	199-06600	Chieftain Series (6.50-10 tires); upgrades aircraft from standard Cleveland equipment to heavy duty equipment
Piper	199-07100*	J3 thru PA-18-150 Cub (6.00-6, 7.00-6, 8.00-6 tires)
Piper	199-07101*	(same as above except for aluminum construction)
Piper	199-08300	Pressurized Navajo PA31-425, Chieftain Series PA31-350; converts aircraft currently using Goodyear wheels and brakes only
Piper STC Approval	199-23100	J-3, PA-11, 12, 14, 16, 18, 20, 22/20 conversion. Used with 1-1/2 inch Axle Gears. required. Sold separately. For use with 6.00 X 6 & 7.00 X 6 tires only.
Stinson	199-08700*	Stinson 108 Series (7.00-6 tires)

All items on this page are Price Code 660 unless otherwise noted

Price and availability subject to change without notice. Univair's Toll Free Sales: 1-888-433-5433

TIRES, WHEELS AND BRAKES

Cleveland Wheels and Brakes Aircraft Directory

For diagrams of brake and wheel assemblies, see the Figure and Page Number in the far right columns of the following directory.

Model	Name/Year	Serial Number	Main Wheel	Disc	Brake Assembly	Lining	Brake		Wheel	
							Figure	Page No.	Figure	Page No.
Aerona, Bellanca, Champion										
7AC to 7EC	Traveller(1)		040-00700*	169-00201*	030-00300*(2)	066-00504* shoe	B-1	16-6	W-4	16-14
7AC to 7EC	Traveller(1)		040-00600*	169-00101*	030-00200*(3)	066-00504* shoe	B-1	16-6	W-4	16-14
7FC and 7HC	Tri-Traveller(1)(4)		040-00600*	169-00101*	030-00200*	066-00504* shoe	B-1	16-6	W-4	16-14
7ECA, 7GCAA, 7GCBC, 7SRS	Citabria(1)	1964 and later	040-02804	164-00500*	030-01901	066-10600*	B-3	16-7	W-5	16-15
7ACA	Champ(1)	1971	040-02804	164-01700	030-00900	066-10600*	B-2	16-7	W-2	16-13
8GCBC	Scout(1)		040-04700(3)	164-01100	030-03202	066-10600(2)(PP), 066-10600(BP)	B-9	16-10	W-15	16-20
8KCAB	Decathlon(1)	1 and up	040-02804	164-00500*	030-01901	066-10600*	B-3	16-7	W-5	16-15
(1) formerly Champion aircraft (2) mechanical; check aircraft (3) uses 8.50-6 tires (4) only tri-gear made										
Alon Originally equipped with 040-01600 wheels and 030-00400 brakes. See Mooney M-10, below.										
Cessna 199-04600* Conversion Kit for:										
120, 140, 170, 180, 182 with 6.00-6 tires			040-09701	164-02601	030-06301	066-10500*	B-5	16-8	W-13	16-19
150A, 150B	1961-1962	59119 thru 59700	040-01200(1)	164-00400	030-00900(1)	066-10600*	B-2	16-7	W-2	16-13
150C	1963	59701 thru 60087	040-01900(1)	164-00400	030-00900	066-10600*	B-2	16-7	W-1	16-13
			040-05700(2)	164-00500*	030-04000(2)	066-10600*	B-3	16-7	W-7	16-16
150D, 150E	1964-1965	60088 thru 61532	040-07800(1)	164-01700	030-00900	066-10600*	B-2	16-7	W-2	16-13
			040-07900(2)	164-01600	030-04000	066-10600*	B-3	16-7	W-9	16-17
150F, 150G, 150H, 150J	1966	61533 and up	040-09700(2)	164-02601	030-06300*(3)(4)	066-10500*	B-5	16-8	W-13	16-19
			040-09701*	164-02601	030-06302(4)	066-10500*	B-5	16-8	W-13	16-19
(1) 5.00-5 (2) optional 6.00-6 (3) to serial number 150-67198 (4) Use 030-06301 when reordering.										
150K	to 1970	71129 thru 72003	040-09701*	164-02601	030-06302(1)	066-10500*	B-5	16-8	W-13	16-19
A150K	Aerobat 1970	1 thru 226	040-09701*	164-02601	030-06302(1)	066-10500*	B-5	16-8	W-13	16-19
A150 Series	Aerobat	227 and up	040-11300	164-04000	030-07500	066-10500*	B-6	16-9	W-14	16-19
F150 Series	Commuter/Reims	530 and up	040-11300	164-04000	030-07500	066-10500*	B-6	16-9	W-14	16-19
FA150 Series	Aerobat/Reims	1 and up	040-11300	164-04000	030-07500	066-10500*	B-6	16-9	W-14	16-19
(1) Use 030-06301 when reordering.										
Cessna 199-06200* Conversion Kit for:										
180, 185, 206			040-07504*	164-03600	030-05200	066-10500*	B-11	16-11	W-8	16-16
Cessna 199-06100 Conversion Kit for:										
190, 195, 195A			040-04001	164-00800	030-02803	066-10500*	B-13	16-12	W-17	16-21
Ercoupe-Forney 199-06900* Conversion Kit for: (two SK-58 Hose Kits may be required)										
415-C, -CD, -D, -E, -G, F1 Forney 813 and up		040-04100	164-00300	030-03000	066-10500*		B-4	16-8	W-10	16-17
Ercoupe 199-07100* Conversion Kit for:										
415 (field approval required)		113 thru 812	040-06000	164-06700	030-06000	066-10600*	B-10	16-11	W-12	16-18
Luscombe (mechanical drum type)										
			040-00700*	169-00201*	030-00300*	066-00504*	B-1	16-6	W-4	16-14
Mooney M-10 Cadet 690001 and up 040-09700(1) 164-02601 030-06300*(2) 066-10500*										
(1) Mooney installed a few 040-01600, 040-07600 and 040-09602 wheels; aircraft serial numbers unknown. (2) Use 030-06301 when re-ordering.										
Navion										
199-05200 Conversion Kit (includes nosewheel)	A thru H		040-09804	164-02701	030-06602	066-03900*	B-12	16-12	W-16	16-20
199-05201 Conversion Kit (excludes nosewheel)	A thru H		040-09804	164-02701	030-06602	066-03900*	B-12	16-12	W-16	16-20
Piper 199-07100** Conversion Kit for:										
J-3 thru PA-20	199-07100	Conversion Kit	040-06000	164-06700	030-06000	066-10600*	B-10	16-11	W-12	16-18
PA-18-150	Super Cub	7609137 and up	040-06000	164-06700	030-06000	066-10600(2)*(PP)	B-10	16-11	W-12	16-18
PA-18A-150	Super Cub	7609137 and up	040-06000	164-06700	030-06000	066-10600*(BP)	B-10	16-11	W-12	16-18
**This kit will require two U60703-002 lines, two 502x4 elbows, and two 402x4 fittings. FAA 337 approval will be required for installation, or STC SA11RM-1.25 which must be purchased separately— may be used for the approval. J-5 requires field approval. Note STC is included if kit is purchased from Univair. (1) drum brake (2) 169-00101 is the replacement drum assembly order number.										
Piper 199-23100										
J-3 thru PA-22 with 1-1/2" axles	STC Approved Conversion	Various	040-08400*	164-01900*	030-04102*(1)	066-10600(2)*(PP), 066-10600*(BP)	B-10	16-11	W-9	16-17
Various Univair STC's allow the installation of this kit. Axle spacers will be required for proper installation. STC's and spacers sold separately. Contact Univair for details.										
(1) Use 075-02900 Torque Plate.										
PA-22	Tri-Pacer	all models	040-00600*	169-00101*(2)	030-00200*(1)	066-00504* shoe	B-1	16-6	W-4	16-14
PA-22-108	Colt	all models	040-02800*	164-00500*	030-01800*	066-10600*	B-3	16-7	W-5	16-15
PA-22 Series	Tri-Pacer/Colt	Univair STC Conversion	040-02800*	164-01900*	030-01800*	066-10600*	B-3	16-7	W-5	16-15
					030-0412	066-10600(2)*	B-10	16-11		
PA-24-180, 250	Commanche	1 thru 3295	040-00500(3)	159-00100(1)	030-01200	066-10600(2)*(PP), 066-10600*(BP)	B-7	16-9	W-3	16-14
PA-24-180, 250, 260	Commanche	3296 and up			030-04100(2)	066-10600(2)*(PP), 066-10600*(BP)	B-10	16-11		
PA-24-180, 250	Commanche	3307 and up	040-05800	164-00900	030-04100(2)(5)	066-10600(2)*(PP), 066-10600*(BP)	B-10	16-11	W-6	16-15
PA-24-260	Commanche	3307 and up	040-08400*	164-01900*	030-04100(2)(5)	066-10600(2)*(PP), 066-10600*(BP)	B-10	16-11	W-9	16-17
PA-24-400	Commanche	130 and up	040-09000	164-02201	030-02300(2)	066-06500*(PP), 066-06200*(BP)	B-8	16-10	W-11	16-18
(1) Order 159-00104, which includes rivets. (2) Use 075-02900 torque plate assembly. (3) to serial number 3306 (4) Use 040-07603 for aircraft manufactured after mid-1971. (5) Use 030-04102 when reordering.										
PA-25	Pawnee C	1 thru 1999	040-00500	159-00100(2)					W-3	16-14
PA-25	Pawnee C	2000 thru 4171	040-06100	164-01300					W-7	16-16
PA-25	Pawnee C	4172 and up	040-08401*	164-03300					W-9	16-17
PA-25	Pawnee C	1 thru 2136			030-01200(1)	066-10600(2)*(PP), 066-10600*(BP)	B-7	16-9		
PA-25	Pawnee C	2137 and up			030-04100(1)(3)	066-10600(2)*(PP), 066-10600*(BP)	B-10	16-11		
PA-25	Pawnee C	starting in 1977			030-04102*(1)	066-10600(2)*(PP), 066-10600*(BP)	B-10	16-11		
(1) Use 075-02400 torque plate assembly. (2) Order 159-00104, which includes rivets. (3) Use 030-04102 when re-ordering.										
Univair Aircraft 199-08700*(5) Conversion Kit for:										
Stinson 108	199-08700*(5)	Conversion Kit	040-09704(3)	164-02601	030-06315(3)	066-10500*	B-5	16-8	W-13	16-19
Stinson 108	drum and shoe type		040-00600*(2)	169-00101*(4)	030-00200	066-00504* shoe	B-1	16-6	W-4	16-14
Stinson 108	Univair STC'd type		040-02800*(2)	164-00500*	030-01800*	066-10600*	B-3	16-7	W-5	16-15
(1) shoe type brakes (2) 7.00-6 tires (3) May be used to retrofit earlier models. (4) brake drum (5) approved under Stinson type certificate										

* These items are carried as stock items; the others are available on a special-order basis.

If you require a part not shown in the above listing, please call 1-303-375-8882 or write for price and availability.

TIRES, WHEELS AND BRAKES



6.00-6 Hydraulic and Mechanical Drum Type Brake Assemblies

B-1



Hydraulic

Mechanical

Hydraulic Assembly.....Part Number 030-00200

Fig.	Part No.	Description	Qty. per Assy.
	075-01100	Torque Plate Assembly	1
1	065-00600	Plate—Torque	1
2	097-00102	Brake Adjuster Eccentric Assembly	1
	096-00102	Eccentric—Brake Adjuster	1
	085-00100	Bolt—Eccentric	1
	095-00100	Washer	1
3	094-00100	Nut	1
4	094-02700	Nut—Jam	1
5	095-15600	Washer—Lock	1
6	097-00101	Brake Adjuster Eccentric Assembly	1
	096-00101	Eccentric—Brake Adjuster	1
	085-00100	Bolt—Eccentric	1
	095-00100	Washer	1
	094-00100	Nut	1
	094-02700	Nut—Jam	1
	095-15600	Washer—Lock	1
7	172-00102	Shoe Assembly	1
	139-04702	Shoe Sub Assembly	1
	066-00504	Lining	1
8	145-00200	Bushing	1
	105-00300	Rivet	6
9	172-00101	Shoe Assembly	1
	139-04701	Shoe Sub Assembly	1
	066-00504	Lining	1
	145-00200	Bushing	1
	105-00300	Rivet	6
10	091-00300	Cylinder Assembly	1
11	167-00100	Tube Assembly	1
	099-00100	Nipple	1
	098-00100	Anchor Plate	1
12	092-00100	Piston Assembly	2
	062-00200	Piston—Brake	2
	089-00100	Plate—Wear	2
13	MS28775-211	O-ring	2
14	AN6227-5	O-ring	1
15	082-00300	Spring	1
16	093-00100	Plate—Anchor Bolt	3
17	AN5-15A	Bolt	2
18	AN365-524	Nut	2
19	095-15700	Washer—Lock	1
20	094-03700	Nut—Jam	1
21	087-00100	Bleeder Assembly	1
22	077-00100	Body—Bleeder	1
23	079-00100	Screw—Bleeder	1
24	MS28775-008	O-ring	1

PC 590

PC 590

Mechanical Assembly.....Part Number 030-00300

Fig.	Part No.	Description	Qty. per Assy
1	065-00800	Plate—Torque	1
2	172-00202	Shoe Assembly	1
	139-04602	Shoe Sub Assembly	1
	066-00504	Lining	1
	145-00300	Bushing	1
	105-00300	Rivet	6
	089-00200	Plate—Wear	1
3	172-00201	Shoe Assembly	1
	139-04601	Shoe Sub Assembly	1
	066-00504	Lining	1
4	145-00300	Bushing	1
	105-00300	Rivet	6
	089-00200	Plate—Wear	1
5	174-00100	Pulley—Bracket Assembly	1
6	179-00100	Pulley Cable	1
7	173-00100	Bracket Pulley	1
8	145-00400	Bushing	1
9	145-00500	Bushing	1
10	AN3-7A	Bolt	1
11	AN365-1032	Nut	1
12	AN4-23A	Bolt	1
13	AN4-15A	Bolt	1
14	AN960-416	Washer	3
15	AN365-428	Nut	2
16	093-00200	Plate—Anchor Bolt	2
17	181-00100	Cam Assembly	1
	175-00100	Cam—Brake	1
	177-00100	Pin—Brake	1
	178-00100	Lever—Cam	1
18	176-00200	Clip—Washer	1
19	176-00100	Clip—Washer	1
20	AN3-5A	Bolt	1
21	AN365-1032	Nut	1
22	082-00300	Spring	1
23	082-00400	Spring	1
24	AN526-1024-8	Screw	1
25	095-00200	Washer	1
26	145-00600	Bushing	1

All AN Part Numbers are PC 580

All items on this page are Price Code 660 unless otherwise noted

Price and availability subject to change without notice. Univair's Toll Free Sales: 1-888-433-5433

TIRES, WHEELS AND BRAKES

Cleveland
Wheels & Brakes

B-2

**5-inch and 6-inch
Brake Assembly
— Single Cylinder
— Single Piston
— Organic Lining**



AssemblyPart Number **030-00900**

Fig.	Part No.	Description	Qty. per Assy.
	091-00702	Cylinder Assembly	1
1	061-00601	Cylinder	1
	092-00200	Piston Assembly	1
2	062-00300	Piston	1
3	AN6227-23	O-ring	1
4	069-00400	Bolt Anchor	2
5	AN364-428	Nut	2
6	AN960-416	Washer	2
7	NAS1149F0432	Washer	2
		PC 595	
8	079-00300	Screw—Bleeder	1
9	081-00100	Seat—Bleeder	1

Fig.	Part No.	Description	Qty. per Assy.
10	183-00100	Cap	1
11	073-00300	Pressure Plate Assembly	1
12	063-00500	Pressure Plate	1
13	066-10600	Lining (066-00200)	1
14	105-00200	Rivet	3
	074-00200	Back Plate Assembly	1
15	064-00500	Back Plate	1
	066-10600	Lining (066-00200)	1
	105-00200	Rivet	3
16	075-00800	Torque Plate Assembly	1
17	AN4H15A	Bolt	2

All AN part numbers are PC 580

Cleveland
Wheels & Brakes

B-3

**6-inch Brake Assemblies
— Single Cylinder
— Single Piston
— Organic Lining**



Assembly Numbers: **030-04000**Qty. per Assy.

Fig.	Part No.	Description	Qty. per Assy.
	091-00701	Cylinder Assembly	1
	091-00702	Cylinder Assembly	1
1	061-00601	Cylinder	1
	092-00200	Piston Assembly	1
2	062-00300	Piston	1
3	AN6227-23	O-ring	1
4	069-00400	Anchor Bolt	2
5	AN364-428	Nut	2
6	AN960-416	Washer	2
7	NAS1149F0432P	Washer	2
		PC 595	
8	079-00300	Screw—Bleeder	1
9	081-00100	Seat—Bleeder	1
10	183-00100	Cap	1
11	AN822-4D	Tube Fitting	1

Assembly Numbers: **030-04000**Qty. per Assy.

Fig.	Part No.	Description	Qty. per Assy.
11	MS20823-4D	Tube Fitting	1
	073-00300	Pressure Plate Assembly	1
12	063-00500	Pressure Plate	1
13	066-10600	Lining	1
14	105-00200	Rivet	3
	074-00200	Back Plate Assembly	1
15	064-00500	Back Plate	1
	066-10600	Lining	1
	105-00200	Rivet	3
16	AN4H15A	Bolt	2
	103-11500	Bolt	2
17	075-01600	Torque Plate Assembly	1
	075-04900	Torque Plate Assembly	1
	075-02500	Torque Plate Assembly	1

All AN part numbers are PC 580

TIRES, WHEELS AND BRAKES

Cleveland
Wheels & Brakes

6-inch Brake Assembly
— Single Cylinder
— Single Piston
— Organic Lining

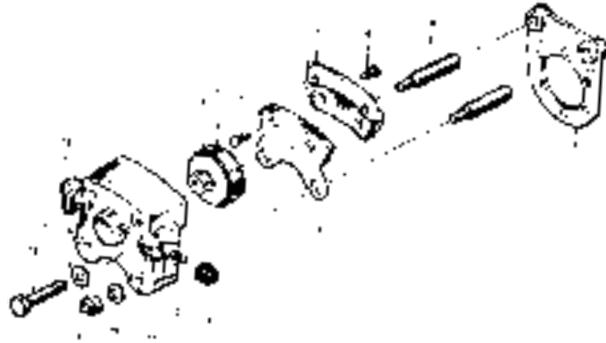

B-4

AssemblyPart Number 030-03000

Fig.	Part No.	Description	Qty. per Assy.
	091-08400	Cylinder Assembly	1
1	061-01900	Cylinder	1
	092-01700	Piston Assembly	1
2	062-01600	Piston	1
3	MS28775-224	O-ring	PC 590 1
	073-03600	Pressure Plate Assembly	1
4	063-01200	Pressure Plate	1
5	066-10500	Lining	1
6	105-00200	Rivet	2
	074-02900	Back Plate Assembly	1
7	064-01500	Back Plate	1
	066-10600	Lining	1

Fig.	Part No.	Description	Qty. per Assy.
	105-00200	Rivet	2
8	069-00400	Anchor Bolt	2
9	AN365-428	Nut	8
10	NAS1149F0432P	Washer	PC 595 4
10A	AN960-416	Washer	6
11	081-00100	Seat—Bleeder	1
12	079-00300	Screw—Bleeder	1
13	183-00100	Cap—Bleeder	1
15	MS20823-49	Tube Fitting	PC 590 1
16	103-11600	Bolt	2
17	075-12100	Torque Plate Assembly	1
	103-61100	Socket Head Screw	6

All AN part numbers are PC 580

Cleveland
Wheels & Brakes

6-inch Brake Assemblies
— Single Cylinder
— Single Piston
— Organic Lining



B-5

Assembly Numbers: 030-06315 Qty. per Assy.

Fig.	Part No.	Description	Qty. per Assy.
	030-06301		
	091-02200	Cylinder Assembly	1
	091-03900	Cylinder Assembly	1
	091-12200	Cylinder Assembly	1
1	061-01900	Cylinder	1
	092-01700	Piston Assembly	1
2	062-01600	Piston	1
3	MS28775-224	O-ring	PC 590 1
	073-01100	Pressure Plate Assembly	1
4	063-01200	Pressure Plate	1
5	066-10500	Lining	1
6	105-00200	Rivet	2
	074-01000	Back Plate Assembly	1

Assembly Numbers: 030-06315 Qty. per Assy.

Fig.	Part No.	Description	Qty. per Assy.
	030-06301		
7	064-01500	Back Plate	1
	066-03000	Lining	1
	105-00200	Rivet	2
8	069-00400	Anchor Bolt	2
9	AN365-428	Nut	2
10	NAS1149F0432P	Washer	PC 595 4
11	081-00100	Seat—Bleeder	1
12	079-00300	Screw—Bleeder	1
13	183-00100	Cap—Bleeder	1
14	AN822-4D	Tube Fitting	1
15	103-11600	Lock Bolt	2
16	075-03700	Torque Plate Assembly	1
	075-07700	Torque Plate Assembly	1

All AN part numbers are PC 580

All items on this page are Price Code 660 unless otherwise noted

Price and availability subject to change without notice. Univair's Toll Free Sales: 1-888-433-5433

TIRES, WHEELS AND BRAKES

Cleveland
Wheels & Brakes

B-6

6-inch Brake Assembly
— Single Cylinder
— Single Piston
— Organic Lining

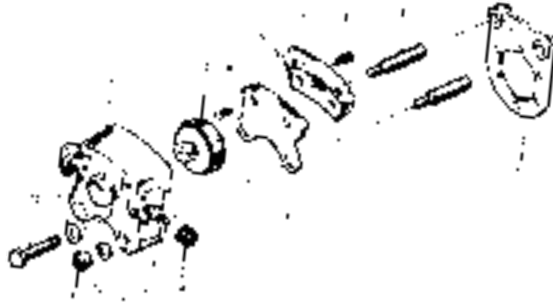

AssemblyPart Number 030-07500

Fig.	Part No.	Description	Qty. per Assy.
	091-04400	Cylinder Assembly	1
1	061-03700	Cylinder	1
	092-01700	Piston Assembly	1
2	062-01600	Piston	1
3	MS28775-224	O-ring	1
	073-01100	Pressure Plate Assembly	1
4	063-01200	Pressure Plate	1
5	066-03000	Lining	1
6	105-00200	Rivet	2
	074-01000	Back Plate Assembly	1
7	064-01500	Back Plate	1

Fig.	Part No.	Description	Qty. per Assy.
	066-10500	Lining	1
	105-00200	Rivet	2
8	069-00400	Anchor Bolt	2
9	AN365-428	Nut	2
10	NAS1149F0432P	Washer	2
11	AN960-416	Washer	2
12	081-00100	Seat—Bleeder	1
13	079-00300	Screw—Bleeder	1
14	183-00100	Cap—Bleeder	1
15	103-11700	Lock Bolt	2
17	075-03700	Torque Plate Assembly	1

All AN part numbers are PC 580

Cleveland
Wheels & Brakes

B-7

6-inch Brake Assembly
— Single Cylinder
— Dual Piston
— Organic Lining

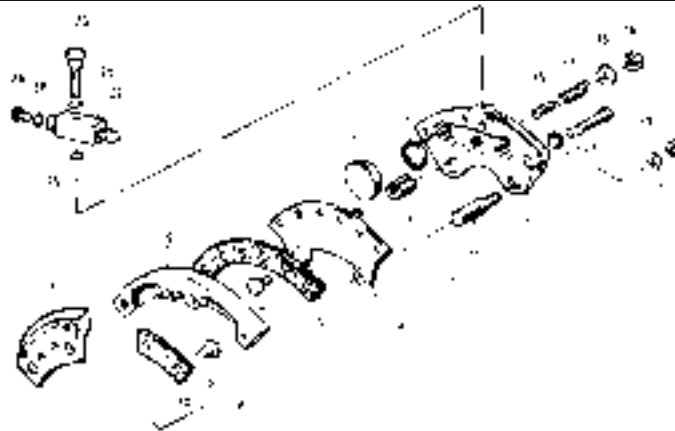

AssemblyPart Number 030-01200

Fig.	Part No.	Description	Qty. per Assy.
	091-00400	Cylinder Assembly	1
1	061-00300	Cylinder	1
	092-00200	Piston Assembly	2
2	AN6227-23	O-ring	2
3	062-00300	Piston	2
4	073-00200	Pressure Plate Assembly	1
5	066-10600	Lining	2
6	105-00200	Rivet	6
7	184-00100	Plate Assembly	1
8	074-00200	Back Plate Assembly	2
9	064-00500	Back Plate	2
10	066-10600	Lining	2
	105-00200	Rivet	6
11	069-00200	Anchor Bolt	2
12	AN364-624	Nut	2

Fig.	Part No.	Description	Qty. per Assy.
13	AN960-616L	Washer	2
14	071-00100	Retract Cylinder	1
15	067-00400	Spacer	1
16	095-00200	Washer	1
17	082-00500	Spring	1
18	AN364-1032	Nut	1
19	068-00800	Shim	1
20	AN4H15A	Bolt	4
21	NAS1149F0432P	Washer	4
	087-00200	Bleeder Body Assembly	1
22	077-00200	Body—Bleeder	1
23	079-00200	Screw—Bleeder	1
24	079-00100	Screw—Bleeder	1
25	AN6227-6	O-ring	2
26	AN6227-3	O-ring	1

All AN part numbers are PC 580

TIRES, WHEELS AND BRAKES



B-8

6-inch Brake Assembly
 — Single Cylinder
 — Dual Piston
 — Metallic Lining

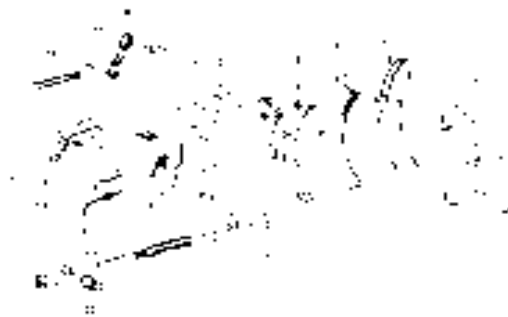

Assembly.....Part Number 030-02303

<i>Fig.</i>	<i>Part No.</i>	<i>Description</i>	<i>Qty. per Assy.</i>
	091-01300	Cylinder Assembly	1
1061-06500	Cylinder	1
	092-00800	Piston Assembly	2
2062-00700	Piston	2
3088-00100	Insulator	2
4MS28775-222	O-ring	PC 590 2
5063-00600	Pressure Plate Assembly	1
6066-06500	Lining	1
7074-00600	Back Plate Assembly	2
8066-06200	Lining	2
9069-00200	Anchor Bolt	2
10AN364-624	Nut	2

<i>Fig.</i>	<i>Part No.</i>	<i>Description</i>	<i>Qty. per Assy.</i>
11AN960-616L	Washer	2
12068-01100	Back Plate Shim	1
13068-01200	Back Plate Shim	1
14AN4H16A	Bolt	4
15NAS1149F0432P	Washer	PC 595 4
16081-00200	Seat—Bleeder	1
17079-00300	Screw—Bleeder	1
18183-00100	Cap—Bleeder	1
19AN6227-7	O-ring	2
20AN815-4D	Tube Fitting	1
21075-02400	Torque Plate Assembly	1

All AN part numbers are PC 580



B-9

6-inch Brake Assembly
 — Single Cylinder
 — Dual Piston
 — Organic Lining



Assembly.....Part Number 030-03202

<i>Fig.</i>	<i>Part No.</i>	<i>Description</i>	<i>Qty. per Assy.</i>
	091-01701	Cylinder Assembly	1
1061-01200	Cylinder	1
	092-00900	Piston Assembly	2
2062-00800	Piston	2
3088-00200	Insulator	2
4AN6227-23	O-ring	2
5073-00400	Pressure Plate Assembly	1
6063-00600	Pressure Plate	1
7066-10600	Lining	2
8105-00200	Rivet	6
9074-00200	Back Plate Assembly	2
10064-00500	Back Plate	2
11066-10600	Lining	2

<i>Fig.</i>	<i>Part No.</i>	<i>Description</i>	<i>Qty. per Assy.</i>
	105-00200	Rivet	6
12069-00200	Anchor Bolt	2
13AN364-624	Nut	2
14AN960-616L	Washer	2
15068-01100	Back Plate Shim	1
16068-01200	Back Plate Shim	1
17103-12000	Bolt	4
18NAS1149F0432P	Washer	PC 595 4
19AN6227-7	O-ring	1
20081-00200	Seat—Bleeder	1
21079-00300	Screw—Bleeder	1
22183-00100	Cap—Bleeder	1
23075-02101	Torque Plate Assembly	1

All AN part numbers are PC 580

All items on this page are Price Code 660 unless otherwise noted

Price and availability subject to change without notice. Univair's Toll Free Sales: 1-888-433-5433

TIRES, WHEELS AND BRAKES



B-10

6-inch Brake Assembly
 — Single Cylinder
 — Dual Piston
 — Organic Lining



Assembly Numbers: 030-06001		<i>Qty. per Assy.</i>
030-04102*		
<i>Fig.</i>	<i>Part No.</i>	<i>Description</i>
	091-01600	Cylinder Assembly
	091-08800	Cylinder Assembly
	091-08900	Cylinder Assembly
	091-08901	Cylinder Assembly
	091-09600	Cylinder Assembly
1	061-00700	Cylinder
	061-06600	Cylinder
	061-06700	Cylinder
	061-06701	Cylinder
	092-00200	Piston Assembly
2	062-00300	Piston
	062-00600	Piston
3	MS28775-222	O-ring PC 590
	AN6227-27	O-ring
4	069-00200	Anchor Bolt
5	AN364-624	Nut
6	AN960-616L	Washer
7	073-00400	Pressure Plate Assembly

Assembly Numbers: 030-06001		<i>Qty. per Assy.</i>
030-04102*		
<i>Fig.</i>	<i>Part No.</i>	<i>Description</i>
	073-04100	Pressure Plate Assembly
8	063-00600	Pressure Plate
9	066-10600	Lining
	066-10600	Lining
10	105-00200	Rivet
11A	068-00800	Shim
12	074-00200	Back Plate Assembly
	074-02700	Back Plate Assembly
13	064-00500	Back Plate
14	066-00200	Lining
	066-05600	Lining
	105-00200	Rivet
15	AN4H15A	Bolt
16	NAS1149F0432P	Washer PC 595
17	081-00100	Seat—Bleeder
18	079-00300	Screw—Bleeder
19	183-00100	Cap—Bleeder
20	AN816-4D	Tube Fitting
21	075-12500	Torque Plate Assembly

* 030-04102 supercedes 030-04000.
All AN part numbers are PC 580



B-11

6-inch Brake Assembly
 — Single Cylinder
 — Dual Piston
 — Organic Lining

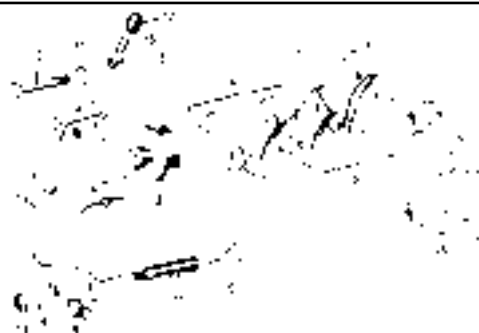

Assembly		Part Number 030-05200
<i>Fig.</i>	<i>Part No.</i>	<i>Description</i>
	091-02100	Cylinder Assembly
1	061-01800	Cylinder
	092-01600	Piston Assembly
2	062-01500	Piston
3	MS28775-222	O-ring PC 590
4	073-01000	Pressure Plate Assembly
5	063-01100	Pressure Plate
6	066-10500	Lining
7	105-00200	Rivet
8	074-01000	Back Plate Assembly
9	064-01500	Back Plate

<i>Fig.</i>	<i>Part No.</i>	<i>Description</i>	<i>Qty. per Assy.</i>
	066-10500	Lining	2
	105-00200	Rivet	4
10	103-11800	Bolt	4
11	AN960-416	Washer	4
12	069-00400	Anchor Bolt	2
13	AN365-428	Nut	2
14	NAS1149F0432P	Washer PC 595	2
15	081-00100	Seat—Bleeder	1
16	079-00300	Screw—Bleeder	1
17	183-00100	Cap—Bleeder	1
20	075-01500	Torque Plate Assembly	1

All AN part numbers are PC 580

TIRES, WHEELS AND BRAKES

Cleveland
Wheels & Brakes

B-12

- 8-inch Brake Assembly**
 — Single Cylinder
 — Dual Piston
 — Organic Lining



AssemblyPart Number 030-06602

Fig.	Part No.	Description	Qty. per Assy.
	091-03500	Cylinder Assembly	1
1	061-02200	Cylinder	1
	092-01600	Piston Assembly	2
2	062-01500	Piston	2
3	MS28775-222	O-ring	2
4	073-02100	Pressure Plate Assembly	1
5	063-01400	Pressure Plate	1
6	066-03900	Lining	2
7	105-00200	Rivet	4
8	074-01700	Back Plate Assembly	2
9	064-01700	Back Plate	2
	066-03900	Lining	2
	105-00200	Rivet	4

Fig.	Part No.	Description	Qty. per Assy.
10	068-02500	Back Plate Shim	1
11	069-00400	Anchor Bolt	2
12	AN365-428	Nut	2
	094-90500	Nut	1
13	103-11800	Bolt	4
14	NAS1149F0432P	Washer	2
15	AN960-416	Washer	4
16	081-00200	Seat—Bleeder	1
17	079-00300	Screw—Bleeder	1
18	183-00100	Cap—Bleeder	1
19	AN6227-7	O-ring	2
20	AN833-4D	Tube Fitting	1
21	075-09800	Torque Plate Assembly	1

All AN part numbers are PC 580

Cleveland
Wheels & Brakes

B-13

- 10-inch Brake Assembly**
 — Single Caliper
 — Three Piston
 — Metallic Lining



AssemblyPart Number 030-02803

Fig.	Part No.	Description	Qty. per Assy.
	091-01003	Cylinder Assembly	1
1	061-02600	Cylinder	1
	092-00800	Piston Assembly	3
2	062-00700	Piston	3
3	MS28775-222	O-ring	3
4	088-00100	Insulator	3
5	073-00500	Pressure Plate Assembly	1
6	074-00500	Back Plate Assembly	3
7	066-03300	Lining	6
8	068-01600	Back Plate Shim	1

Fig.	Part No.	Description	Qty. per Assy.
10	103-12000	Bolt	6
11	NAS1149F0432P	Washer	8
12	069-00400	Anchor Bolt	2
13	AN365-428	Nut	2
14	081-00200	Seat—Bleeder	1
15	079-00300	Screw—Bleeder	1
16	183-00100	Cap—Bleeder	1
17	AN6227-7	O-ring	2
	AN815-4D	Tube Fitting	1
18	075-08900	Torque Plate Assembly	1

All AN part numbers are PC 580

All items on this page are Price Code 660 unless otherwise noted

Price and availability subject to change without notice. Univair's Toll Free Sales: 1-888-433-5433

TIRES, WHEELS AND BRAKES



W-1



5.00-5 Main Wheel Assembly — Tube Type Tire

Assembly	Part Number 040-01900
Fig. Part No.	Description Qty. per Assy.
1161-01500	Inner Wheel Half.....1
208231 PC 570	Bearing Cup
3162-01400	Outer Wheel Half.....1
208231 PC 570	Bearing Cup
4164-00400	Brake Disc Assembly.....1
5AN4-31A	Bolt
6AN960-416	Washer.....6
7AN365-428	Nut.....3

Fig. Part No.	Description Qty. per Assy.
8153-00800	Grease Seal Ring.....2
9155-00200	Snap Ring.....2
10154-00600	Grease Seal Felt.....1
11158-00500	Hub Cap.....1
1208125	Bearing Cone PC 5702
13AN526-1024-8	Slotted Truss Head Screw.....1
14MS35333-39	Lock Washer PC 5901
15157-00500	Dust Shield.....1

All AN part numbers are PC 580



W-2

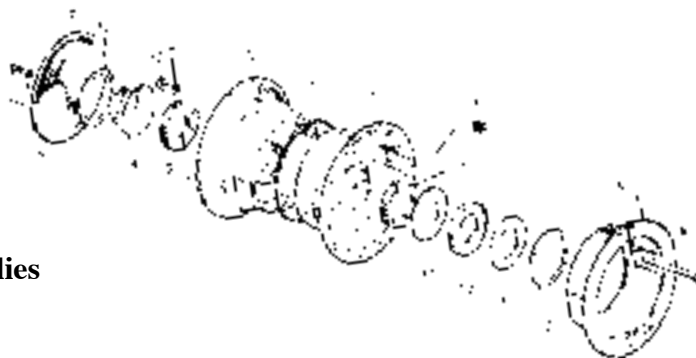

5.00-5 Main Wheel Assemblies

	Assembly Numbers: 040-07802**	Qty. per Assy.
	040-07800**	
	040-01200*	
Fig. Part No.	Description	
1161-00500	Inner Wheel Half Assembly.....1	
	161-03100	Inner Wheel Half Assembly.....1.1
208231 PC 570	Cup Bearing.....1	1.1
3162-00500	Outer Wheel Half Assembly.....1	
	162-02800	Outer Wheel Half Assembly.....1.1
208231 PC 570	Cup Bearing.....1	1.1
4217-00100	Grommet	1.1
5AN6230-22	O-ring.....1	
6164-00400	Brake Disc Assembly.....1	
	164-01700	Brake Disc Assembly.....1.1
708125 PC 570	Bearing Cone.....2	2.2

	Assembly Numbers: 040-07802**	Qty. per Assy.
	040-07800**	
	040-01200*	
Fig. Part No.	Description	
8AN4-31A	Bolt.....3	
	AN4-22A	Bolt.....3.3
9AN960-416	Washer.....6	3.3
10AN365-428	Nut.....3	3.3
11153-00800	Grease Seal Ring.....2	4.4
12155-00200	Snap Ring.....2	2.2
13154-00600	Grease Seal Felt.....1	2.2
14158-00500	Hub Cap.....1	
15AN526-1024-8	Screw.....1	
16MS35333-39	Lock Washer PC 5901	
17157-00500	Dust Shield.....1	

* Use tubeless tires. ** Use tube type tires.

All AN part numbers are PC 580

TIRES, WHEELS AND BRAKES



W-3

**6.00-6
Main Wheel Assembly
— Tube Type Tire**

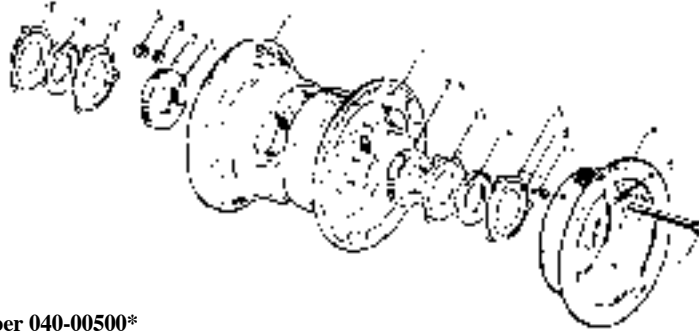

AssemblyPart Number 040-00500*

Fig.	Part No.	Description	Qty. per Assy.
1	162-00600	Outer Wheel Half Assembly	1
2	13836	PC 570 Bearing Cup	1
3	161-00900	Inner Wheel Half Assembly	1
4	159-00204*	Brake Disc	1
5	105-00100	Rivet	8
2	13836	PC 570 Bearing Cup	1
6	13889	PC 570 Bearing Cone	2

Fig.	Part No.	Description	Qty. per Assy.
7	AN4-36A	Bolt	3
8	AN960-416	Washer	6
9	AN365-428	Nut	3
14	154-00400	Grease Seal Felt	2
16	153-00500	Grease Seal Ring	4
17	MS35265-45	Screw	PC 590 6
18	MS35333-35	Lock Washer	PC 590 6

* Brake Discs are sold only as 159-00204, 159-00104 with rivets.

All AN part numbers are PC 580



W-4

**6.00-6
Main Wheel Assembly
— Tube Type Tire**

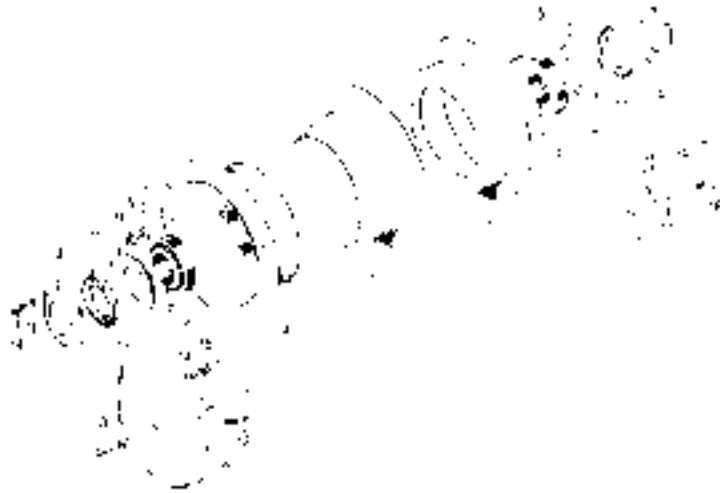

Fig.	Part No.	Description	Qty. per Assy.	
			3050 mechanical	3040 hydraulic
1	161-00600	Inner Wheel Half	1	
	161-00700	Inner Wheel Half	1	1
2	13836	PC 570 Bearing Cup	1	1
3	169-00101	Brake Drum Assembly	1	
	169-00201	Brake Drum Assembly	1	1
4	162-00600	Outer Wheel Half Assembly	1	1
2	13836	PC 570 Bearing Cup	1	1
5	AN4-36A	Bolt	3	3
6	AN365-428	Nut	3	3
7	AN960-416	Washer	3	3
8	157-00200	Dust Shield	1	1
9	153-00500	Grease Seal Ring	2	

Fig.	Part No.	Description	Qty. per Assy.	
			3050*** mechanical	3040** hydraulic
10	153-00300	Grease Seal Ring	1	
	154-00400	Grease Seal Felt	1	
11	154-00500	Grease Seal Felt	1	
12	158-01000	Hub Cap	1	
	158-00200	Hub Cap	1	1
13	MS35265-45	Screw		PC 590 1
14	MS35333-39	Screw	6	3
15	MS35333-38	Washer Lock	1	1
16	095-15100	Washer Lock	6	3
17	13889	Cone Bearing		PC 570 2
18	067-00300	Inner Shield Spacer		1

All AN part numbers are PC 580

All items on this page are Price Code 660 unless otherwise noted

Price and availability subject to change without notice. Univair's Toll Free Sales: 1-888-433-5433

TIRES, WHEELS AND BRAKES



W-5

6.00-6 Main Wheel Assemblies — Tube Type Tire

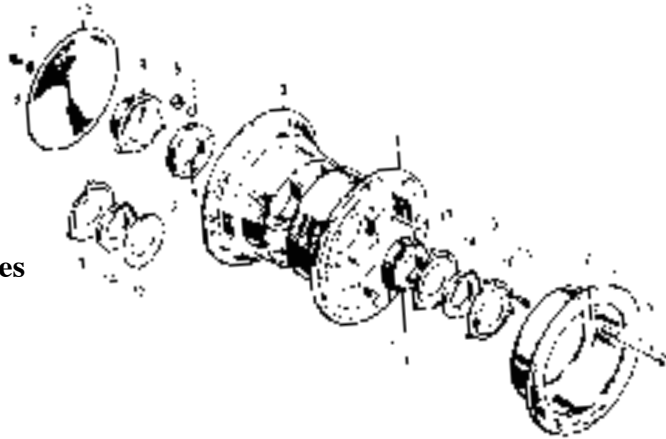

<i>Fig.</i>	<i>Part No.</i>	<i>Description</i>	<i>Qty. per Assy.</i>
Assembly Numbers: 040-02804			
040-02800			
1	161-01600	Inner Wheel Half Assembly	1
2	13836	PC 570 Bearing Cup	1
3	162-00600	Outer Wheel Half Assembly	1
2	13836	PC 570 Bearing Cup	1
4	13889	PC 570 Cone Bearing	2
5	164-00500	Brake Disc Assembly	1
6	AN4-36A	Bolt	3
7	AN960-416	Washer	3
8	AN365-428	Nut	3

<i>Fig.</i>	<i>Part No.</i>	<i>Description</i>	<i>Qty. per Assy.</i>
Assembly Numbers: 040-02804			
040-02800			
9	158-01000	Hub Cap	1
10	157-00200	Dust Shield	1
13	153-00500	Grease Seal Ring	2
14	154-00500	Grease Seal Felt	2
	154-00400	Grease Seal Felt	1
15	MS35265-45	Screw	6
16	MS35333-38	Lock Washer	6
17	MS35333-39	Lock Washer	1
18	AN526-1024-8	Screw	1

All AN part numbers are PC 580



W-6

6.00-6 Main Wheel Assembly — Tube Type Tire

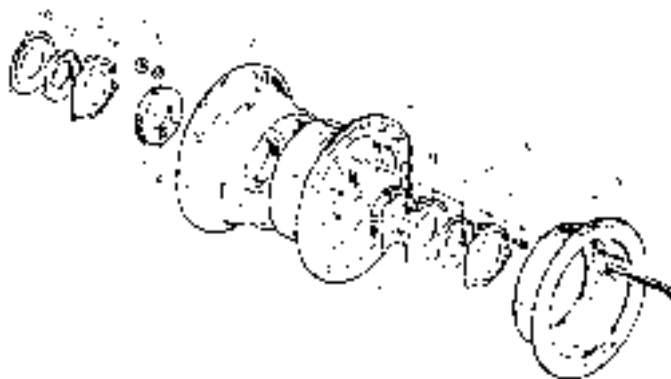

<i>Fig.</i>	<i>Part No.</i>	<i>Description</i>	<i>Qty. per Assy.</i>
W-6 Assembly.....Part Number 040-05800			
1	161-01600	Inner Wheel Half Assembly	1
2	13836	PC 570 Bearing Cup	1
3	162-00600	Outer Wheel Half Assembly	1
2	13836	PC 570 Bearing Cup	1
4	164-00900	Brake Disc Assembly	1
5	AN4-36A	Bolt	3
6	AN960-416	Washer	3

<i>Fig.</i>	<i>Part No.</i>	<i>Description</i>	<i>Qty. per Assy.</i>
7	AN365-428	Nut	3
8	13889	PC 570 Bearing Cone	2
10	153-00500	Grease Seal Ring	4
12	154-00400	Grease Seal Felt	2
15	MS35265-45	Screw	6
16	MS35333-38	Lock Washer	6

All AN part numbers are PC 580

TIRES, WHEELS AND BRAKES



W-7

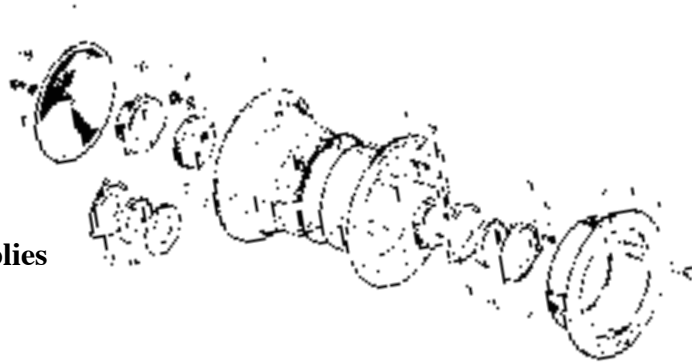

**6.00-6
Main Wheel Assemblies
— Tube Type Tire**

		Qty. per Assy.
Assembly Numbers: 040-06100		↓
040-05700		
Fig.	Part No.	Description
1	161-02500	Inner Wheel Half Assembly
	161-01600	Inner Wheel Half Assembly
2	13836	PC 570 Bearing Cup
3	162-01000	Outer Wheel Half Assembly
	162-00600	Outer Wheel Half Assembly
2	13836	PC 570 Bearing Cup
4	164-00500	Brake Disc Assembly
	164-01300	Brake Disc Assembly
5	AN4-40A	Bolt
	AN4-36A	Bolt
6	AN960-416	Washer
7	AN365-428	Nut

		Qty. per Assy.
Assembly Numbers: 040-06100		↓
040-05700		
Fig.	Part No.	Description
9	13889	Bearing Cone PC 570
10	158-01000	Hub Cap
11	157-00300	Dust Shield
	157-00200	Dust Shield
12	156-00100	Grease Seal Plate
13	153-00500	Grease Seal Ring
15	154-00400	Grease Seal Felt
16	MS35265-45	Screw PC 590
17	AN526-1024-8	Screw
18	MS35333-38	Lock Washer PC 590
19	MS35333-39	Lock Washer

All AN part numbers are PC 580



W-8

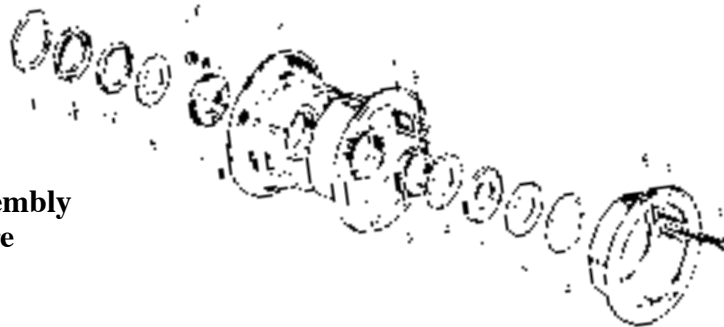

**6.00-6
Main Wheel Assembly
— Tube Type Tire**

		Part Number 040-07504
Fig.	Part No.	Description
1	161-03000	Inner Wheel Half Assembly
2	13836	PC 570 Bearing Cup
3	162-02700	Outer Wheel Half Assembly
2	13836	PC 570 Bearing Cup
4	164-03601	Brake Disc Assembly
5	AN5-35A	Bolt
6	AN960-516	Washer
7	AN365-524	Nut

Fig.	Part No.	Description	Qty. per Assy.
8	13889	PC 570 Bearing Cone	2
9	153-00400	Grease Seal Ring	2
	153-00300	Grease Seal Ring	1
10	153-01500	Grease Seal Ring	1
11	154-00300	Grease Seal Felt	1
12	154-01300	Grease Seal Felt	1
13	155-00100	Snap Ring	2

All AN part numbers are PC 580

All items on this page are Price Code 660 unless otherwise noted

Price and availability subject to change without notice. Univair's Toll Free Sales: 1-888-433-5433

TIRES, WHEELS AND BRAKES



W-9



**6.00-6
Main Wheel Assemblies
— Tube Type Tire**

<i>Fig. Part No.</i>	<i>Description</i>	<i>Qty. per Assy.</i>		
Assembly Numbers: 040-08401 040-08400 040-07900				
1	161-03000 Inner Wheel Half Assembly	1	1	1
2	13836 PC 570 Bearing Cup	1	1	1
3	162-02700 Outer Wheel Half Assembly	1	1	1
2	13836 PC 570 Bearing Cup	1	1	1
4	164-01600 Brake Disc Assembly	1		
	164-01900 Brake Disc Assembly	1		
	164-03300 Brake Disc Assembly	1		
5	AN5-35A Bolt	3	3	3
6	AN960-516 Washer	3	3	3

<i>Fig. Part No.</i>	<i>Description</i>	<i>Qty. per Assy.</i>		
Assembly Numbers: 040-08401 040-08400 040-07900				
7	AN365-524 Nut	3	3	3
8	13889 PC 570 Bearing Cone	2	2	2
9	153-00400 Grease Seal Ring	2	2	4
	153-00300 Grease Seal Ring	1		1
10	153-01500 Grease Seal Ring	1		1
11	154-00300 Grease Seal Felt	1	1	2
12	154-01300 Grease Seal Felt	1		1
13	155-00100 Snap Ring	2	2	2

All AN part numbers are PC 580



W-10

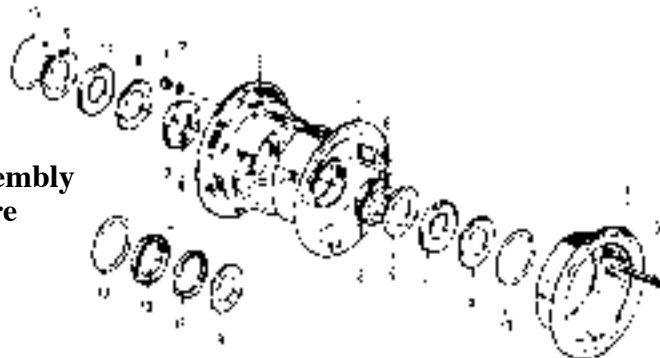

**6.00-6
Main Wheel Assembly
— Tube Type Tire**

<i>Fig. Part No.</i>	<i>Description</i>	<i>Qty. per Assy.</i>		
AssemblyPart Number 040-04100				
1	161-03000 Inner Wheel Half Assembly	1		
2	13836 PC 570 Bearing Cup	1		
3	162-02700 Outer Wheel Half Assembly	1		
2	13836 PC 570 Bearing Cup	1		
4	164-00300 Brake Disc Assembly	1		
5	AN5-35A Bolt	3		
6	AN960-516 Washer	3		
7	AN365-524 Nut	3		
8	13889 PC 570 Bearing Cone	2		
9	153-00300 Grease Seal Ring	1		

<i>Fig. Part No.</i>	<i>Description</i>	<i>Qty. per Assy.</i>		
	153-00900 Grease Seal Ring	2		
10	153-01500 Grease Seal Ring	1		
11	154-00800 Grease Seal Felt	1		
12	154-01300 Grease Seal Felt	1		
13	155-00100 Snap Ring	2		
	067-03800 Axle Spacer	1		
	157-00900 Dust Shield	1		
	MS35333-38 Washer	3		
	102-00600* Screw	3		

All AN part numbers are PC 580

TIRES, WHEELS AND BRAKES



W-11

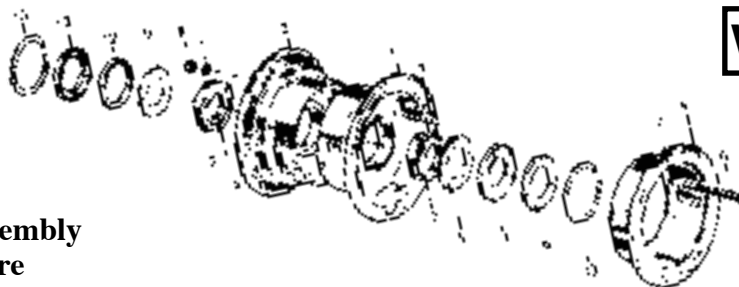

**6.00-6
Main Wheel Assembly
— Tube Type Tire**

AssemblyPart Number **040-09000**

<i>Fig. Part No.</i>	<i>Description</i>	<i>Qty. per Assy.</i>
1161-03000	Inner Wheel Half Assembly	1
213836	PC 570 Bearing Cup	1
3162-02700	Outer Wheel Half Assembly	1
213836	PC 570 Bearing Cup	1
4164-02201	Brake Disc Assembly	1
513889	PC 570 Bearing Cone	2
6AN5-36A	Bolt	3
7AN960-516	Washer	9

<i>Fig. Part No.</i>	<i>Description</i>	<i>Qty. per Assy.</i>
8AN365-524	Nut	3
9153-00400	Grease Seal Ring	2
.....153-00300	Grease Seal Ring	1
10153-01500	Grease Seal Ring	1
11154-00300	Grease Seal Felt	1
12154-01300	Grease Seal Felt	1
13155-00100	Snap Ring	2

All AN part numbers are PC 580



W-12



**6.00-6
Main Wheel Assemblies
— Tube Type Tire**

Assembly Numbers: **040-06001** *Qty. per Assy.*
040-06000

<i>Fig. Part No.</i>	<i>Description</i>	<i>Qty. per Assy.</i>
1161-07000	Inner Wheel Half Assembly	1
.....161-07001	Inner Wheel Half Assembly	1
208231	PC 570 Bearing Cup	1
3162-06500	Outer Wheel Half Assembly	1
.....162-06501	Outer Wheel Half Assembly	1
208231	PC 570 Bearing Cup	1
4AN4-36A	Bolt	6
5NAS1149F0432P	Washer	PC 595 6

Assembly Numbers: **040-06001** *Qty. per Assy.*
040-06000

<i>Fig. Part No.</i>	<i>Description</i>	<i>Qty. per Assy.</i>
.....AN960-416	Washer	6
6AN365-428	Nut	6
708125	PC 570 Bearing Cone	2
8153-00200	Grease Seal Ring	4
10154-00200	Grease Seal Felt	1
.....154-02800	Grease Seal Felt	1
12155-00200	Snap Ring	2
13164-06700	Brake Disc Assembly	1

All AN part numbers are PC 580

All items on this page are Price Code 660 unless otherwise noted

Price and availability subject to change without notice. Univair's Toll Free Sales: 1-888-433-5433

TIRES, WHEELS AND BRAKES



W-15

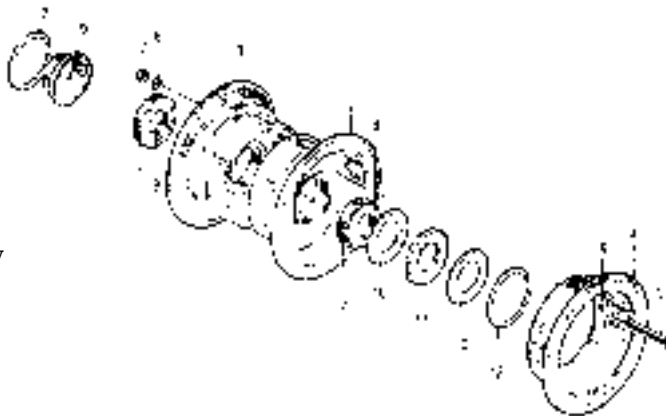

**8.50-6
Main Wheel Assembly
— Tube Type Tire**

AssemblyPart Number **040-04700**

<i>Fig.</i>	<i>Part No.</i>	<i>Description</i>	<i>Qty. per Assy.</i>
1	161-02200	Inner Wheel Half Assembly	1
2	13836	PC 570 Bearing Cup	1
3	162-02000	Outer Wheel Half Assembly	1
2	13836	PC 570 Bearing Cup	1
4	164-01100	Brake Disc Assembly	1
5	AN5-50	Bolt	6
6	AN960-516	Washer	12

<i>Fig.</i>	<i>Part No.</i>	<i>Description</i>	<i>Qty. per Assy.</i>
7	AN365-524	Nut	6
8	13889	PC 570 Bearing Cone	2
9	158-00300	Hub Cap	1
10	153-00400	Grease Seal Ring	2
11	154-00300	Grease Seal Felt	1
12	155-00100	Snap Ring	2

All AN part numbers are PC 580



W-16

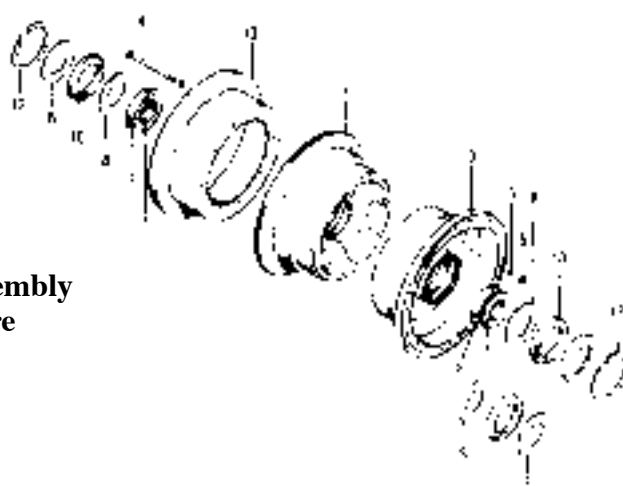

**7.00-8
Main Wheel Assembly
— Tube Type Tire**

AssemblyPart Number **040-09804**

<i>Fig.</i>	<i>Part No.</i>	<i>Description</i>	<i>Qty. per Assy.</i>
1	161-02300	Inner Wheel Half Assembly	1
2	13836	PC 570 Bearing Cup	1
3	162-04800	Outer Wheel Half Assembly	1
	13836	Bearing Cup	1
4	AN5-35A	PC 570 Bolt	6
5	AN960-516	Washer	6

<i>Fig.</i>	<i>Part No.</i>	<i>Description</i>	<i>Qty. per Assy.</i>
6	AN365-524	Nut	6
7	13889	PC 570 Bearing Cone	2
8	153-01600	Grease Seal Ring	4
10	154-00300	Grease Seal Felt	1
12	155-00100	Snap Ring	2
13	164-02701	Brake Disc Assembly	1

All AN part numbers are PC 580

All items on this page are Price Code 660 unless otherwise noted

Price and availability subject to change without notice. Univair's Toll Free Sales: 1-888-433-5433

TIRES, WHEELS AND BRAKES

Cleveland
Wheels & Brakes

W-17

**6.50-10
Main Wheel Assembly
— Tube Type Tire**



W-17 AssemblyPart Number 040-04001

Fig.	Part No.	Description	Qty. per Assy.
1161-01901Inner Wheel Half Assembly1
2214-01300Bearing Cup1
3162-01700Outer Wheel Half Assembly1
4214-00900Bearing Cup1
5067-00600Spacer1
6164-00800Brake Disc Assembly1
7AN4-32A	PC 580 Bolt9
8AN960-416	PC 580 Washer9

Fig.	Part No.	Description	Qty. per Assy.
9AN365-428	PC 580 Nut9
10153-00900Grease Seal Ring2
11154-00800Grease Seal Felt1
12155-00100Snap Ring1
13155-00600Snap Ring1
14214-01400Bearing Cone1
15214-01000Bearing Cone1
16158-00800Hub Cap1

PC 660

B.F. Goodrich
(formerly Hayes)

8.00 x 4 Main Wheel Assembly for Pipers with 1-1/4-inch axles and Ercoupes (serial numbers 1 thru 812)

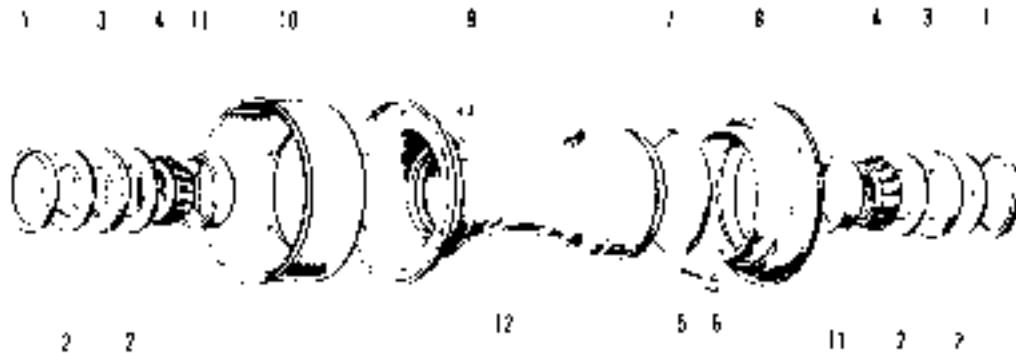

New Wheel AssemblyPart Number D3-13A-1

Fig.	Part No.	Description	Qty. per Assy.
1A85-218Lock Ring2
2A56-4Felt Retainer4
3B227-52Felt (E50024-48)2
408125	PC 570 Cone Bearing2
5AN380-2-2	PC 580 Cotter Pin1
6A20-54Pin1

Fig.	Part No.	Description	Qty. per Assy.
7A85-118Lock Ring1
8B11-5Side Rim1
9AN441-6-6P	PC 580 Rivet6
10B13-4**Brake Drum1
1108231*	PC 570 Bearing Cup2
12UD10-12Wheel Base, New1

* Do not remove unless damaged.
** I.D. must be turned out after installation.

PC 670

TIRES, WHEELS AND BRAKES



(formerly Hayes)

8.00 x 4 Brake Assembly for Pipers with 1-1/4-inch axles and Ercoupes, serial numbers 1 thru 812)

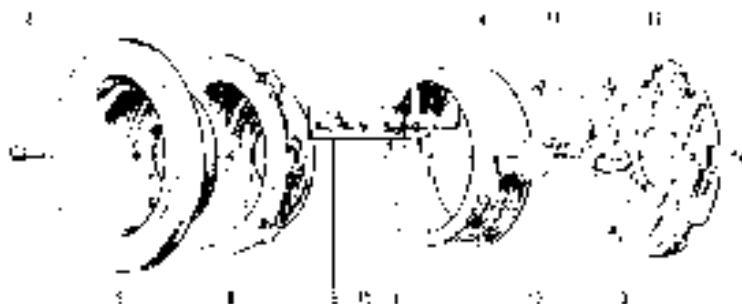

Brake Assembly.....Part Number D2-113

Fig.	Part No.	Description	Qty. per Assy.
1	A63-159***	Nut.....	1
6	B57-239*	Bleeder Valve Assembly**	1
7	AN365-1032	PC 580 Nut.....	6
8	AN501-10-6	PC 580 Screw.....	6
9	B51-72	Fairing.....	1
10	B21-35	Retracting Spring.....	6

Fig.	Part No.	Description	Qty. per Assy.
11	B27-59-1	Brake Block, New.....	6
12	A72-30	Shield.....	6
13	D15-25	Brake Frame.....	1
14	B22-43S***	Expander Tube Assembly, Surplus.....	1
15	A64-3	Packing.....	1
18	D12-101	Brake Frame.....	1

* Optional equipment not supplied unless specified on order.

** Includes nut and washer.

***No Longer Available.

B.F. Goodrich Replacement Brake Parts

Aircraft	Description	Qty. Required	Part No.
Bellanca Cruisair (D2-250 Brake Assembly)	Shield.....	6	A72-29
	Spring Clip.....	6	B21-116
Bellanca Cruisair (D2-524 Brake Assembly)	Shield.....	6	A72-29
	Spring Clip.....	6	B21-116
Navion	Shield.....	7	A72-29
Piper PA-23 Apache	Block.....	6	B27-300
	Spring Clip.....	6	B21-169

Grove 800 x 4 Disk Brake Conversion

(Goodrich wheels and brakes only)

New FAA/PMA Approved Disc Brake Conversion

- Maintain your classic look
- Use your existing wheels, tires and tubes
- Use your existing master cylinder and brake lines
- Easy Installation - all parts & special tools included



Grove Brake Conversion..... **PC 150**76000

Note: Kits requiring FAA 8130-3 Forms must be special ordered from the factory. There is a \$150.00 charge for this documentation.

All items on this page are Price Code 670 unless otherwise noted

Price and availability subject to change without notice. Univair's Toll Free Sales: 1-888-433-5433

TIRES, WHEELS AND BRAKES



Brake Assembly Number: 9520093

Brake 6.00-6

— used with low flanged wheel

Type: lock ring retained cylinder head brake

Used On: Stinson 108 Series with 150/165 Franklin engines (serial numbers 131 thru 3994)

Assembly Part Number9520093* (order #9521239)

<i>Fig. Part No.</i>	<i>Description Qty. per Assy.</i>	<i>Fig. Part No.</i>	<i>Description Qty. per Assy.</i>
19531714*Brake Disc.....1	9511970M*Piston.....1
29511265*Anvil Lining.....1	10AN6227-29 PC 580O-ring Packing.....1
39511264*Piston Lining.....1	119520448*Inlet Plug.....1
4954659Screw.....1	12MS28778-4 PC 590Preformed Packing.....2
5511846-4*Bleeder Washer.....1	13530913*Brake Housing.....1
6MS16625-1200*Retaining Ring.....1	14955383Dot Fastener.....4
7511971M*Cylinder Head.....1	159523482Disc Clip.....4
8MS28775-224 PC 590O-ring Packing.....1	161604-73*Inlet Plug.....1

* No longer available



Brake Assembly Number: 9520285

Brake 6.00-6

Type: lock ring retained cylinder head brake

Used On: Ercoupe, Forney Aircoupe

Assembly Part Number9520285*

<i>Fig. Part No.</i>	<i>Description Qty. per Assy.</i>	<i>Fig. Part No.</i>	<i>Description Qty. per Assy.</i>
19530294*Brake Disc.....1	9511970M*Piston.....1
29511276*Anvil and Piston Lining.....1	10AN6227-29 PC 580O-ring Seal.....1
39511276*Anvil and Piston Lining.....1	119520448*Inlet Plug.....1
4954659Bleeder Screw.....1	12MS28778-4 PC 590Gasket.....2
5511846-4*Bleeder Washer.....1	139540021*Brake Housing.....1
6MS16625-1200* PC 590Retaining Ring.....1	14955383Dot Fastener.....4
7511971M**Cylinder Head.....1	159523482Disc Clip.....4
8MS28775-224 PC 590O-ring Seal.....11	161604-73*Inlet Plug.....1

* No longer available

TIRES, WHEELS AND BRAKES



Brake Assembly Number: 9520517

Brake 6.00-6

Type: lock ring retained cylinder head brake

Used On: Call-Air Cropduster, Cessna 120 and 140, Globe Swift, Aeronca 7, 11 and 15, Bellanca Cruisair, Columbia Skyranger, Luscombe Silvaire 8 and 8A, Sedan, Sedan II

Assembly Part Number9520517*

Fig.	Part No.	Description	Qty. per Assy.
1	9530286	Brake Disc	1
2	5011073	Anvil and Piston Lining	1
3	5011073	Anvil and Piston Lining	1
4	AN515-10R5	PC 580 Screw	1
5	511846-4*	Bleeder Washer	1
6	MS16625-1200*	PC 590 Retaining Ring	1
7	511971-M*	Cylinder Head	1
8	MS28775-224	PC 590 Cylinder Head O-ring Seal	1

Fig.	Part No.	Description	Qty. per Assy.
9	511970M*	Piston	1
10	AN6227-29	PC 580 Piston O-ring Seal	1
11	9520448*	Inlet Plug	1
12	MS28778-4	PC 590 Inlet Washer	2
13	9530088*	Brake Housing	1
14	955383	Dot Fastener	4
15	9523482	Disc Clip	4
16	1604-73*	Inlet Plug	1

* No longer available



Brake Assembly Number: 9520292

Brake 6.00-6

— used with high flanged wheel

Type: lock ring retained cylinder head brake

Used On: Stinson 108 Series with 150/165 Franklin engines (serial numbers 1 thru 130)

Assembly Part Number9520292*

Fig.	Part No.	Description	Qty. per Assy.
1	9530291*	Brake Disc	1
2	9511254	Anvil Lining	1
3	9511256	Piston Lining	1
4	511602-1*	Pressure Plate	1
5	954659	Screw	1
6	511846-4*	Bleeder Washer	1
7	MS16625-1200*	PC 590 Retaining Ring	1
8	9510053*	Cylinder Head	1

Fig.	Part No.	Description	Qty. per Assy.
9	9510009*	Piston	1
10	AN6227-29	PC 580 O-ring Seal	2
11	9520448*	Inlet Plug	1
12	AN6230-4	PC 580 Gasket	2
13	530732M*	Brake Housing	1
14	9520435	Disc Clip	4
15	1604-73*	Inlet Plug	1

* No longer available

TIRES, WHEELS AND BRAKES



Brake Assembly Number: 9521239
Brake 6.00-6
Type: bolted cylinder head brake
Used On: Aeronca 7, 11 and 15, Stinson
(serial number 3995 and up), Schweizer Glider

Assembly Part Number9521239*

Fig.	Part No.	Description	Qty. per Assy.
19531714*Brake Disc1
29511271-2Anvil Lining1
39511269-2Piston Lining.....1
4AN505-8R5	PC 580Screw.....2
59510957*Bleeder Screw Seal2
6955163*Screw.....6
7MS35336-21*Lock Washer6
89510731*Cylinder Head.....1
9AN6230-3	PC 580O-ring Seal.....1

Fig.	Part No.	Description	Qty. per Assy.
109510155Piston1
11MS28775-224	PC 590O-ring Seal1
129520448*Inlet Plug1
13AN6227-4	PC 580Inlet Gasket2
149530409*Brake Housing.....1
15955383Dot Fastener4
169523482Disc Clip.....4
171604-73*Inlet Plug1

* No longer available



Brake Assembly Number: 9530131
Brake 6.00-6
Type: mechanical brake
Used On: Luscombe Silvaire Model 8 and 8A, Sedan and Sedan II

Assembly Part Number9530131*

Fig.	Part No.	Description	Qty. per Assy.
19530292*Brake Disc1
29511257-2*Anvil Lining1
39511258-2*Piston Lining.....1
4951055Pressure Plate.....1
5MS21045-6*	PC 590Self Locking Nut2
69520221*Hex Head Bolt2
7COML3954771**Washer.....2
8511252A*Housing Plate1
9AN380-2-2	PC 580Cotter Pin (1/16 x 1/2).....1
10NAS1149F0432P	PC 595Washer.....2
11AN394-35	PC 580Flat Head Pin1

Fig.	Part No.	Description	Qty. per Assy.
129510151*Break Release Spring1
139510194*Lever1
159510195*Right Hand Brake Lever.....1
159510196*Left Hand Brake Lever1
16510822*Brake Push Rod.....1
17510975*Adjusting Nut1
18510976*Washer1
19510681*Hex Lock Bushing Nut1
20510706*Push Rod Bushing.....1
21511251A*Brake Housing.....1
229520435Disc Clip1

* No longer available

** 3/8-inch inside diameter, 13/16-inch outside diameter, 0.062-inch thickness.

TIRES, WHEELS AND BRAKES



Brake Assembly Number: 9530839

Brake 6.00-6

Type: bolted cylinder head brake

Used On: Cessna 170, 170B, 172, 180, 182, 175, Skylane, Omega BS12A

Assembly Part Number9530839*

Fig.	Part No.	Description	Qty. per Assy.
1	9530287	Brake Disc	1
1	9531714*	Brake Disc	1
2	9511271-2	Anvil Lining	1
3	9511269-2	Piston Lining	1
4	AN505-8R5	PC 580 Screw	2
5	9510957*	Bleeder Screw Seal	2
6	955163*	Flat Head Socket Screw	6
7	MS35336-21*	PC 590 Lock Washer	6
8	9510731*	Cylinder Head	1
9	AN6230-3	PC 580 O-ring Seal	1

Fig.	Part No.	Description	Qty. per Assy.
10	9510155	Piston	1
11	MS28775-224	PC 590 O-ring Seal	1
12	9520448*	Inlet Plug	1
13	MS28778-4	PC 590 Gasket	2
14	9530841*	Brake Housing	1
15	9521184*	Bushing	1
16	955383	Dot Fastener	4
17	9523482	Disc Clip	4
18	1604-73*	Inlet Plug	1

* No longer available



Brake Assembly Number: 9532741

Brake 6.00-6

Type: lock ring retained cylinder head brake

Used On: Luscombe Silvaire 8 and 8A, Sedan and Sedan II

Assembly Part Number9532741*

Fig.	Part No.	Description	Qty. per Assy.
1	9532751*	Brake Disc	1
2	9525232*	Anvil Lining	1
3	9511269-2	Piston Lining	1
4	511602-1*	Pressure Plate	1
5	AN502-10-6*	PC 580 Bleeder Screw	1
6	511846-4*	Bleeder Washer	1
7	MS16625-1212*	PC 590 Retaining Ring	1
8	9524343*	Cylinder Head	1
9	9524223*	Piston	1

Fig.	Part No.	Description	Qty. per Assy.
10	MS28875-224	PC 590 O-ring Seal	1
10	AN6230-3	PC 580 O-ring Seal	1
11	9520448*	Inlet Plug	1
12	MS28778-4	PC 590 Gasket	3
13	9532752*	Brake Housing	1
14	9525269*	Disc Clip	4
15	955383	Dot Fastener	4
16	1604-73*	Inlet Plug	2

* No longer available

All items on this page are Price Code 660 unless otherwise noted

Price and availability subject to change without notice. Univair's Toll Free Sales: 1-888-433-5433

TIRES, WHEELS AND BRAKES



Wheel Assembly Number: 511413S

Main Wheel 6.00-6

Type: tube type (high flange)

Used On: Aeronca Champion and Chief with 6.00-6 tire (all 1946 models); Bellanca Cruisair with 7.00-6 tire (SN 1 thru 50); Cessna 120 and 140 with 6.00-6 tire (SN 1 thru 1200); Columbia Sky Ranger with 6.00-6 tire; Funk B4, R4 with 6.00-6 tire; Globe Swift with 6.00-6 tire (SN 1 thru 750); Luscombe 11A with 7.00-6 tire; Luscombe 8 with 6.00-6 tire; Stinson with 6.00-6 tire (SN 1 thru 130); Stinson 108 Series with 150 Franklin engine; Schweizer Glider with 6.00-6 tire

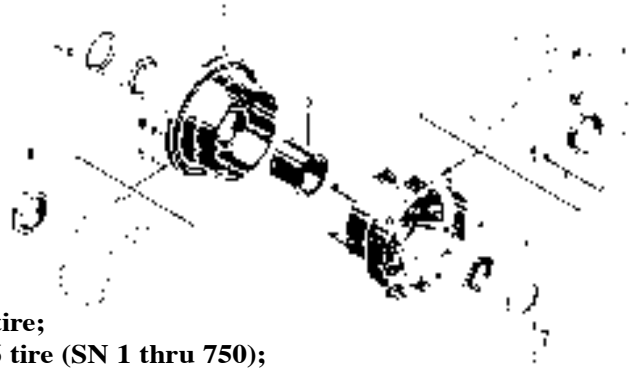

Assembly Part Number511413S*

Fig.	Part No.	Description	Qty. per Assy.
1	COML3952244*	Screw	4
2	3028-06-00-0541*	Locking Tab Type Washer	4
3	951043	Closure-Shaped Bearing Ring	2
4	13889	PC 570 Bearing Cone	2
5	AN365-428	PC 580 Self-Locking Nut	3
6	AN960-416	PC 580 Washer	3
7	511430S*	Outboard Wheel Subassembly	1
8	13830	PC 570 Bearing Cup	1

Fig.	Part No.	Description	Qty. per Assy.
9	9521698*	Spacer	1
10	511475S*	Inboard Wheel Subassembly	1
11	9520202*	Bolt	3
12	C2311-012-27*	Tinnerman Clip	3
13	9520657*	Disc Drive Key Screw	8
14	9520101	Disc Drive Key	8
15	13830	PC 570 Bearing Cup	1

* No longer available



Wheel Assembly Number: 511960S

Main Wheel 6.00-6

Type: tube type (low flange)

Used On: Aeronca 15 with 7.00-6 tire; Call-Air Cropduster with 8.50-6 tire; Cessna 120 and 140 (SN 1201 and up); Cessna 170, 172, 175, Skylane, 180 and 182 with 6.00-6 tire; Forney Aircoupe with 6.00-6 tire; Globe-Swift with 6.00-6 tire (SN 751 and up); Stinson with 6.00-6 tire (SN 131 and up); Vertol Rescuer with 6.00-6 tire

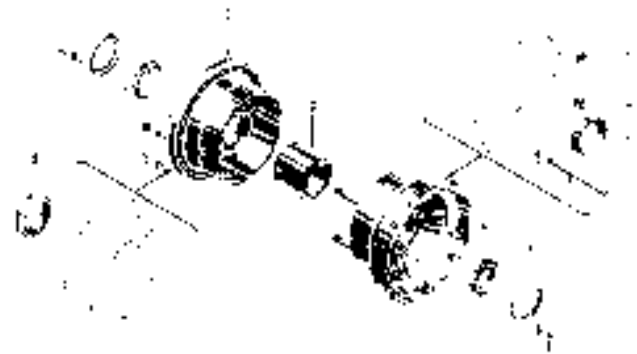

Assembly Part Number511960S*

Fig.	Part No.	Description	Qty. per Assy.
1	COML3952244*	Screw	4
1A	AN504-6R4*	PC 580 Round Head Screw	4
2	3028-06-00-0541*	Lock Tab Type Washer	4
3	951043	Closure-Shaped Bearing Ring	2
4	13889	PC 570 Bearing Cone	2
5	MS21045-4	PC 590 Self-Locking Nut	3
5A	MS21045-4	PC 590 Self-Locking Nut	3
6	NAS1149F0432P	PC 595 Washer	3
7	511430S*	Outboard Wheel Subassembly	1

Fig.	Part No.	Description	Qty. per Assy.
8	13830	PC 570 Bearing Cup	1
9	9521698*	Spacer	1
10	511961S*	Inboard Wheel Subassembly	1
11	AN4-47A	PC 580 Bolt	3
12	C2311-012-27*	Tinnerman Clip	3
13	9520657*	Disc Drive Key Screw	8
14	9520101	Disc Drive Key	8
15	13830	PC 570 Bearing Cup	1

* No longer available.

TIRES, WHEELS AND BRAKES

Goodyear Hub Caps

for all 6.00 x 6 Goodyear wheels

Part Number... **PC 680**... 952353



Maule Fabric Tester

Used for punch testing aircraft fabric covering & Piper Struts.

Part Number**PC 695**.... TW-01



Hub Cap Tool

Install your Maule TW-18 hub caps with this handy hub cap tool.

Part Number**PC 695**.... TW-02

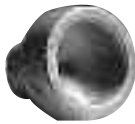

Brake Riveting Tool

A must for riveting brake linings and pads.

Part Number**PC 660**... RA-825



MAULE TAILWHEEL SPRINGS



- 1. Part Number.....TW4004
- 2. Part Number.....TW4005
- 3. Part Number.....TW4006

PC 695

MAULE TAILWHEELS

For tough landings, you can't beat Maule for extra protection.

Check these construction features:

- STEERABLE FULL SWIVELING • STEERABLE BEYOND FULL RUDDER RANGE
- NEW IMPROVED SINGLE ARM
- ALUMINUM HUB AND HUB CAP • 2.80 x 2.50-4 TIRE AND TUBE ON PNEUMATIC
- ALL WORKING PARTS HIGHLY HEAT-TREATED

Maule 8-inch Pneumatic Tailwheel

Maule's Model P8 tailwheel unit, equipped with an 8-inch pneumatic tire, provides a simple, inexpensive tail-



Bracket Size

1-1/4 inch.....TW-SFS-P8A-1-4
1-1/2 inch.....TW-SFS-P8A-1-2

Part Number

Maule Solid Rubber Tailwheel

Maule's Model SFS tailwheel units are constructed of the same materials as SFS-P8 units, except for the tire, which is a Maule 6.50 x 2.50 Hard Rubber Tire.



Bracket Size

1-1/4 inchTW-SFSA-1-4
1-1/2 inchTW-SFSA-1-2

Part Number

PC 695

All items on this page are Price Code 695 unless otherwise noted

Price and availability subject to change without notice. Univair's Toll Free Sales: 1-888-433-5433

TIRES, WHEELS AND BRAKES

MAULE Tailwheel Parts List

Models SFS, SFSA, SFS-P8 & SFS-P8A

Note: Maule redesigned their solid rubber and pneumatic tailwheels in 1976. The old style pneumatic tailwheel was designed with a shimmy dampener. The shimmy dampener has been replaced on the new style with the TW-101 Connector Spring Kit. At the owner's discretion, the TW-101 kit may be used on the older style tailwheels.

The older style tailwheels—both solid rubber and pneumatic—were designed with a 3/4-inch fork shaft. The new style has a 7/8-inch fork shaft. In the parts list below, the tailwheel with the 3/4-inch shaft is referred to as "old style" and the 7/8-inch shaft as "new style."

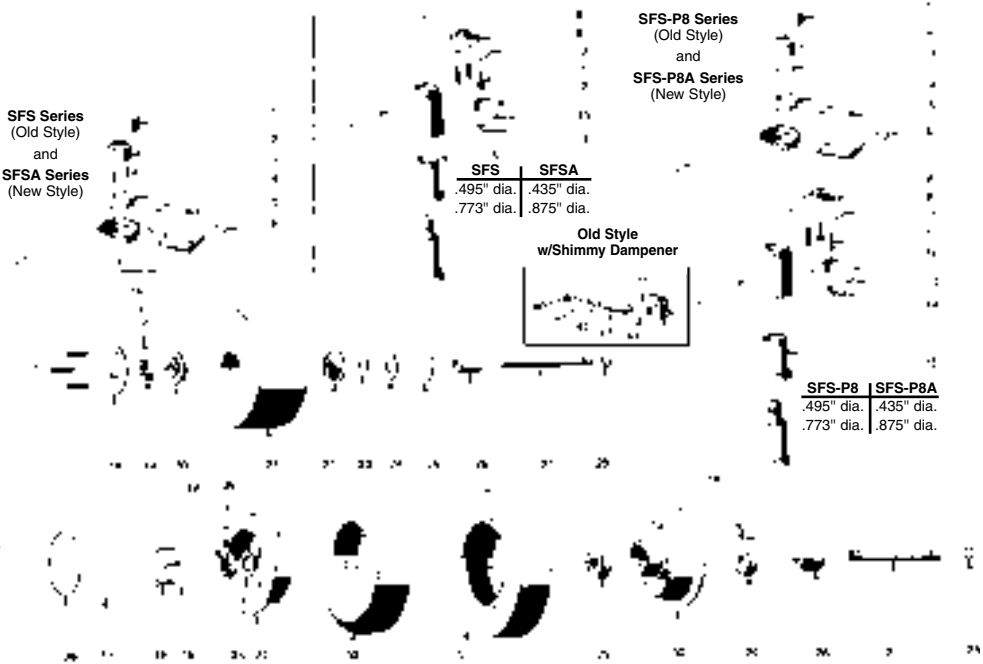

Fig. No.	Description	Old Style	New Style	Qty.
		SFS-P8 Pneumatic or SFS Solid Rubber	SFS-P8A Pneumatic and SFSA Solid Rubber	
Req'd.		Part Number	Part Number	
1	Cover Cap	TW-18 (1-1/4 inch)	TW-63A (1-3/8 inch)	1
2	Nut	AN364-720 or AN365-720	AN364-720 or AN365-720	1
3	Lock Ring Pin	TW-17	TW-60AB	1 /
4	Lock Ring	TW-16	TW-57A	1
5	Nut	AN364-440	AN364-440	3
6	Steering Arm Assembly*	TW-15	TW-15A	1
* Part number TW-15 or TW-15A includes: TW-A2, TW-A4, TW-12, TW-13 or TW-13AB, TW-14 and upper plate, TW-12.				
7	Bracket Assembly, 1-1/4-inch	TW-22-1-4	TW-22A-1-4	1
8	Bracket Assembly, 1-1/2-inch	TW-22-1-2	TW-22A-1-2	1
9	Lock Pin	TW-13AB	TW-13AB	1
10	Steering Arm Spring	TW-14	TW-14	1
11	Lock Cover Plate	TW-12	TW-12	1
12	Screw	AN515-4-8	AN515-4-8	3
13	Cam	TW-10	TW-10	1
14	Screw	AN501-10-4 or AN520-10-4	AN501-10-4 or AN520-10-4	2
15	Zerk Fitting PC 599	1641B	1641B	1
16	Oilite Bearing	TW-7 (3/4-inch I.D.)	TW-59A (7/8-inch I.D.)	1
Items 16 through 25 are for the solid rubber tire assembly only.				
17	Cotter Pin	AN380-3-3	AN380-3-3	1
18	Screw	TW-A18	TW-A18	3
19	Hub Cap	TW-27	TW-27	1
20	Axle Nut	AN320-8	AN320-8	1
21	Bearing	TW-A16	TW-A16	1
22	Tire—solid, no bearings	TW-23	TW-23	1
23	Tire—solid, with bearings	TW-23A	TW-23A	1
24	Bearing (with washer)	TW-A15	TW-A15	1
25	Washer	TW-28	TW-28	1
26	Felt Seal	TW-26	TW-26	1
27	Retainer Washer	TW-64	TW-64	1
28	Fork (without axle)	TW-39	TW-58A	1
29	Pneumatic Solid Rubber	TW-21	TW-61A	1
30	Fork (with axle)	TW-39-1	TW-58A-1	1
31	Pneumatic Solid Rubber	TW-21-1	TW-61A-1	1
32	Axle	TW-5	TW-5	1
33	Axle Sirclip Ring	TW-6	TW-6	1
34	Bearing	TW-A7	TW-A7	2

All AN part numbers are PC 580

Fig. No.	Description	Old Style	New Style	Qty.
		SFS-P8 Pneumatic or SFS Solid Rubber	SFS-P8A Pneumatic and SFSA Solid Rubber	
Req'd.		Part Number	Part Number	
30	Inboard Wheelhalf, w/bearings	TW-30	TW-30	1
31	Tire, 8-inch PC 655	280250X4TAT	280250X4TAT	1
32	Tube PC 655	280X4U	280X4U	1
33	Outboard Wheelhalf	TW-31	TW-31	1
34	Washer	TW-A6	TW-A6	1
35	Lock Washer	AN935-516	AN935-516	3
36	Bolt	TW-A12	TW-A12	3
37	Hub Cap	TW-32	TW-32	1
38	Hub Cap Sirclip Ring	TW-33	TW-33	1
39	Cotter Pin	AN380-3-3	AN380-3-3	1
Items 40 through 44 are used on the "Old Style" and pneumatic tailwheels that have a shimmy dampener.				
40	Adjusting Screw	TW-40		1
41	Dampener Spring	TW-41		1
42	Friction Block	TW-42		1
43	Hex Housing	TW-43		1
44	Bracket Assembly, 1-1/4-in. drilled	TW-44-1-4		1
	Bracket Assembly, 1-1/2-in. drilled	TW-44-1-2		1

Maule Tailwheel Connector Springs

Maule's latest Tailwheel Connector Spring Kit stops shimmying. A high and low frequency spring is used to upset the frequency of the tailwheel. The lighter spring is used on the left side.

Compression type complete with Clips and Chains
(includes points 48, 49, 54, 55 and 56).....TW-101

TIRES, WHEELS AND BRAKES

MAULE P8B Tundra Tailwheel

Maule Aircraft's new tailwheels are designed and engineered to meet the toughest conditions on all types of airports and landing fields. There are three Maule tailwheels available:

- TW-SFS-P8B-1-4** — fits 1-1/4-inch leaf spring
- TW-SFS-P8B-1-2** — fits 1-1/2-inch leaf spring
- TW-SFS-P8B-3-4** — fits 1-3/4-inch leaf spring

These Maule P8B features will serve you well:

- steerable full swiveling
- steerable full rudder range
- new, improved single-arm shimmy-free fork with friction washer in bottom
- extra heavy duty
- all bearings in wheel and caster are Timkin tapered roller bearings
- aluminum hub and caster
- 2.80 X 2.50 X 4 tire and tube
- all working parts are highly heat treated

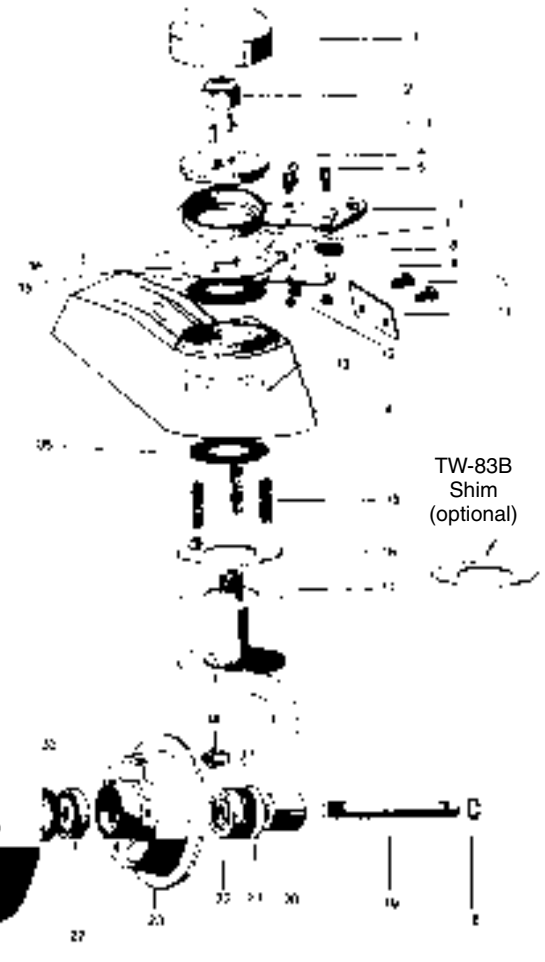

Fig. No.	Description	Part No.	Qty. Req'd.	Fig. No.	Description	Part No.	Qty. Req'd.
1	Cover Cap (2-1/4-inch diameter)	TW-74B	1	19	Axle	TW-5	1
2	Nut	PC 590 MS20365-720A	1	20	P8B Fork with Axle	TW-69B	1
3	Lock Ring Pin	TW-60AB	2	21	Washer	TW-A6	1
4	Lock Ring	TW-73B	1	22	Bearings	TW-A7 or TW-A161	1
5	Screw	PC 580 AN515-4R8	3	23	Inside Hub with Bearings	TW-30	1
6	Steering Arm Assembly	TW-66B	1	24	8-inch 2.80 x 2.50-4 Tire	PC 655 280250X4TAT	1
7	Lock Pin	TW-13AB	1	25	8-inch 2.80 x 2.50-4 Tube	PC 655 280X4U	1
8	Spring	TW-14	1	26	Outside Hub	TW-31	1
9	Plate	TW-12	1	27	Nut	PC 580 AN320-8	1
10	Cam Screw	PC 580 AN520-10-4	2	28	Lock Washer	PC 590 MS35338-45	3
11	Cam Plate	TW-75B	1	29	Hub Bolt	TW-A12	3
12	Nut	PC 590 MS21044N04	3	30	Hub Cap	TW-32	1
13	Roller Bearing	TW-A5	1	31	Sirclip Ring	TW-33	1
14	Bracket Assembly (1-1/4, 1-1/2, 1-3/4; includes numbers 10, 11 and 13)	TW-71B-1-4, -1-2, -3-4	1	32	Cotter Pin	PC 590 MS24665-283	5
15	Spring	TW-76B	3	33	Felt Seal—Wheel Bearing	TW-78B-1	2
16	Friction Ring Assembly	TW-72B-3	1	34	Zerk	PC 599 1641B	1
17	Friction Washer	TW-72B-4	1	35	Felt Seal—Bracket Bearing	TW-78B-2	1
18	Sirclip Ring	TW-6	1	36	Shield	TW-77B	1

All AN part numbers are PC 580

All items on this page are Price Code 695 unless otherwise noted

Price and availability subject to change without notice. Univair's Toll Free Sales: 1-888-433-5433

TIRES, WHEELS AND BRAKES

FAA/PMA

2000 Tailwheel Component Parts

Scott 2000 Tailwheel Assemblies (Not Available) - Most Replacement Parts are available

Accessory: Spring Connector Kit, Part Number..... U2151A-000

Item No.	Part No.	Description	Number Required	
			2000-00	2000-01
1	AN364-720	Self-Locking Nut	1	1
2	U2346A	Washer	1	1
3	U2085A	Shim	as required	as required
4	U1709A-000	Arm Assembly	1	
5	2077	Bracket Assembly*	1	1
		(includes items no. 6 and 7)		
6	1781	Bushing Cap	1	1
7	U1800A	Bushing	1	1
8	2078	Fork	1	1
9	U1863-000	Grease Retainer FAA/PMA	1	1
10	U1862A	Grease Retainer Spacer	1	1
11	1883	Bearing Set	2	2
12	1967	Hub Kit	1	1
		(includes items no. 20 and 21)		
13	1879	Tire	1	1
14	NAS1149F0832P	Washer PC 595	1	1
15	AN320-8	Nut	1	1
16	MS24665-283	Cotter Pin PC 590	1	1
17				
18	1882	Hub Cap Assembly	1	1
19				
20	AN501-10-24	Screw	3	3
21	AN365-1032	Nut	3	3
22	U1478A-000	Spacer Assembly	1	1
23	U1306A	Bushing	1	1

2000 Series



* Standard bracket is for 1-1/2-inch leafspring. If required for use with 1-1/4-inch leafspring, use part number 1478 spacer and Part Number1306 adapter.

All AN Part Numbers are PC 580

3200 Series Tailwheel

The 3200 Series is a lightweight 8-inch tailwheel assembly designed to provide positive steering control far beyond rudder travel, and to release easily and automatically to full swivel when aircraft is turned around. The swivel mechanism is sealed to keep out water, sand and mud. Grease fittings are provided for lubrication. Precision components provide years of trouble-free service under severe operating conditions.

Accessory: Spring Connector Kit, Part NumberU3239A-101 For Piper
.....U3239A-103 for Cessna

Item No.	Part No.	Description	Number Required			
			3200	3200-1	3200-3	3200-5
1	3216	Bracket Assembly*	1	1		1
2	800613	Bracket Assembly			1	
3	U3207	Thrust Washer (FAA/PMA)	1	1	1	1
4	U3234	Thrust Plate Assembly (FAA/PMA)	1	1	1	1
5	U3233	Compression Spring (FAA/PMA)	5	5	5	5
6	U3235A-002	Upper Dust Cap (FAA/PMA)	1	1	1	1
7	U3206	Thrust Washer (FAA/PMA)	2	2	2	2
8	U3214A-000	Arm Assembly (FAA/PMA)	1	1	1	1
9	U3219A	Pawl (FAA/PMA)	1	1	1	1
10	U3235A-001	Lower Dust Cap (FAA/PMA)	1	1	1	1
11	3224	Fork Assembly	1	1	1	1
12	A4050	Cone Bearing	1	1	1	1
13	U1863A-000	Grease Retainer (FAA/PMA)	1	1	1	1
14	U2504A-001	Spacer (FAA/PMA)	1	1	1	1
15	NAS1149F0863P	Washer PC 595	2	2	2	1
16	AN320-8	Shear Nut	1	1	1	1
17	MS24665-283	Cotter Pin PC 590	2	2	2	1
18	U3222	Spring (FAA/PMA)	1	1	1	1
19	U3258	Spacer (FAA/PMA)	1	1	1	1
20	U3258-1	Spacer (FAA/PMA)	1	1	1	1
21	U3257	Pin (FAA/PMA)	1	1	1	1
22	U3236A-000	Axle Assembly (FAA/PMA)	1	1	1	
23	U3225A-000	Lock Washer (FAA/PMA)	1	1	1	
24	AN310-8	Castle Nut	1	1		
25	3244	Wheel Assembly	1			
26	2600	Tire and Wheel Assy.	1		1	
27	3226	Pin	1	1	1	1
28	U2602	Gasket (FAA/PMA)	1	1	1	
29	3205	Bushing	1	1	1	1

3200 Series

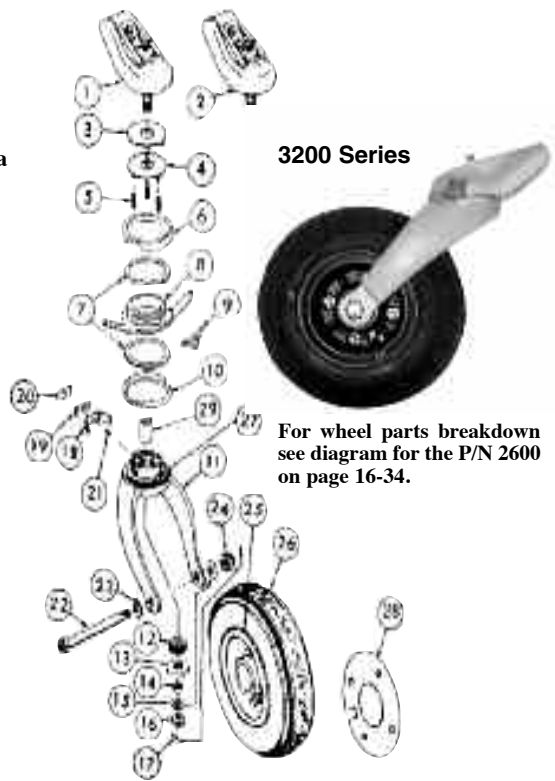

For wheel parts breakdown see diagram for the P/N 2600 on page 16-34.

* Standard bracket is for 1-3/4-inch leafspring.
— If required for use with 1-1/2-inch leafspring, use part number 3241-1S installation kit.
— If required for use with 1-1/4-inch leafspring, use part number 3243-1 installation kit.

Complete 3200 Assembly.....3200
3200 Assy. without Tire, Tube or wheel.....3200-1
2-hole Bracket for PA-253200-3
3200 Less Axle, Wheel, Tire & Tube3200-5

All AN Part Numbers are PC 580

TIRES, WHEELS AND BRAKES

3250 Series Tailwheel (The Complete Tailwheel is not Available)

Item Number	Part Number	Description	No. Required
1	3250-1	Drag Link Assembly*	1
2	U3207	Thrust Washer FAA/PMA	1
3	U3234	Thrust Plate Assembly FAA/PMA	1
4	U3233	Compression Spring FAA/PMA	5
5	3256-2	Upper Dust Cap	1
6	U3206	Thrust Washer FAA/PMA	2
7	U3214T-000	Arm Assembly FAA/PMA	1
8	3219-1	Pawl	1
9	3256-1	Lower Dust Cap	1
10	3224	Fork Assembly	1
11	A4050	Cone Bearing (13286)	1
12	U1863A-000	Grease Retainer FAA/PMA	1
13	U2504A-001	Spacer FAA/PMA	1
14	NAS1149F0863P	Washer PC 595	2
15	AN320-8	Shear Nut	1
16	AN380-3-3	Cotter Pin	2
17	U3222	Spring FAA/PMA	1
18	U3258	Spacer FAA/PMA	1
19	U3258-1	Spacer FAA/PMA	1
20	U3257	Pin FAA/PMA	1
21	U3236A-000	Axle Assembly FAA/PMA	1
22	U3225A-000	Lock Washer FAA/PMA	1
23	AN310-8	Castle Nut	1
24	2600	Tire and Wheel Assembly PMA'd	1
25	3226	Pin	1
26	U2602	Gasket FAA/PMA	1

* No longer available.

All AN part numbers are PC 580

The 3250 8-inch tailwheel assembly provides positive steering control far beyond rudder travel and will release easily and automatically to full swivel when the aircraft is turned around. Tension is not required on the rudder spring cable connectors except to remove slack. This reduces the load on the rudder during flight.

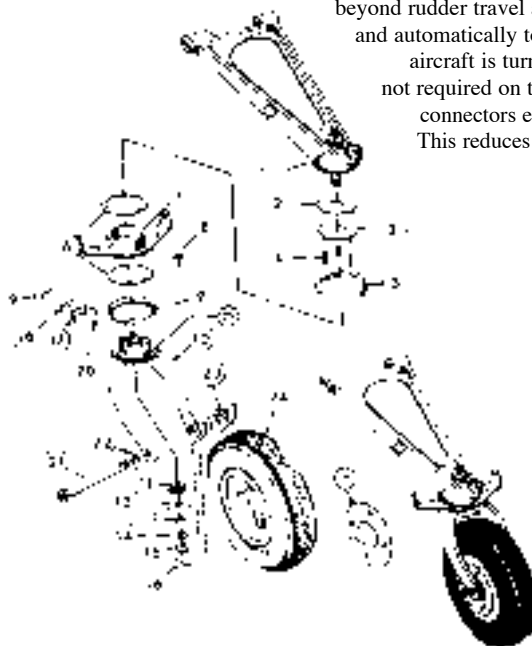

3400 Series Tailwheel

Item No.	Part No.	Description	Number Required	
			3400	3400-1
1	3412	Bracket Assembly	1	1
2	U3233	Compression Spring FAA/PMA	as required	as required
3	08118	Bearing (13289)	1	1
4	3407	Spacer	as required	as required
5	3411-1	Upper Dust Cap	1	1
6	3408	Washer	1	1
7	3408-1	Washer	as required	as required
8	U3219	Pawl FAA/PMA	1	1
9	3410-3	Arm Assembly	1	1
10	3408-2	Washer	as required	as required
11	3411-2	Lower Dust Cap	1	1
12	3413	Fork Assembly	1	1
13	MS24665-283	Cotter Pin PC 590	2	2
14	AN320-8	Shear Nut	1	1
15	NAS1149F0863P	Washer PC 595	as required	as required
16	U2504A-001	Spacer FAA/PMA	1	1
17	U1863A-000	Grease Retainer FAA/PMA	1	1
18	A4050	Cone Bearing (13286)	1	1
19	U3257	Pin FAA/PMA	1	1
20	U3258-1	Spacer FAA/PMA	1	1
21	U3258	Spacer FAA/PMA	1	1
22	U3222	Spring FAA/PMA	1	1
23	AN310-8	Castle Nut	1	1
24	NAS1149F0863P	Washer PC 595	as required	as required
25	3236C2	Axle Assembly	1	1
26	U3225A-000	Lock Washer FAA/PMA	1	1
27	2832-5	Washer	1	2
28	2600	Tire and Wheel Assembly	1	1
29	3226	Pin	1	1
30	U2602	Gasket FAA/PMA	1	1

All AN part numbers are PC 580

All items on this page are Price Code 690 unless otherwise noted

Price and availability subject to change without notice. Univair's Toll Free Sales: 1-888-433-5433

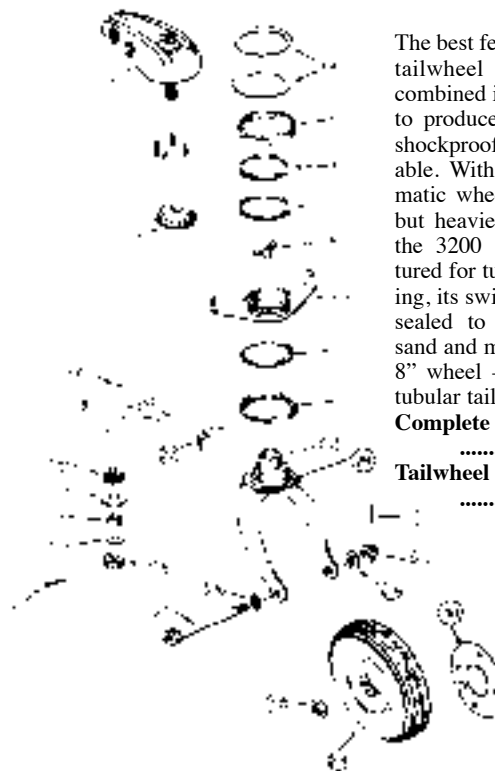

The best features of all Scott tailwheel assemblies are combined in the 3400 Series to produce the finest, most shockproof tailwheel available. With its 8-inch pneumatic wheel, it is a similar but heavier-duty version of the 3200 Series. Manufactured for tube spring mounting, its swivel mechanism is sealed to keep out water, sand and mud.

8" wheel - mounts on 7/8" tubular tailspring.

Complete Tailwheel
3400-1
Tailwheel - less wheel.....
3400

TIRES, WHEELS AND BRAKES

3425 Series Tailwheel

3425 Series Tailwheel

This steerable, full swivel assembly, equipped with your choice of an 8-inch or 10-inch wheel, provides that extra measure of rugged dependability that has distinguished Scott tailwheels for more than a quarter of a century. Built-in extra strength assures exceptional performance on utility aircraft intended for hard usage and rough terrain. This tailwheel is manufactured for tube spring mounting. The 3425 Series come in versions for mounting on either the 15/16" or 1" tubular tailspring. The steering arms on this series of tailwheel are available in straight or bent upwards versions.

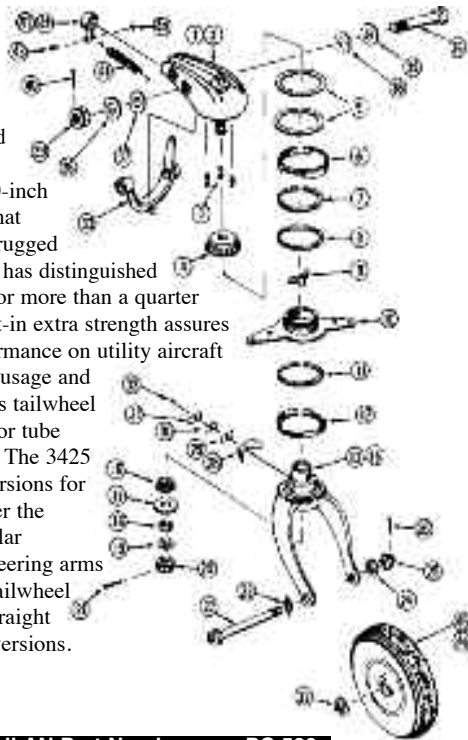

All AN Part Numbers are PC 580

Fig. No.	Part No.	Description	Number Required						
			-1*	-3*	-5*	-7*	-13	-15	-17*
1	3412-1	Bracket Assembly	1	1	1	1			
2	3412-2	Bracket Assembly					1	1	1
3	U3233	Compression Spring FAA/PMA	A/R	A/R	A/R	A/R	3	3	3
4	08118 PC 570	Cone Bearing (13289)	1	1	1	1	1	1	1
5	3407	Spacer	A/R	A/R	A/R	A/R	A/R	A/R	A/R
6	3411-7	Upper Dust Cap	1	1	1	1	1	1	1
7	3408	Washer	1	1	1	1	1	1	1
8	3408-2	Washer	A/R	A/R	A/R	A/R	A/R	A/R	A/R
9	U3219	Pawl FAA/PMA	1	1	1	1	1	1	1
10	3410-5	Arm Assembly	1	1	1	1	1	1	1
11	3479-1	Washer	A/R	A/R	A/R	A/R	A/R	A/R	A/R
12	3411-5	Lower Dust Cap	1	1	1	1	1	1	1
13	3423-3	Fork Assembly, 10-inch	1						
15	3413-1	Fork Assembly, 8-inch	1	1	1	1	1	1	1
16	A4050	Cone Bearing (13286)	1	1	1	1	1	1	1
17	U1863A-000	Grease Retainer FAA/PMA	1	1	1	1	1	1	1
18	U2504A-001	Spacer FAA/PMA	1	1	1	1	1	1	1
19	NAS1149F0863P	Washer PC 595	1	1	1	1	1	1	1
20	AN320-8	Aircraft Shear Nut	1	1	1	1	1	1	1
21	MS24665-283	Cotter Pin PC 590	1	1	1	1	1	1	1
22	3236C2	Axle Assembly PC 590	1	1	1	1	1	1	1
23	U3225A-000	Lock Washer FAA/PMA	1	1	1	1	1	1	1
24	AN960-816L	Washer	1	1	1	1	1	1	1
25	18433	Castle Nut	1	1	1	1	1	1	1
26	MS24665-283	Cotter Pin PC 590	1	1	1	1	1	1	1
27	2832-5	Washer		2	2		2	2	
28	3432	Spring	1	1	1	1	1	1	1
29	3433	Spacer	A/R	A/R	A/R	A/R	A/R	A/R	A/R
30	U3258	Spacer FAA/PMA	A/R	A/R	A/R	A/R	A/R	A/R	A/R
31	U3258-1	Spacer FAA/PMA	A/R	A/R	A/R	A/R	A/R	A/R	A/R
32	U3257	Pin FAA/PMA	1	1	1	1	1	1	1
33	3426	Bell Crank	1	1	1	1	1	1	1
34	56365	Bolt	1	1	1	1	1	1	1
35	18299	Washer	1	1	1	1	1	1	1
36	3476	Bushing	1	1	1	1	1	1	1
37	3476	Bushing	1	1	1	1	1	1	1
38	18300	Washer	1	1	1	1	1	1	1
39	56366	Nut	1	1	1	1	1	1	1
40	56367	Cotter Pin	1	1	1	1	1	1	1
41	3477	Spring	1	1	1	1	1	1	1
42	3478	Clamp	1	1	1	1	1	1	1
43	18477	Nut	1	1	1	1	1	1	1
44	18556	Screw	1	1	1	1	1	1	1
45	2600	8-inch Tire and Wheel Assembly		1	1		1	1	
46	3245-1	10-inch Tire and Wheel Assembly	1						1
47	3478-1	Clamp						1	1

* -1, -3, -5, -7, and -17 assemblies are manufactured for tube spring mounting.

3450 Series Tailwheel

3450 Series Tailwheel

Similar in design to the 3400 and 3425 Series tailwheels, the 3450 Series features a 10-inch pneumatic wheel and the same heavy-duty, shockproof construction as the 3425 Series. As such, it will withstand the most severe operating conditions while providing the same reliable, trouble-free performance as the 3400 and 3425 Series tailwheels. They are available in versions for the 15/16" or 1" tubular tailspring. The steering arms on this series of tailwheel are also available in straight or bent upwards versions.

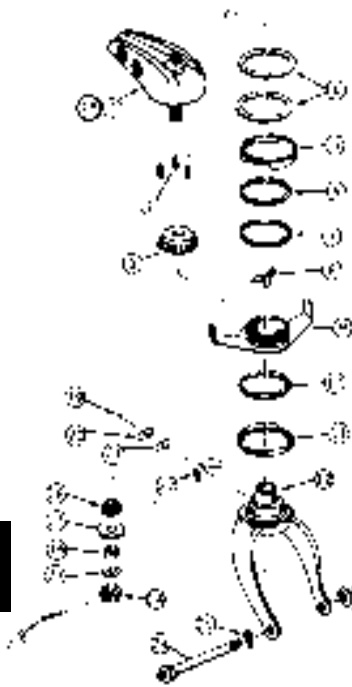

All AN Part Numbers are PC 580

Fig. No.	Part No.	Description	Number Required					
			-1*	-3*	-5*	-7*	-17*	-23*
1	3412-1	Bracket Assembly	1	1	1	1		
1A	3412-2	Bracket Assembly					1	
2	U3233	Compression Spring FAA/PMA	A/R	A/R	A/R	A/R	3	2
3	08118 PC 570	Cone Bearing (13289)	1	1	1	1	1	1
4	3407	Spacer	A/R	A/R	A/R	A/R	A/R	1
5	3411-1	Upper Dust Cap	1	1	1	1	1	1
6	3408	Washer	1	1	1	1	1	1
7	3408-1	Washer	A/R	A/R	A/R	A/R	A/R	A/R
8	U3219	Pawl FAA/PMA	1	1	1	1	1	1
9	3410-3	Arm Assembly	1					
	3410-5	Arm Assembly		1			1	
10	3408-2	Washer	A/R	A/R	A/R	A/R	A/R	A/R
11	3411-2	Lower Dust Cap	1	1	1	1	1	1
12	3423-1	Fork Assembly	1	1	1	1	1	1
13	MS24665-283	Cotter Pin PC 590	2	2	2	2	2	2
14	AN320-8	Nut	1	1	1	1	1	1
15	AN960-816L	Washer	1	1			1	1
16	U2504A-101	Spacer	1	1	1	1	1	1
17	U1863A-000	Grease Retainer FAA/PMA	1	1	1	1	1	1
18	A4050	Cone Bearing (13286)	1	1	1	1	1	1
19	U3257	Pin FAA/PMA	1	1	1	1	1	1
20	3433	Spacer	A/R	A/R	A/R	A/R	A/R	A/R
21	3433-1	Spacer	A/R	A/R	A/R	A/R	A/R	A/R
22	3432	Spring	1	1	1	1	1	1
23	AN310-8	Nut	1	1			1	1
24	3236C2	Axle Assembly	1	1			1	1
25	U3225A-000	Lock Washer FAA/PMA	1	1			1	1
26	3245-1	Tire and Wheel Assembly	1	1			1	1
27	NAS1149F0863P	Washer PC 595	1	1	1	1	1	1

* -1, -3, -5, -7, and -17 assemblies are manufactured for tube spring mounting.
 -23 assembly is manufactured for leafspring mounting and uses the following part numbers:
 801355-02 - Bracket Assembly
 3411-00 - Dust Cap
 3410-07 - Arm Assembly

All items on this page are Price Code 690 unless otherwise noted

Price and availability subject to change without notice. Univair's Toll Free Sales: 1-888-433-5433

TIRES, WHEELS AND BRAKES

2600 Wheel and Tire Assembly

The Model 2600 is used on all Scott tailwheel applications where an 8-inch-diameter tire is required. Available for general use, it is suggested for helicopters, liaison and primary training aircraft, and material handling devices where low weight and high strength are required. Due to the high volume production for 3200 Series tailwheel assemblies, an attractive price is possible. Total weight of this assembly is only 3 lbs., 13 oz., including bearings. It can be supplied complete and assembled or as a hub only, unassembled, with gasket and bolts furnished.

Hub: Cast aluminum. Designed for extra heavy shock load absorption. One of its many uses is on tailwheel assemblies.

Tire: Safety Rib, 4-ply with tube.
Bearing: Timken, for 1/2-inch axle.

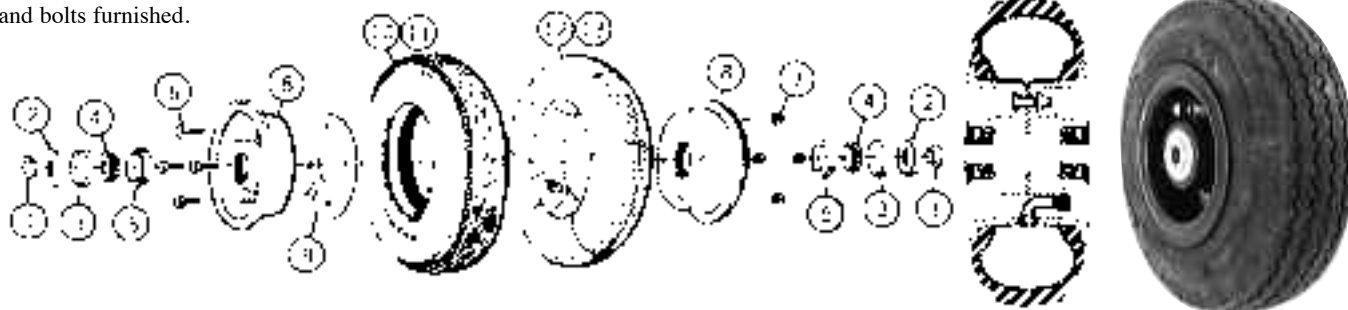

Item No.	Part No.	Description	No. Req'd.	Item No.	Part No.	Description	No. Req'd.
	2600	Wheel and Tire Assembly FAA/PMA		6	AN4-7A	Bolt	PC 580 4
1	3227	Spacer	2	7	AN365-428	Self-locking Nut	PC 580 4
2	U1863A-000	Grease Retainer FAA/PMA	2	8	2598	Hub	2
3	U1862A-000	Spacer FAA/PMA	2	9	U2602	Gasket FAA/PMA	1
4	A4050*	Cone Bearing	2	10	280250X4TAT	Tire, 8-inch	PC 655 1
5	A4138*	Bearing Cup	2	11	280X4U	Tube, 8-inch	PC 655 1

* A4050 and A4138 are sold together in the 1883 kit.

Tires and Hubs for 2000 Series Tailwheels with Solid Rubber Tires

(Hub excludes bearings)

Tire.....**1879**

Hub.....**1967**

Scott 4500 Parking Brake Valve

Part Number.....**4500A1**

Replacement Seals for 4200 and 4500 Series Scott Valves:

O-Ring—3/4-inch O.D., 9/16-inch I.D.
 Part Number **PC 590** MS28775-113

O-Ring—3/8-inch O.D., 1/4-inch I.D.
 Part Number **PC 590** MS28775-010

Brake Reservoir

Aluminum reservoir mounts on the firewall in any position and measures 2-1/4 inches in diameter and 2-1/2 inches high. Parts are 1/8 inch NPT.

Part Number.....**PC 699**.....**A315**

3200 Series Tailwheel Installation Kits

1-1/4-inch Installation Kit**3243-1**
 contains: one 1-1/4-inch Spacer FAA/PMAU3243-2
 one Spacer Bushing3241-2
 two Eye Bolts **PC 580** AN42B-6

1-1/2-inch Installation Kit**3241-1S**
 contains: one 1-1/2-inch Spacer3241-3S
 one Spacer Bushing3241-2
 two Eye Bolts **PC 580** AN42B-6

Spring Connector Link

FAA/PMA Approved

Part Number.....**U2133A-000**

Spring Connector Kit FAA/PMA Approved
 (includes springs, chains and connector clips)

For 2000 Series Tailwheel (Formerly 3-24B Tailwheel)**U2151A-000**
 For 3200 Series TailwheelFor Piper**U3239A-101**
For Cessna.....**U3239A-103**

Replacement O-Rings for Ercoupe Scott Master Cylinders
 Order one each of the following part numbers:
MS28775-218 **MS28775-012** **MS28775-211**

PC 590

All items on this page are Price Code 690 unless otherwise noted

Price and availability subject to change without notice. Univair's Toll Free Sales: 1-888-433-5433

TIRES, WHEELS AND BRAKES

Brake Master Cylinder



The Scott Brake Master Cylinder is one of the largest selling aircraft master cylinders in the world. One left hand (part number 1248H) or one right hand (part number 1260H) cylinder. Installed as standard equipment on Piper and other aircraft for many years, these units provide rugged and virtually trouble-free service with few wearing parts. One pair of master cylinders—one left hand and one right hand—is required on most aircraft. On the Piper Tri-Pacer, however, only one master cylinder, the left hand part number 1248H, is required.

Specifications:
 Displacement: 80 cubic inches
 Maximum Working Pressure: 350 lbs.
 Pedal Pressure: 100 lbs.
 Recommended Hydraulic Fluid:
 MIL-H-5606
 Weight as Shown: 21 ounces dry

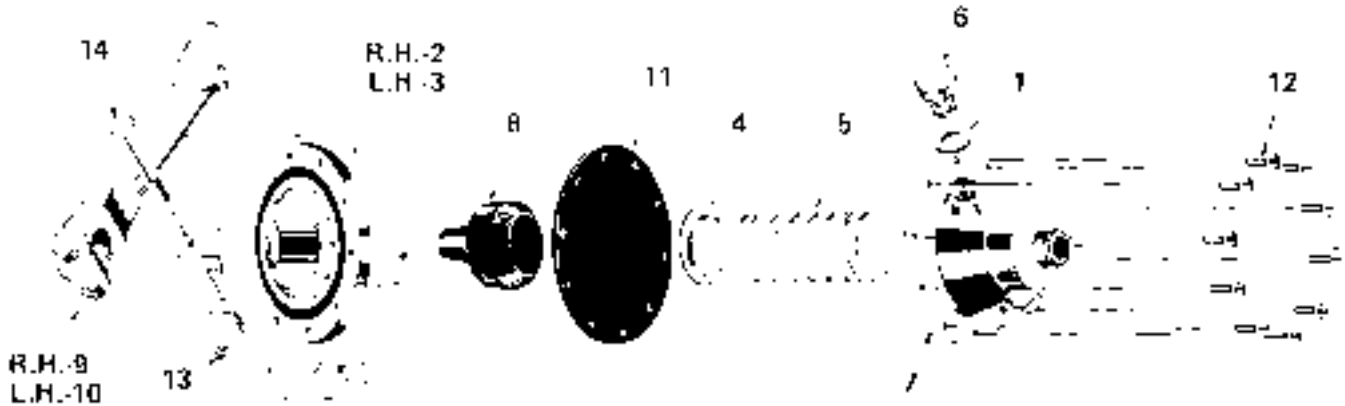

Item No.	Part No.	Description	No. Req'd.	Item No.	Part No.	Description	No. Req'd.
	1248H	Master Cylinder Assembly, LH		7	2728	Compression Cover	1
	1260H	Master Cylinder Assembly, RH		8	1383	Piston	1
1	1159	Vent Screw Gasket	1	9	1712	Pedal, RH Unit	1
2	1220	Bracket, RH Unit	1	10	1714	Pedal, LH Unit	1
3	1232	Bracket, LH Unit	1	11	U750-384 (2844)	Diaphragm FAA/PMA	1 PC 150
4	2003-1	Diaphragm Pad	1	12	MS35265-45	Screw	10 PC 590
5	1256	Spring	1	13	AC356-1032	Nut	1 PC 580
6	UB-1258	Vent Screw FAA/PMA	1	14	AN3-20A	Bolt	1 PC 590

Brake Master Cylinder with Integral Parking Brake

There are four variations of the Scott master cylinder pictured at right, but their internal components are exactly the same. Below are commonly replaced items:

- Piston Stem Seal..... 4014
- Linear U-Cup.....18051
- Linear O-Ring.....**PC 580**.....AN6227-11

Stinson Master Cylinder

- Threads on outside of port..**PC 180**,108-9010075
- Threads on inside of port.....4408E

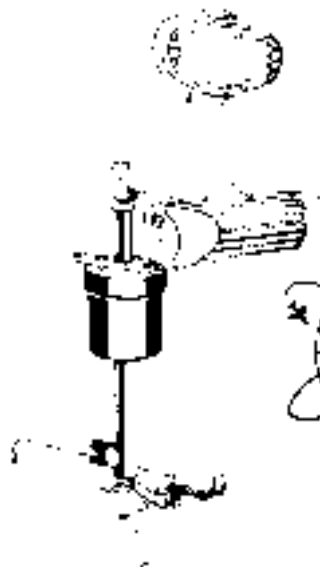

If you don't find the part you need, be sure to give us a call. We are here to help you with all of your Classic Aircraft needs!



All AN Part Numbers are PC 580